

**ROADWAY CENTERLINE CURVE DATA**  
**MORRISVILLE PARKWAY**

CURVE	RADIUS	ARC LENGTH	CHORD LENGTH	CHORD BEARING	DELTA ANGLE
C1	1432.30'	191.69'	191.82'	N 22°23'06" E	27°26'07"
C2	1432.30'	418.13'	417.84'	N 63°22'06" E	18°45'00"
C3	1432.30'	486.18'	482.80'	S 64°22'11" W	18°52'00"
C4	1911.47'	428.89'	424.22'	S 81°42'09" W	15°45'00"

- NOTES:**
- SIGNAL PLAN MODIFICATIONS AT THE INTERSECTION OF MORRISVILLE PARKWAY AND NC HWY. 55 SHALL BE COMPLETED PRIOR TO THE ACCEPTANCE OF THE MORRISVILLE PARKWAY EXTENSION FOR TRAFFIC.
  - TRAFFIC SIGNAL PLANS ARE PROVIDED UNDER SEPARATE PLANS PREPARED BY SEPI ENGINEERING.

**ROADWAY CENTERLINE DATA**  
**MORRISVILLE PARKWAY**

LINE	BEARING	DISTANCE
L1	N 71°42'59" E	2577.41'
L2	N 54°51'10" E	622.24'
L3	N 89°55'22" E	236.72'
L4	N 89°15'54" E	363.19'

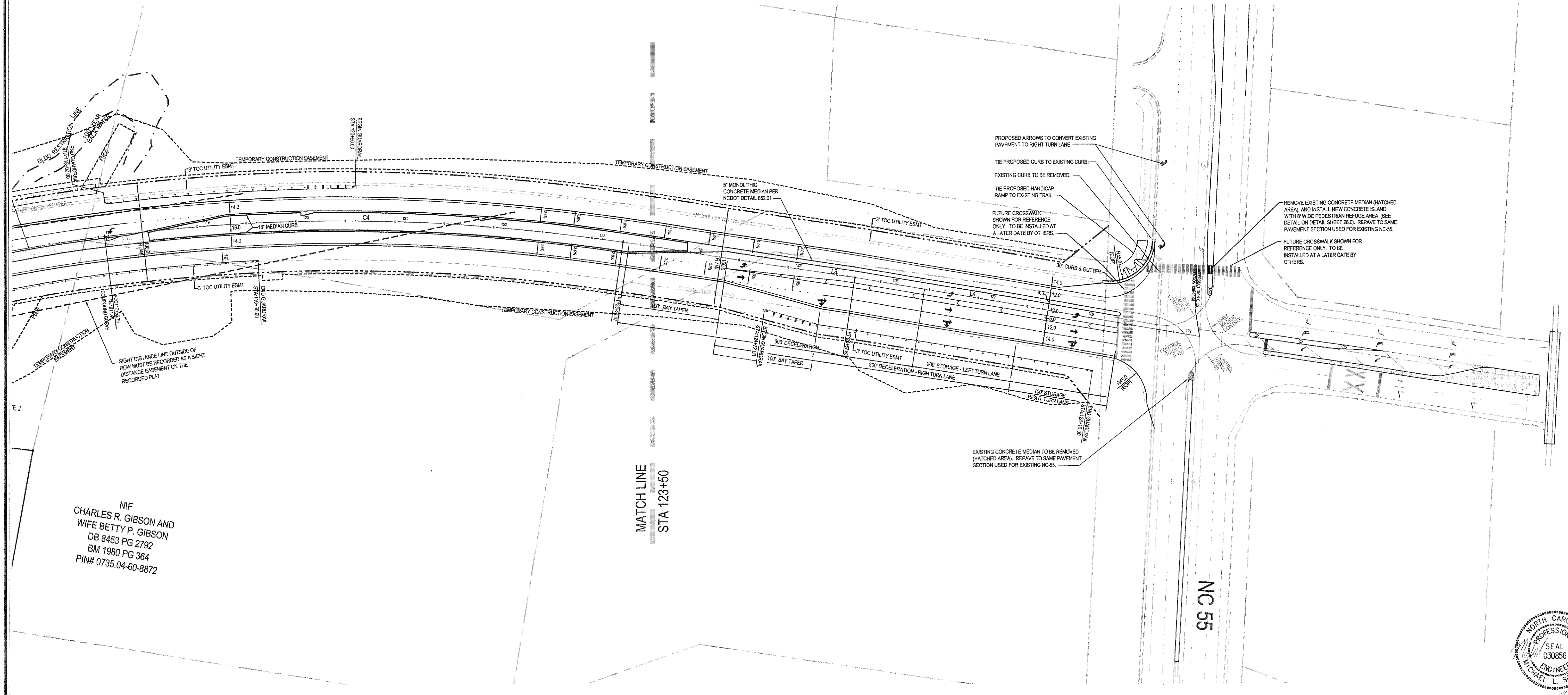
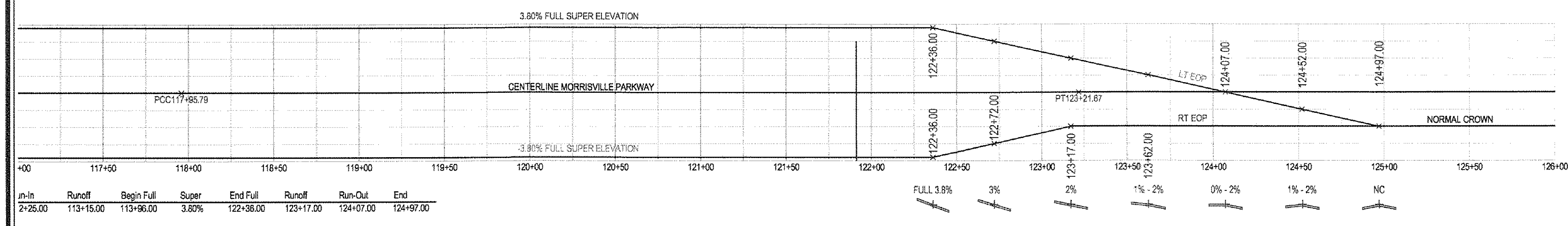

M.F.  
CHARLES R. GIBSON AND  
WIFE BETTY P. GIBSON  
DB 8453 PG 2792  
BM 1980 PG 364  
PIN# 0735.04-60-8872

MATCH LINE  
STA 123+50

NC 55

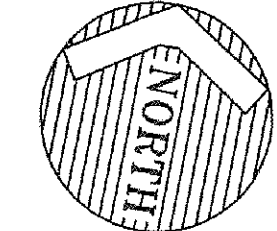
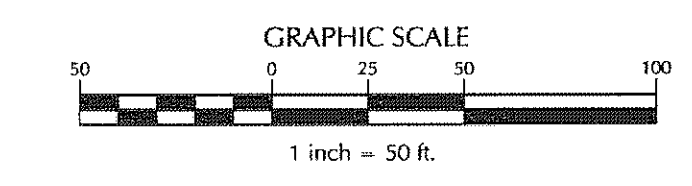

Cary Project Number 10-SB-004-B  
Cary HTE Number 12-1085  
**Approved by the Town of Cary**  
Development Review Committee  
Planner: *[Signature]* Date: 01/24/2012