

K:\1\14-0226\140226-001 Property\DWG\DRN North\Construction\Drawings\DRN_X1.dwg, June 15, 2016 11:32:27 AM - TOWNSEND, CHARLES

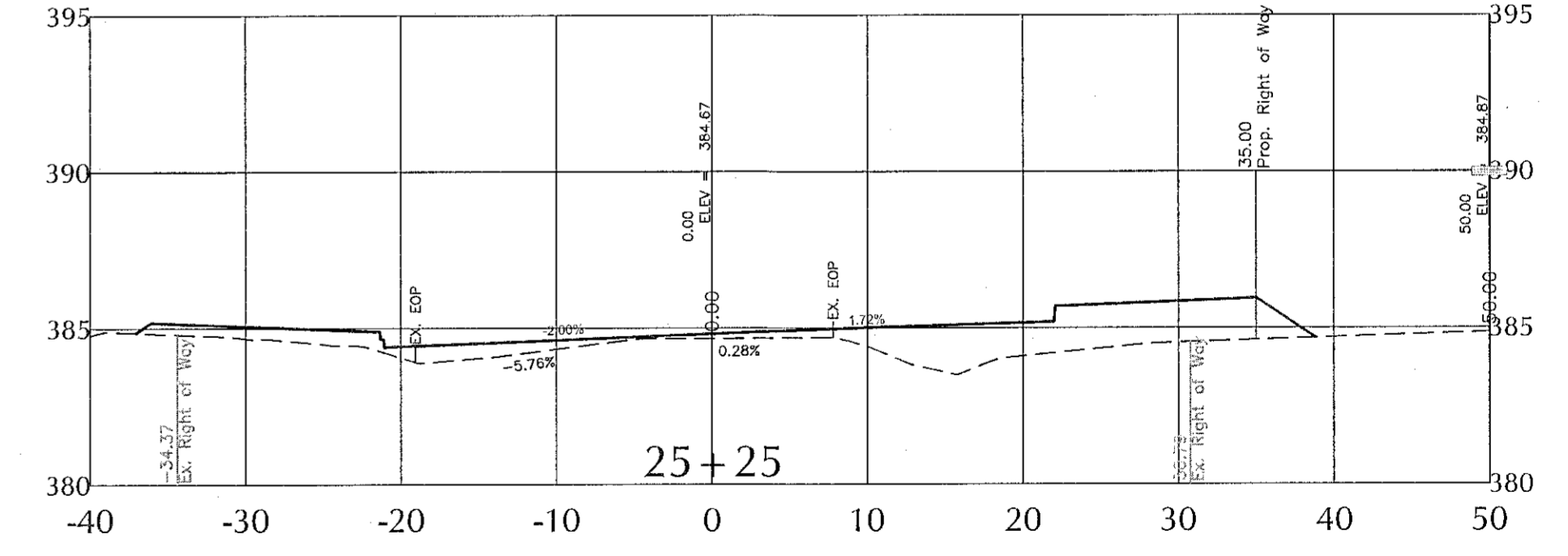

IN AREAS OF EXISTING PAVEMENT WHERE THE PROPOSED FINISHED GRADE IS LOWER THAN THE EXISTING GRADE, THE EXISTING PAVEMENT AND BASE SHALL BE REMOVED AND REPLACED WITH THE DESIGN PAVEMENT SECTION, UNLESS SUBSURFACE INVESTIGATION BY THE GEOTECHNICAL ENGINEER FINDS THAT THE RESULTING PAVEMENT SECTION MEETS OR EXCEEDS THE DESIGN PAVEMENT SECTION, SUBJECT TO APPROVAL BY NCDOT.

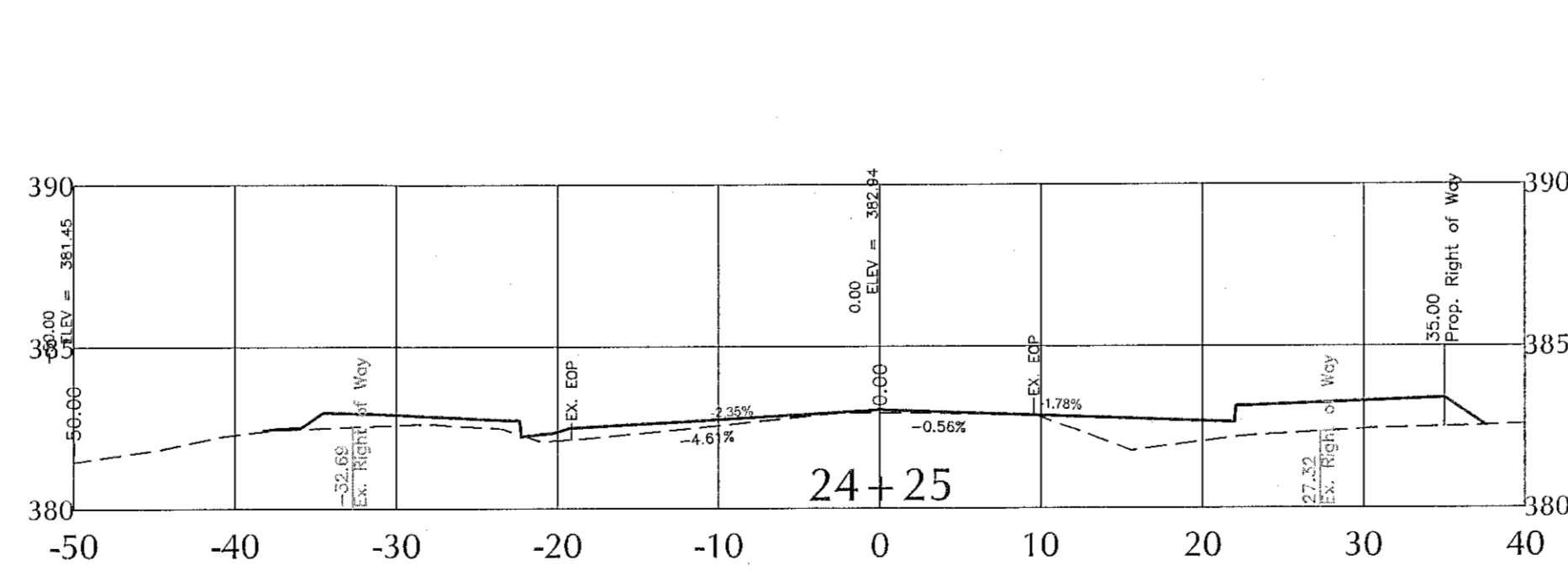
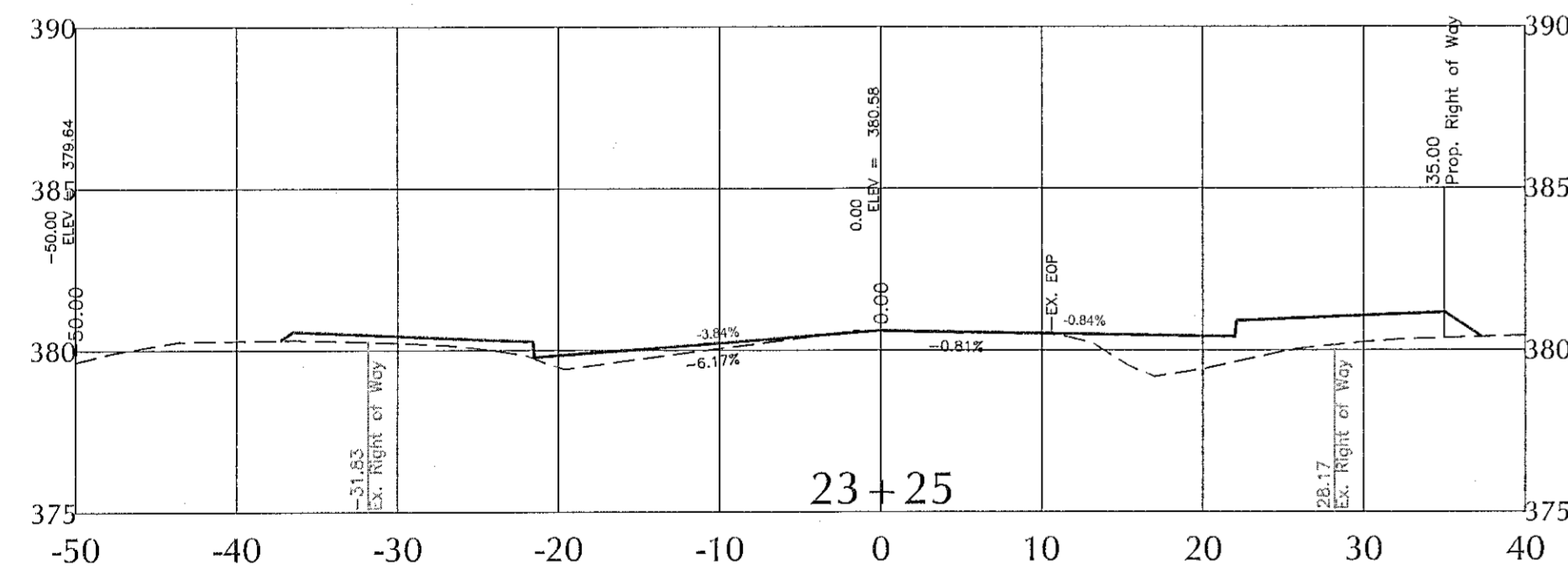
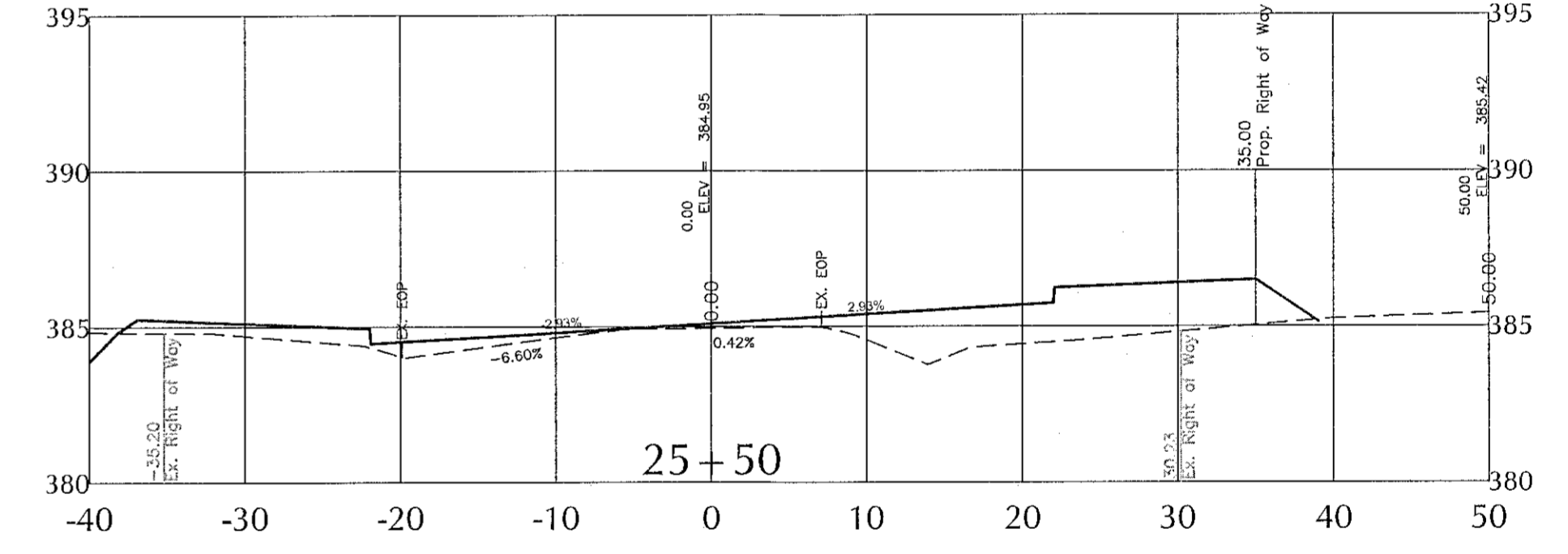
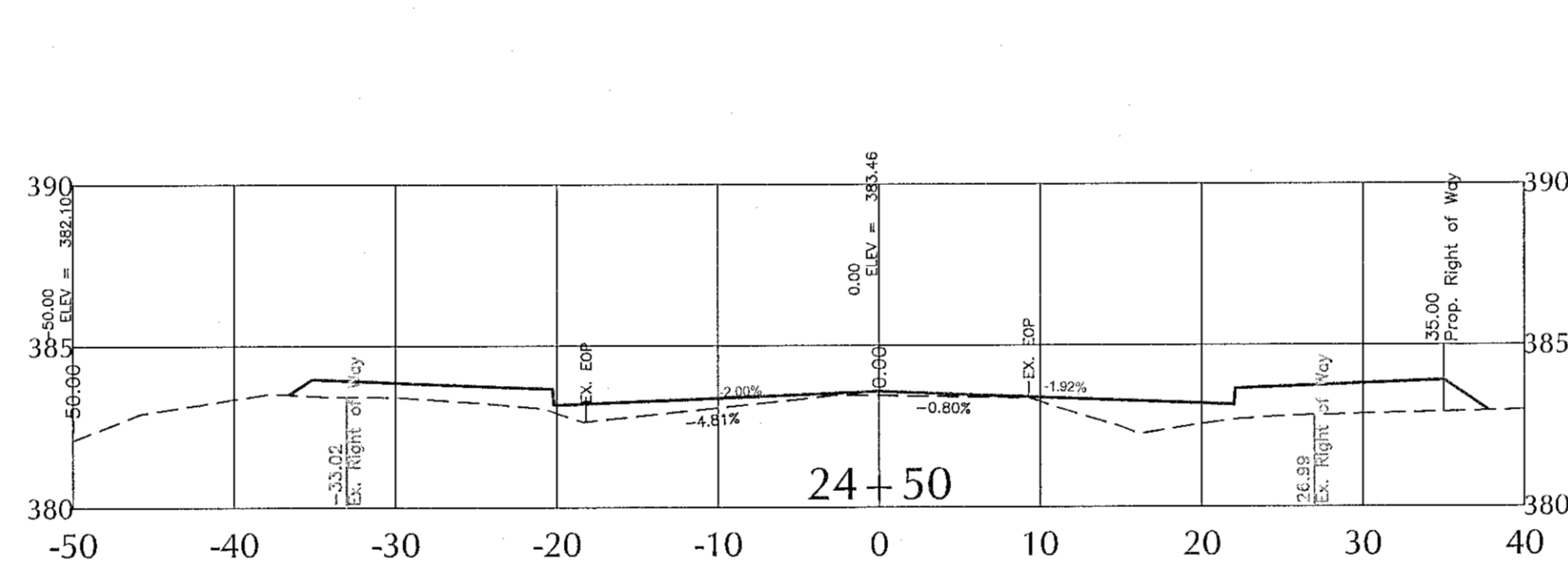
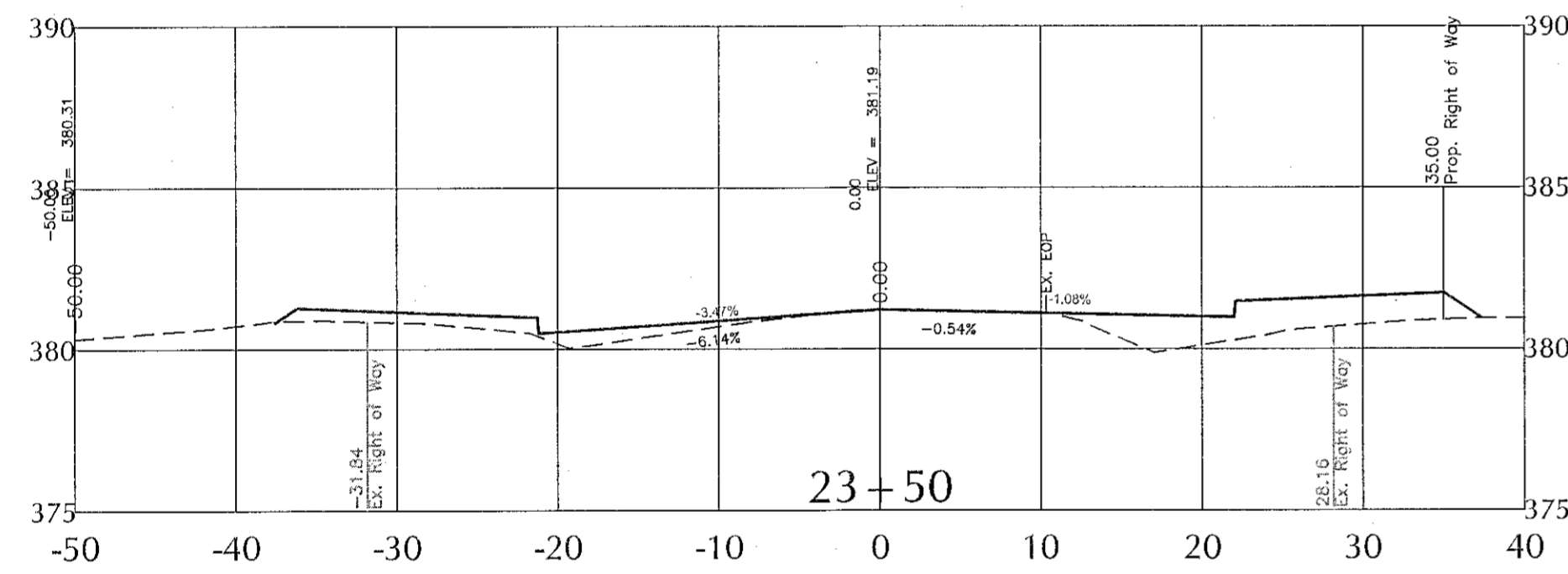
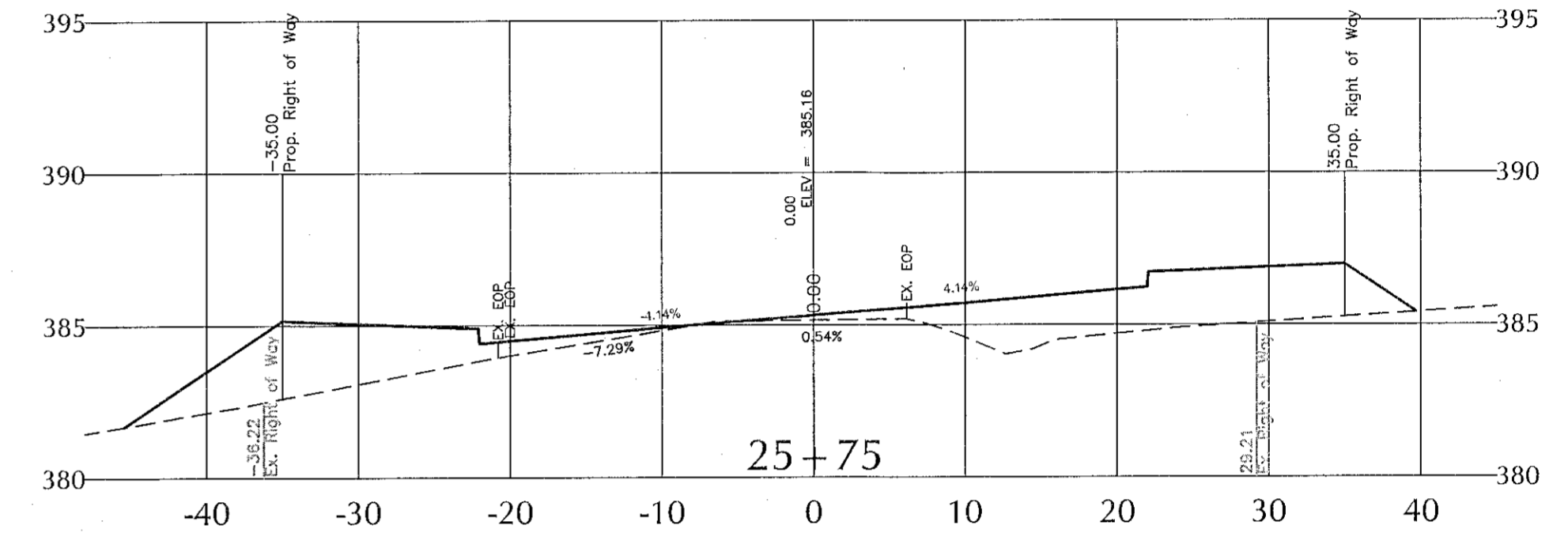
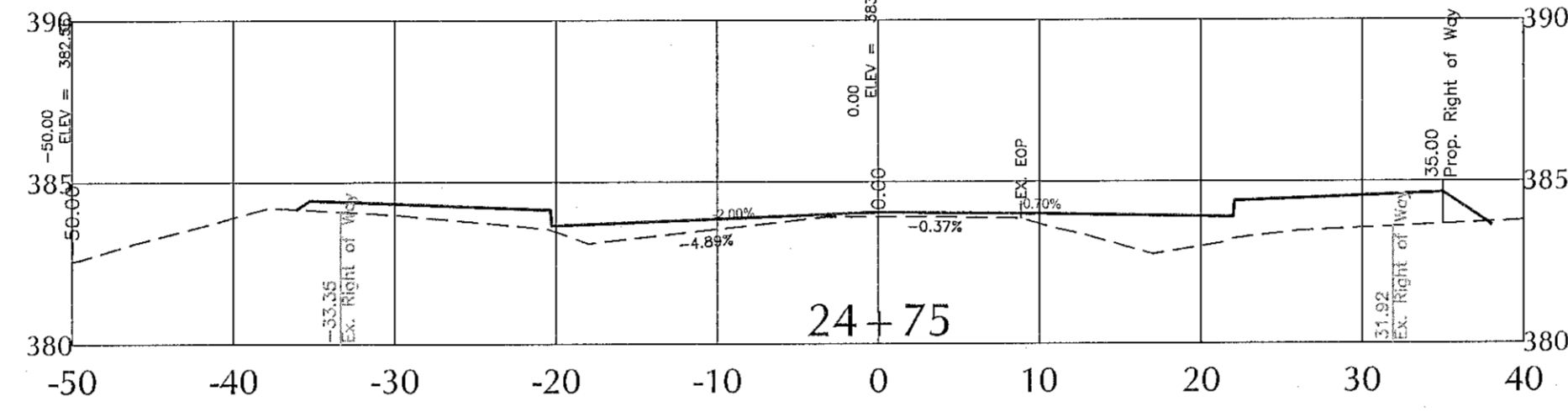
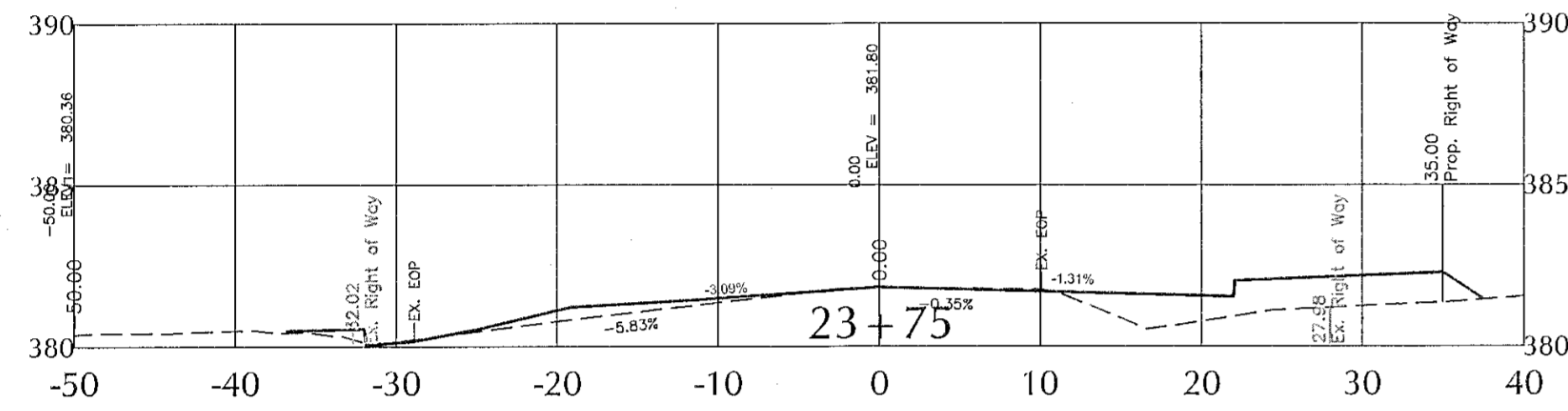
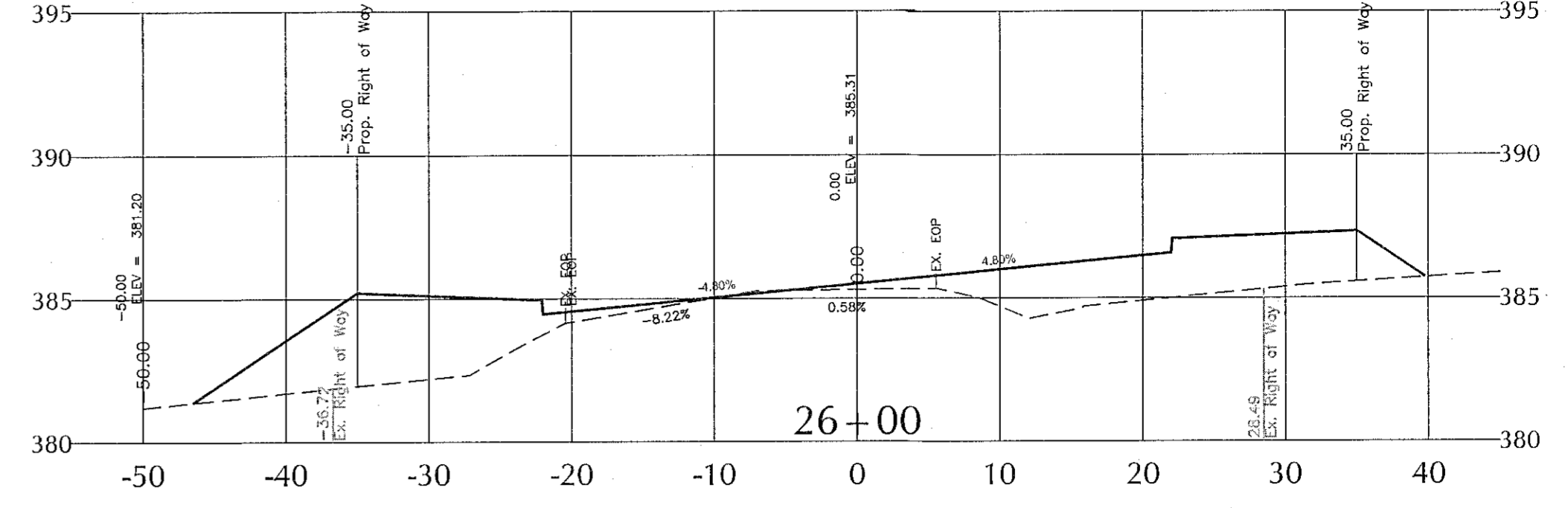
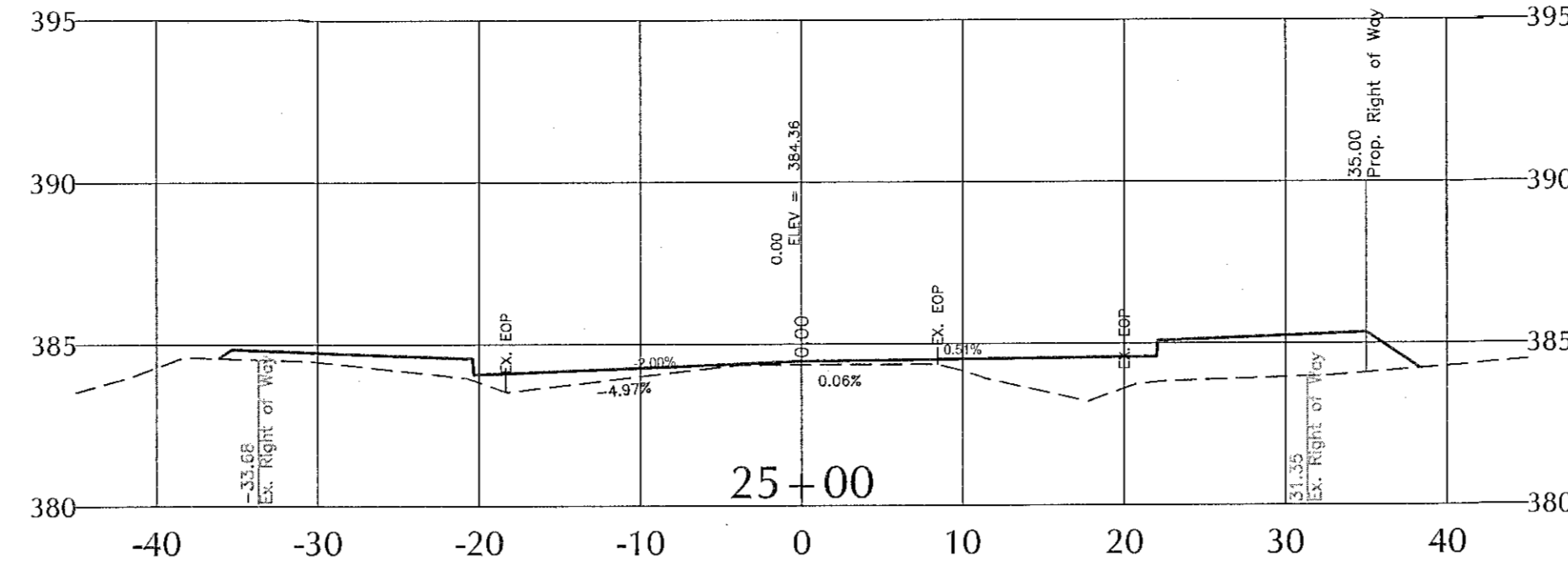
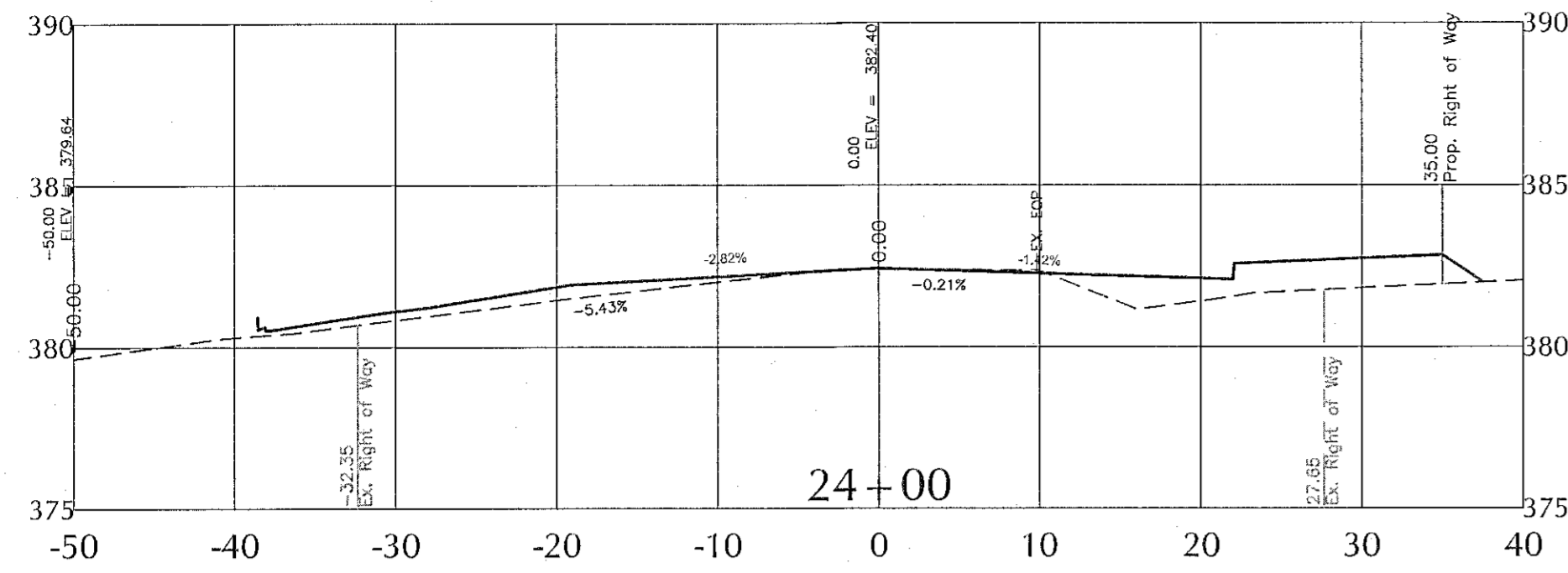
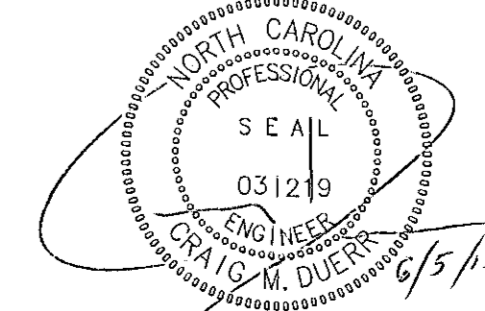

Cary Project Number 14-5B-022
 Cary HTE Number 15-0312
Approved by the Town of Cary
 Development Review Committee
 Planner *M. D. L.* Date *6/29/15*

No.	Revision	Date	By	Scale
1	TOWN OF CARY PRELIMINARY	07/22/14	CBG	
2	TOWN OF CARY PRELIMINARY	08/11/14	CBG	
3	TOWN OF CARY PRELIMINARY	08/28/15	CBG	
4	FOR APPROVAL	08-22-15	CBG	
5	FINAL FOR APPROVAL	08-05-15	EBB	

Sheet No. **X2**