

K:\1513-0250\152551-251- Property\04\Site\North Construction\Drawings\Site\11 green\hgs school cross-sections.dwg - Monday, June 15, 2015 11:33:33 AM - TOWNSEND, CHARLES

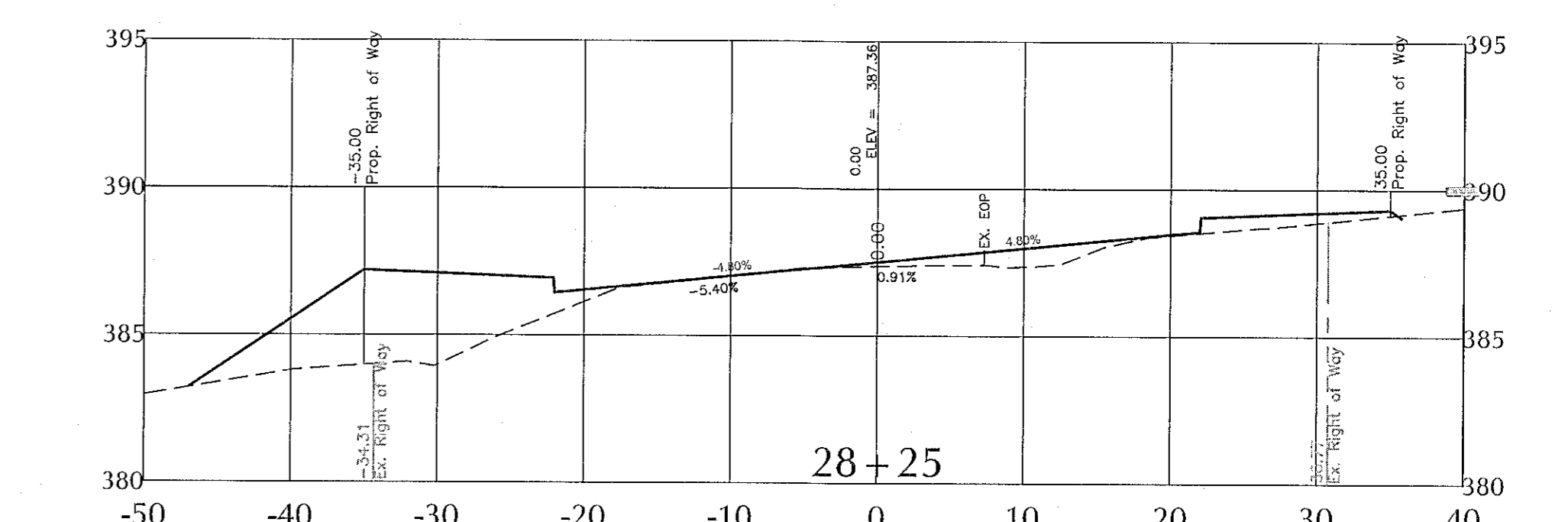

IN AREAS OF EXISTING PAVEMENT WHERE THE PROPOSED FINISHED GRADE IS LOWER THAN THE EXISTING GRADE, THE EXISTING PAVEMENT AND BASE SHALL BE REMOVED AND REPLACED WITH THE DESIGN PAVEMENT SECTION, UNLESS SUBSURFACE INVESTIGATION BY THE GEOTECHNICAL ENGINEER FINDS THAT THE RESULTING PAVEMENT SECTION MEETS OR EXCEEDS THE DESIGN PAVEMENT SECTION, SUBJECT TO APPROVAL BY NCDOT.

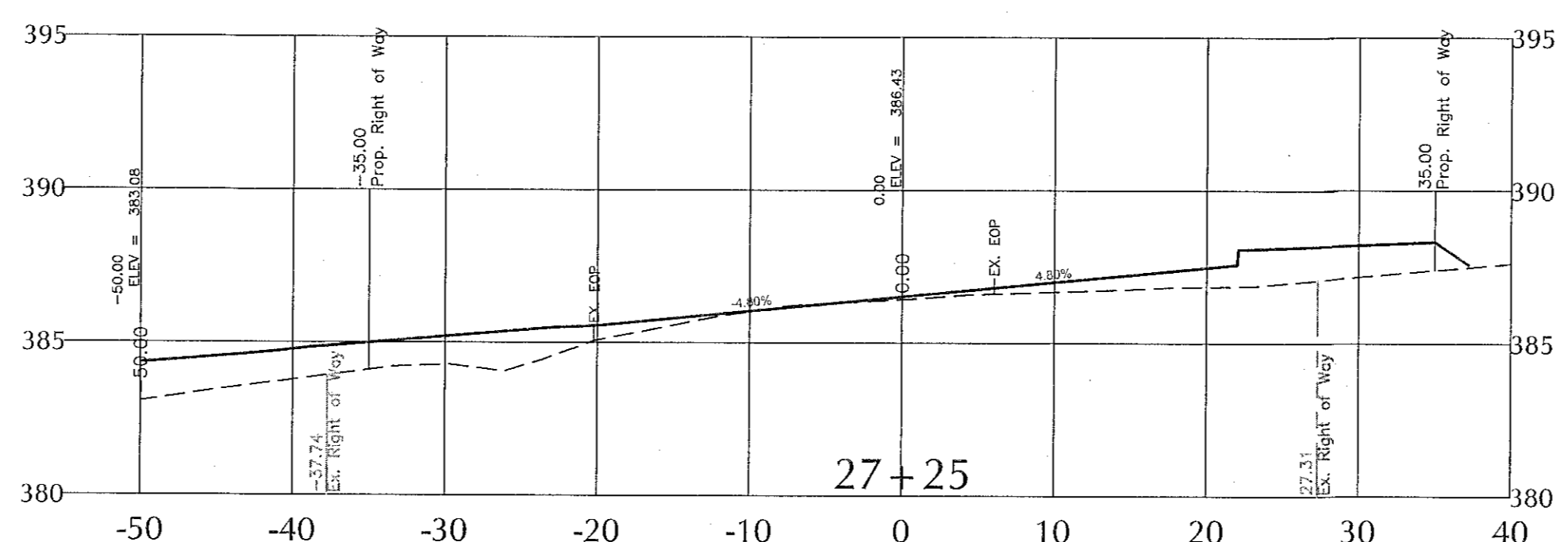
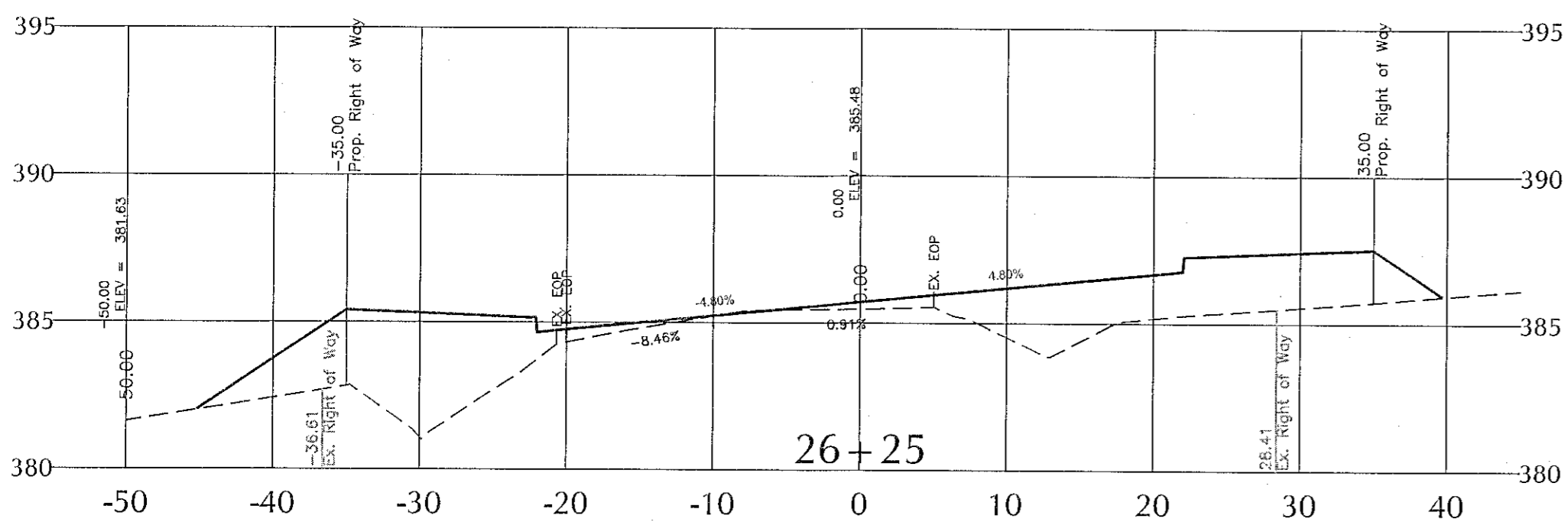
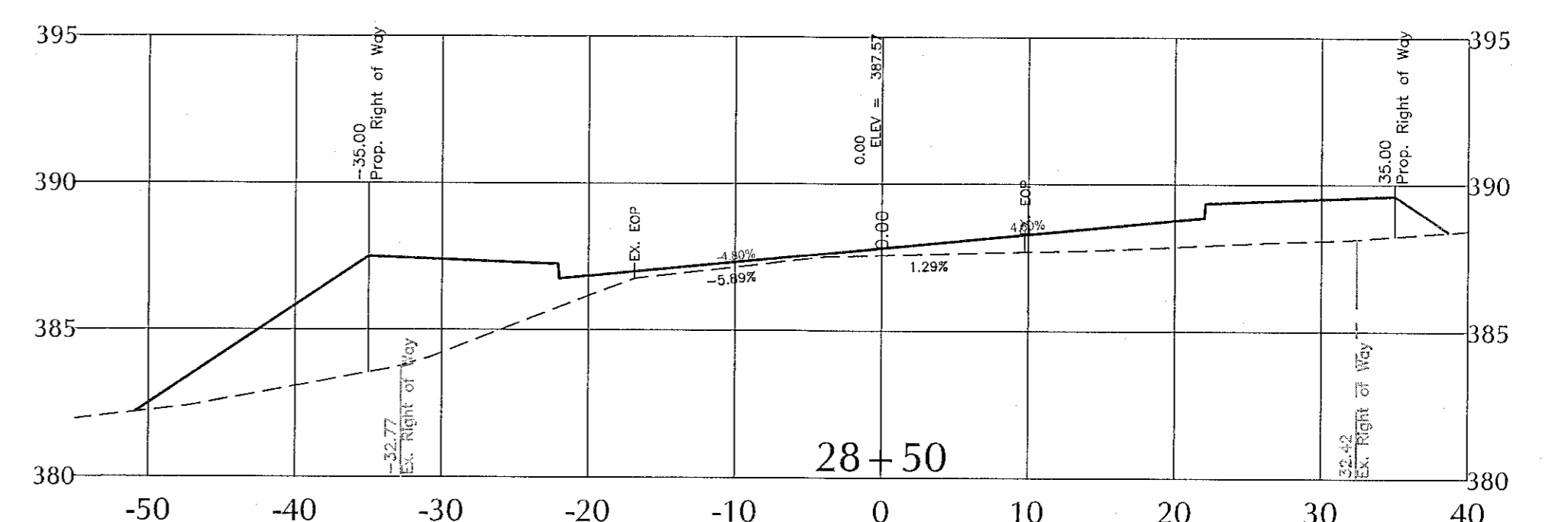
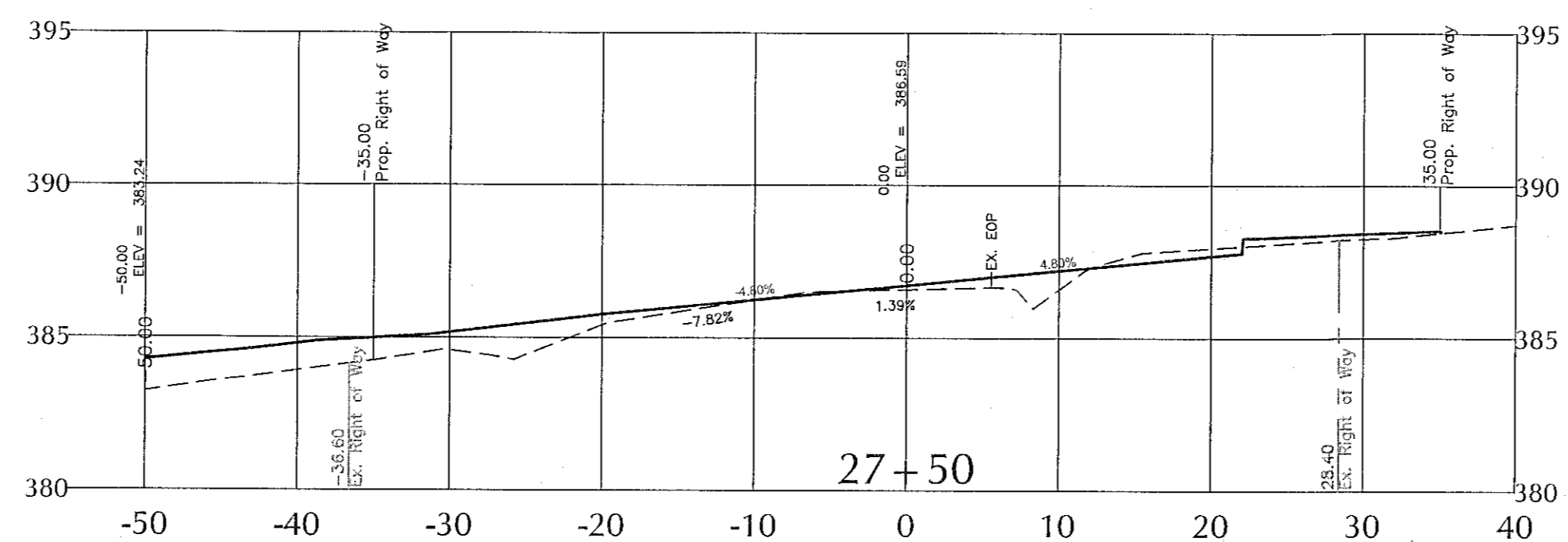
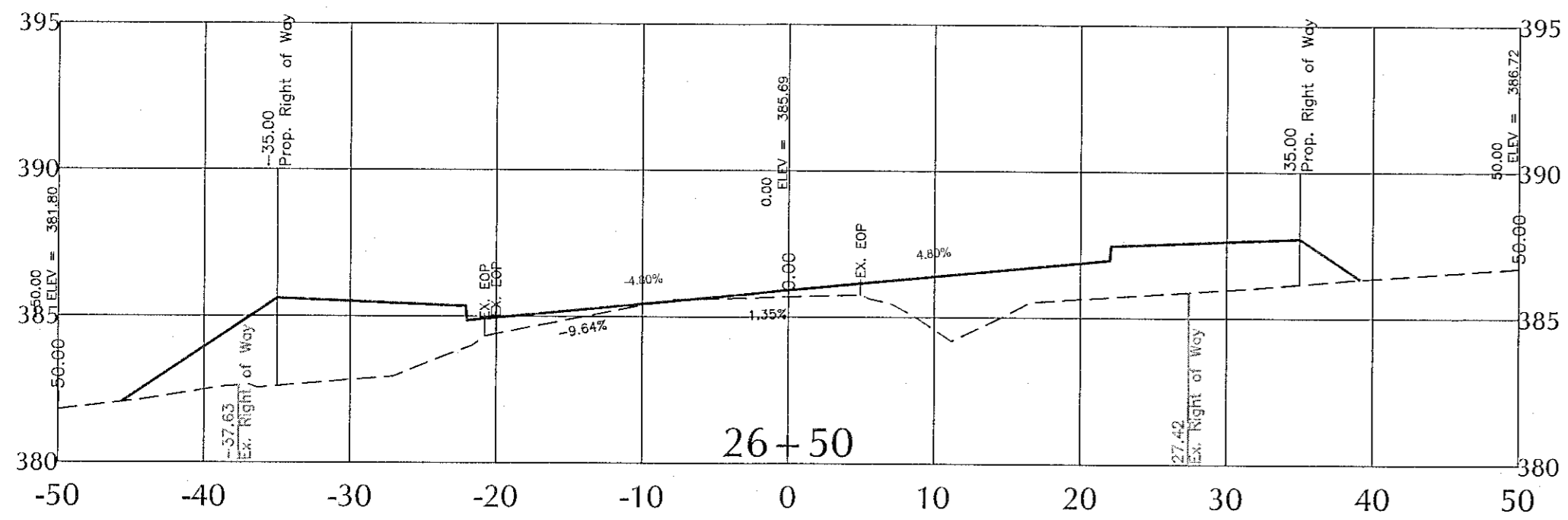
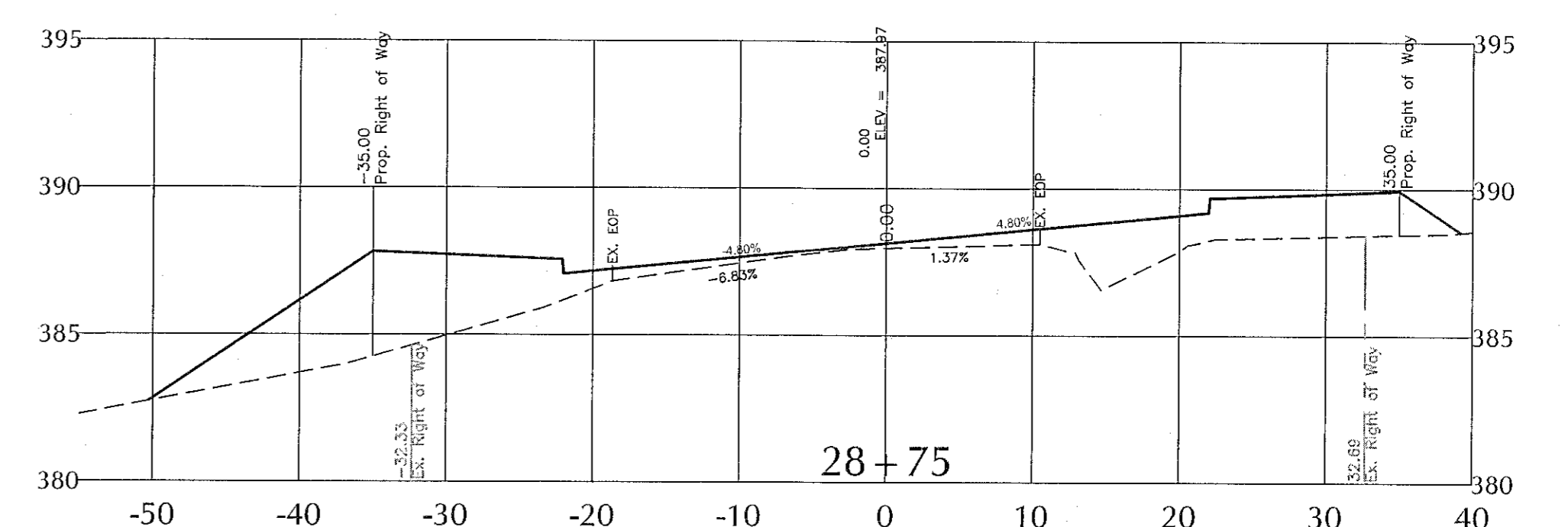
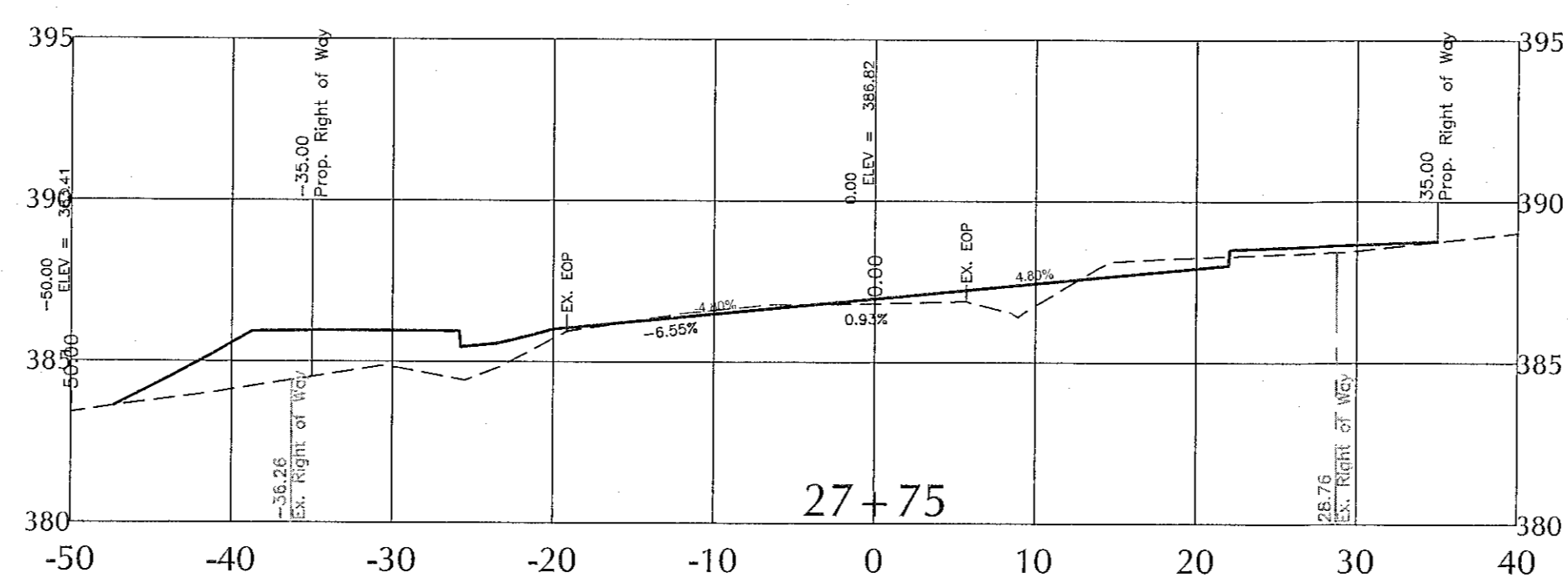
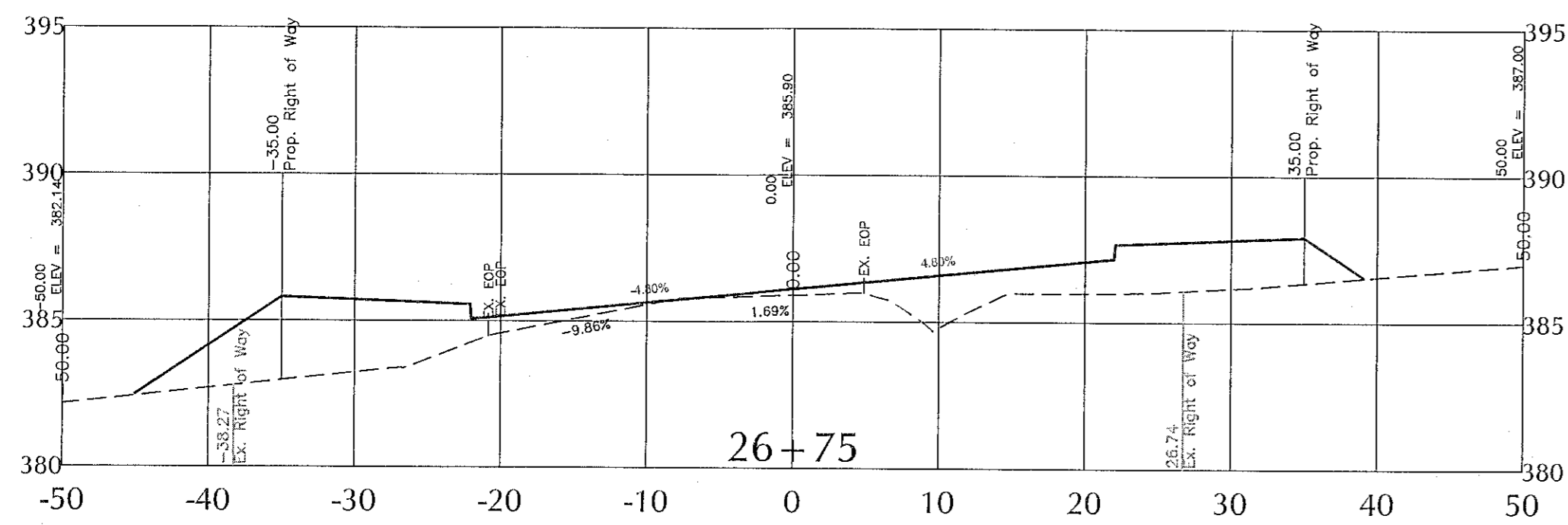
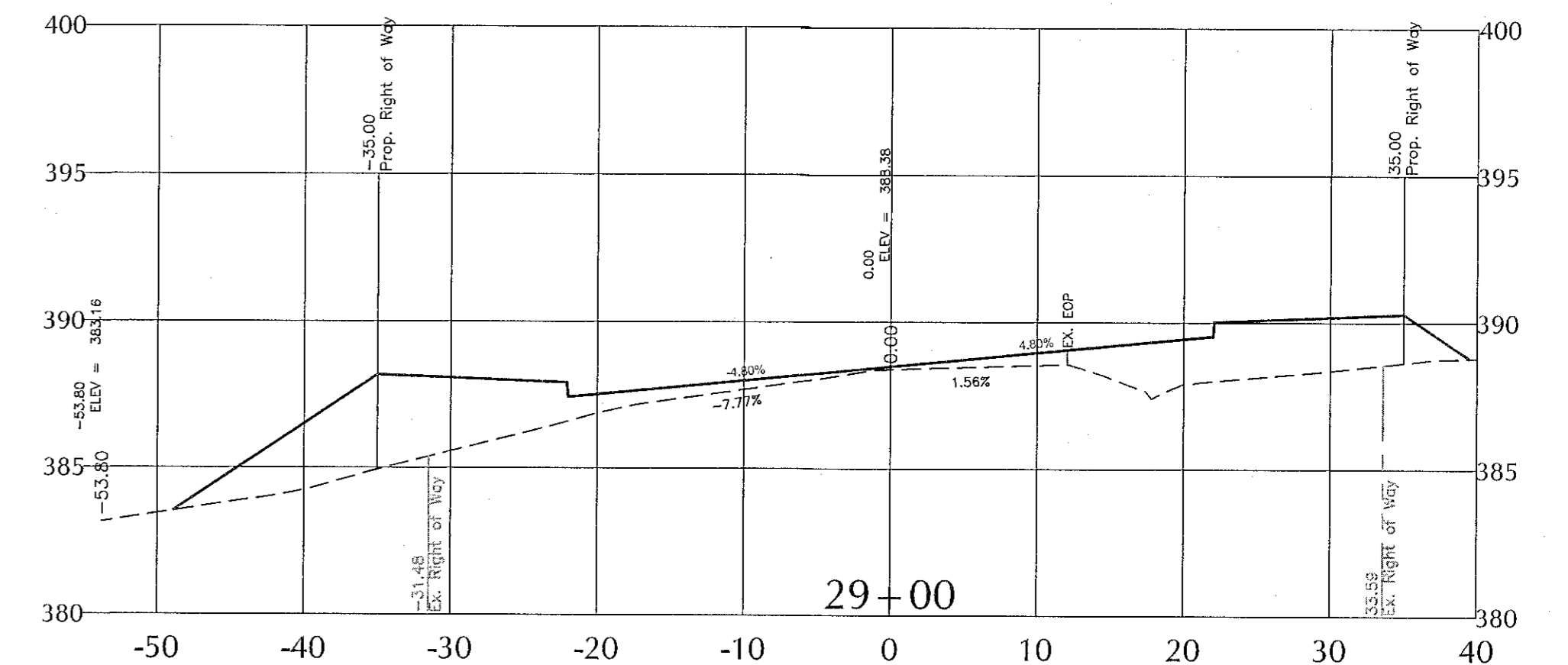
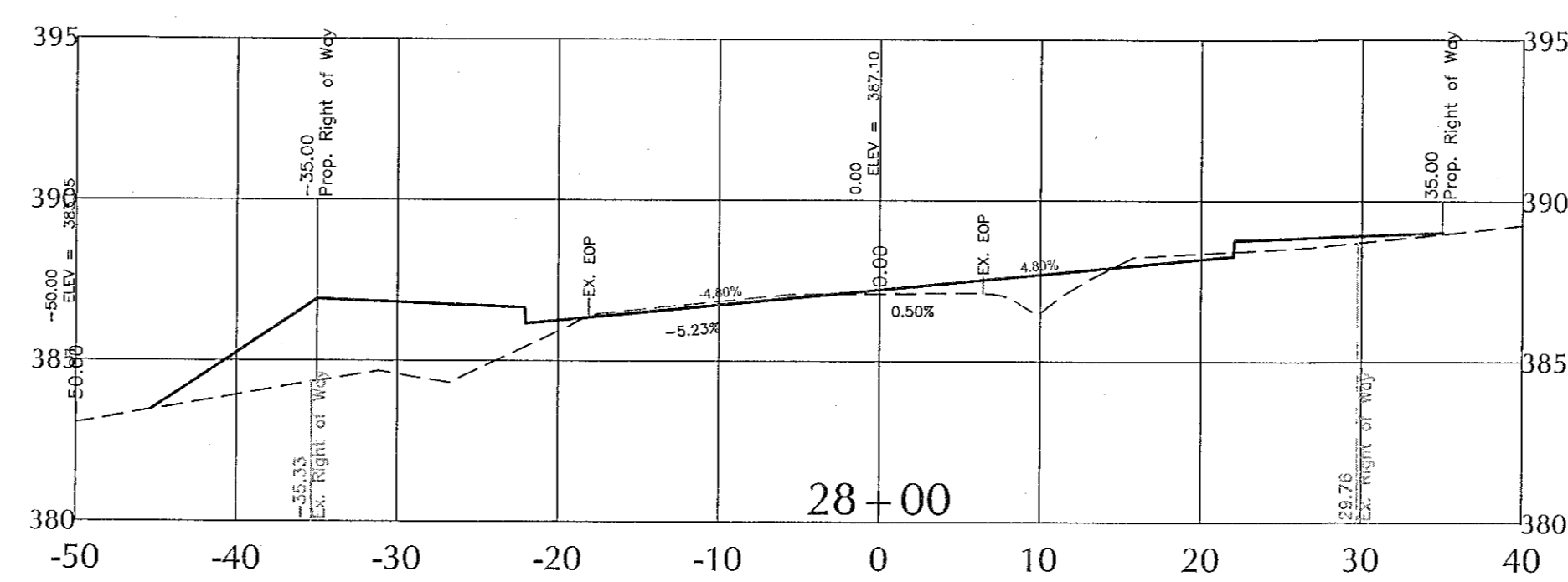
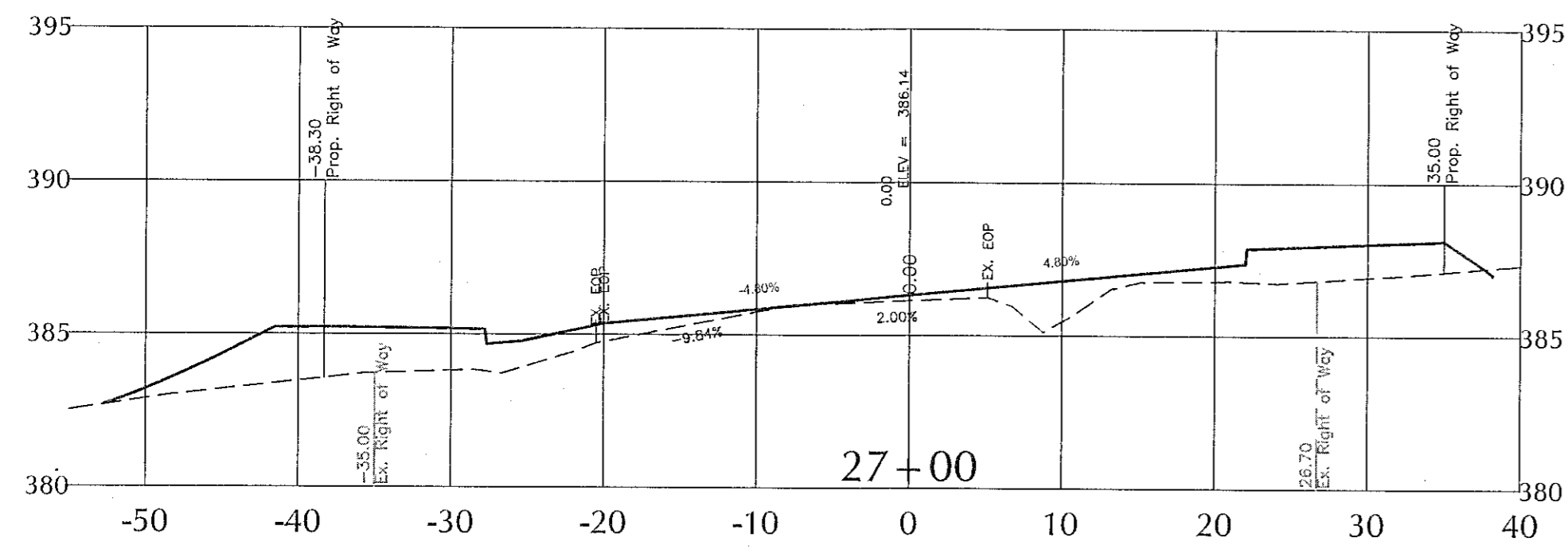
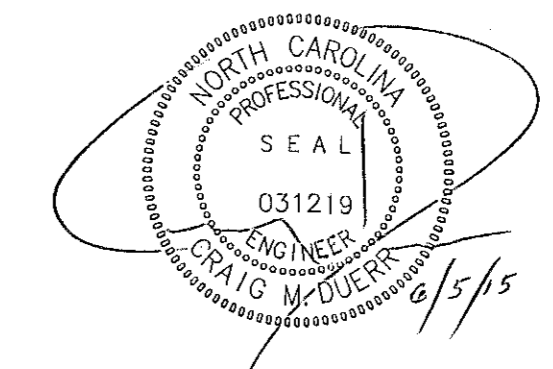

Cary Project Number 14-SB-022  
 Cary HTE Number 15-0312  
**Approved by the Town of Cary**  
 Development Review Committee  
 Planner *D. Reed* Date *6/5/15*

**WITHERS & RAVENEL**  
 ENGINEERS | PLANNERS | SURVEYORS  
 115 Mackintosh Drive, Cary, North Carolina 27511 | 919-490-1500 | www.witwithers.com | License No. C4002

CROSS-SECTIONS (3 of 6)

OAKS AT SEARS FARM

No.	Revision	Date	By	Design	Scale
1	TOWN OF CARY 1ST REVIEW	11/7/14	CMO	EXAMIN BY	DATE
2	TOWN OF CARY 2ND REVIEW	07/22/15	CMO	BRB	09/11/14
3	TOWN OF CARY 3RD REVIEW	08/26/15	CMO	CMO	08/26/15
4	TOWN OF CARY 4TH REVIEW	08/26/15	CMO	CMO	08/26/15
5	FINAL FOR APPROVAL	06-05-15	BRB	CMO	21.30351.00

Sheet No. **X3**