

PARK VILLAGE PLANNED UNIT DEVELOPMENT

RECREATION CENTER SITE PLAN PHASE ONE

1992

PARK VILLAGE LIMITED PARTNERSHIP
MORRISVILLE, NORTH CAROLINA



EDI ARCHITECTURE □ PLANNING
3731 BRIARPARK DRIVE, SUITE 300
HOUSTON, TEXAS 77042
(713) 789-0395
HOUSTON, SAN FRANCISCO, NEW YORK

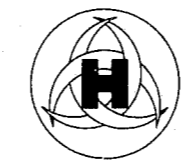

HUDGINS & ASSOCIATES, INC.
CONSULTING ENGINEERS
4915 WATERS EDGE DRIVE, SUITE 285
RALEIGH, NORTH CAROLINA 27606
(919) 859-1314

APPROVED
DATE: 1-15-93
BY: JH Tucker
TOWN OF CARY
ENGINEERING DEPARTMENT

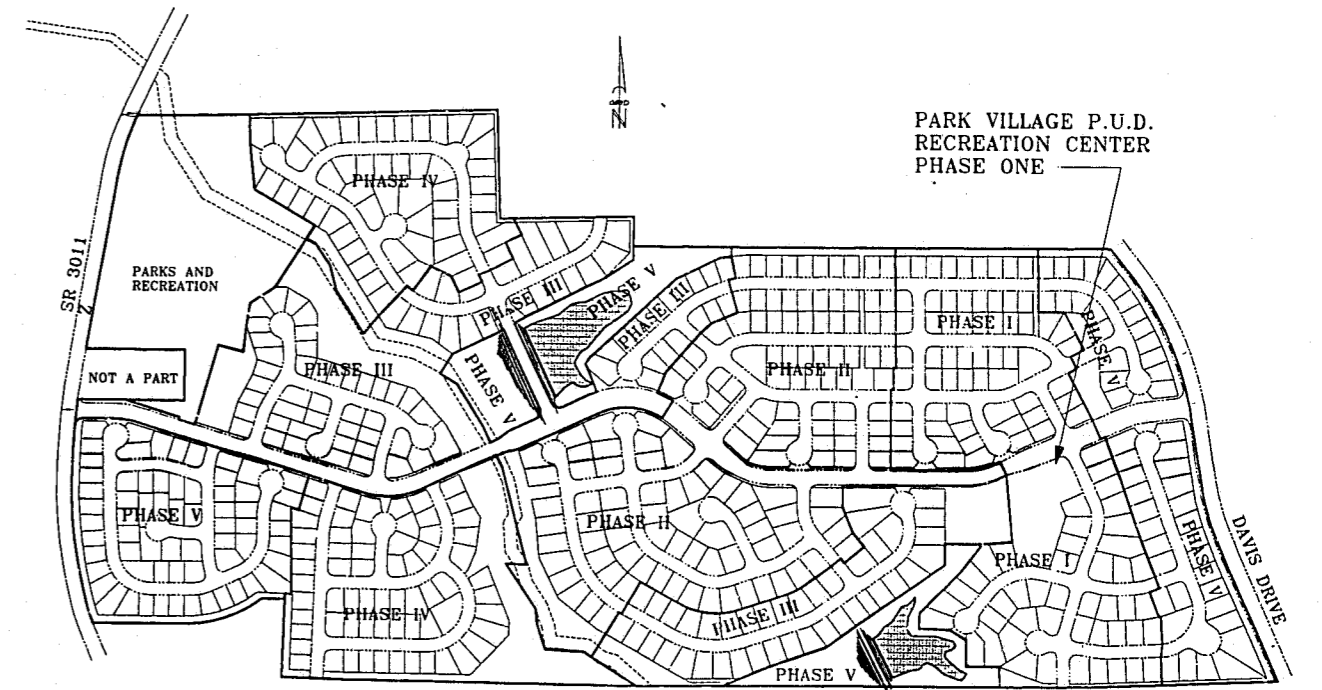

SCALE: 1" = 500'
SP-41-PUD-92
TOC STBFF
APPROVED
12-30-92
JH

VICINITY MAP

OFFICIAL APPROVED PLAN

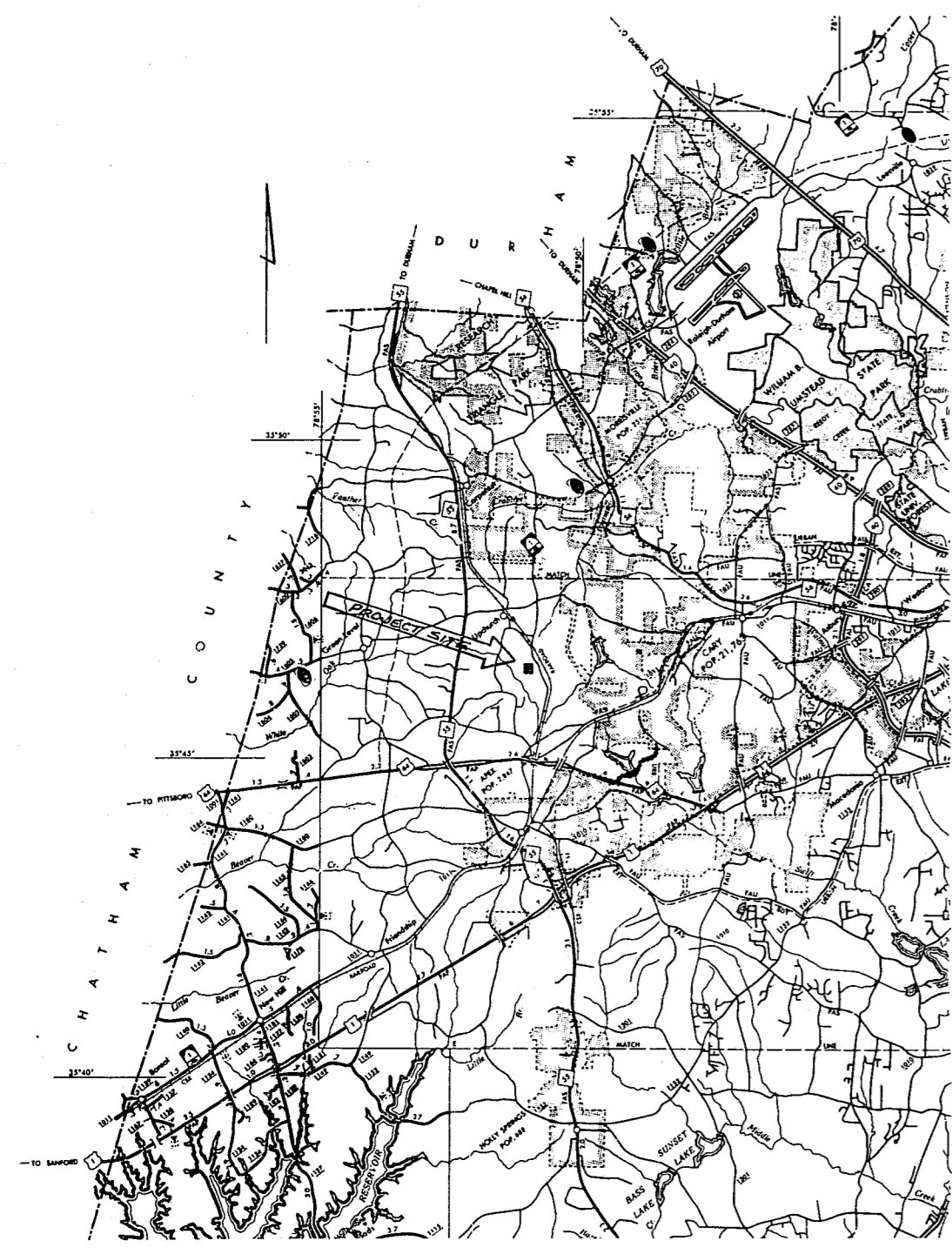

LOCATION MAP