

TYPICAL PAVEMENT SECTION
TO BE USED THROUGH PARKING AREAS
(NOT TO SCALE)

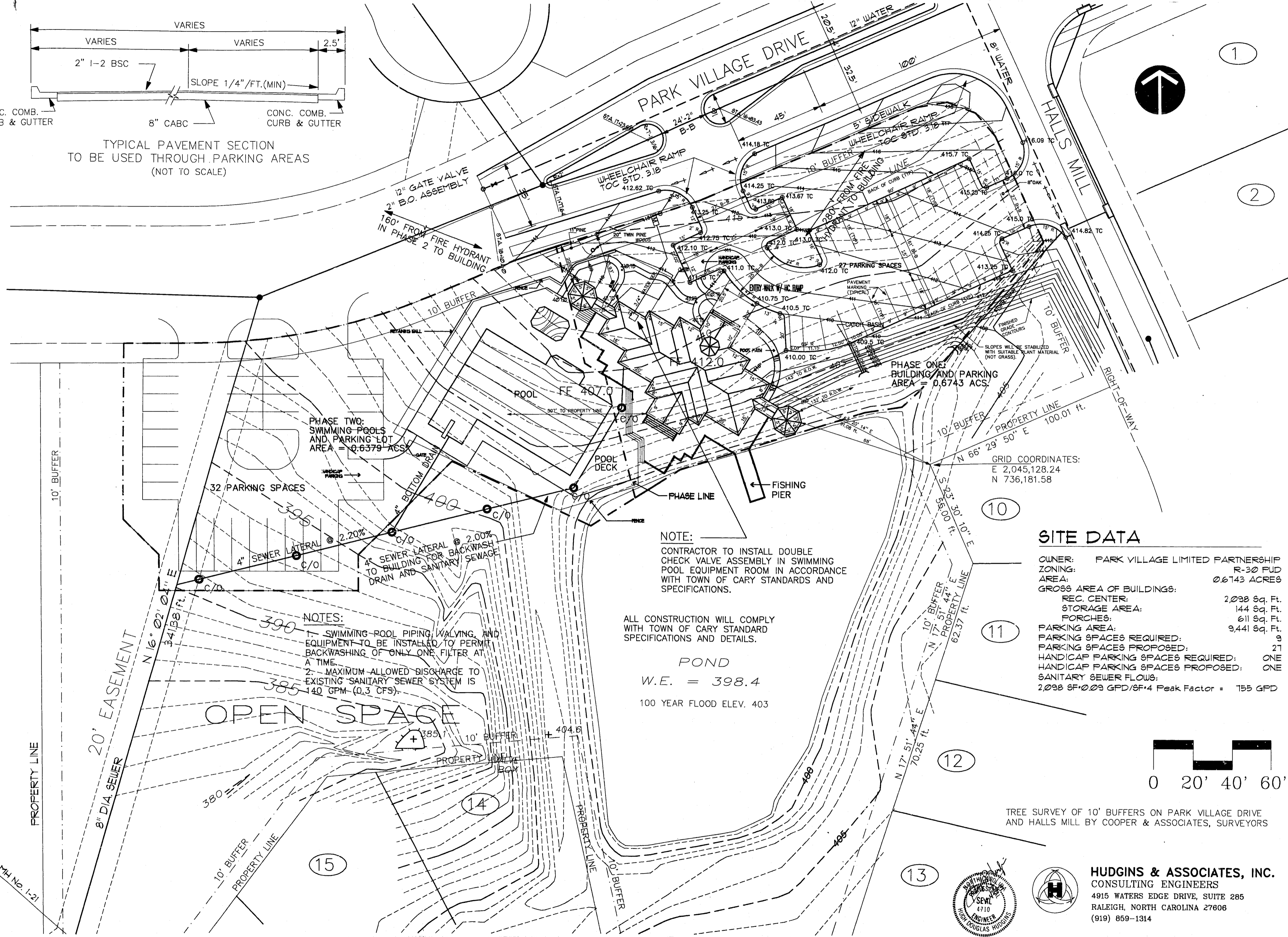

NOTES:
1- SWIMMING POOL PIPING, VALVING, AND EQUIPMENT TO BE INSTALLED TO PERMIT BACKWASHING OF ONLY ONE FILTER AT A TIME.
2- MAXIMUM ALLOWED DISCHARGE TO EXISTING SANITARY SEWER SYSTEM IS 140 GPM (0.3 CFS).

NOTE:
CONTRACTOR TO INSTALL DOUBLE CHECK VALVE ASSEMBLY IN SWIMMING POOL EQUIPMENT ROOM IN ACCORDANCE WITH TOWN OF CARY STANDARDS AND SPECIFICATIONS.

ALL CONSTRUCTION WILL COMPLY WITH TOWN OF CARY STANDARD SPECIFICATIONS AND DETAILS.

POND
W.E. = 398.4
100 YEAR FLOOD ELEV. 403

GRID COORDINATES:
E 2,045,128.24
N 736,181.58

SITE DATA

OWNER:	PARK VILLAGE LIMITED PARTNERSHIP
ZONING:	R-30 FUD
AREA:	0.6743 ACRES
GROSS AREA OF BUILDINGS:	
REC. CENTER:	2,038 Sq. Ft.
STORAGE AREA:	144 Sq. Ft.
PORCHES:	611 Sq. Ft.
PARKING AREA:	9,441 Sq. Ft.
PARKING SPACES REQUIRED:	9
PARKING SPACES PROPOSED:	27
HANDICAP PARKING SPACES REQUIRED:	ONE
HANDICAP PARKING SPACES PROPOSED:	ONE
SANITARY SEWER FLOWS:	
	2,038 SF @ 0.03 GPD/SF + 4 Peak Factor = 155 GPD

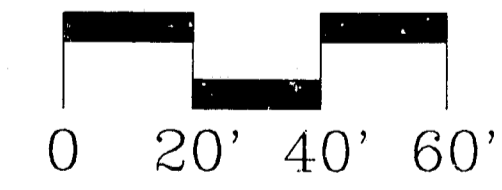

TREE SURVEY OF 10' BUFFERS ON PARK VILLAGE DRIVE AND HALLS MILL BY COOPER & ASSOCIATES, SURVEYORS

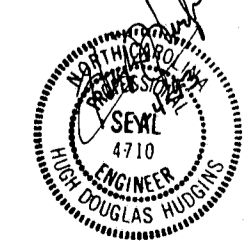

HUGGINS & ASSOCIATES, INC.
CONSULTING ENGINEERS
4915 WATERS EDGE DRIVE, SUITE 285
RALEIGH, NORTH CAROLINA 27606
(919) 859-1314

RECREATION CENTER
SITE PLAN
1"=20'

PARK VILLAGE
SUNSTAR HOMES

EDM ARCHITECTURE & PLANNING
300 BRIDGEMAN DRIVE, SUITE 200
FEDERAL CENTER
HOUSTON, SAN FRANCISCO, NEW YORK

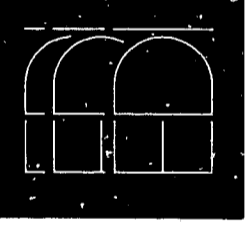

DRAWN BY:
JAY CALDWELL

CHECKED: _____ DATE _____
REVISIONS CHECKED: _____ DATE _____

PROJECT NO: 92066
ISSUED: _____
PLOT DATE: JAN. 11, 1993
REVISED: JAN. 4, 1993

FILE: 206607E
COPYRIGHT © 1993 BY HUGGINS & ASSOCIATES, INC. ALL RIGHTS RESERVED.
DRAWING NUMBER