

K:\15-0030\150037.10-Chapel Hill Road Townes\CAD\Plan.pro Tue Jul 23, 2019 11:44:36AM WITHERS & RAVENEL, ENGINEERS, PLANNERS & SURVEYORS

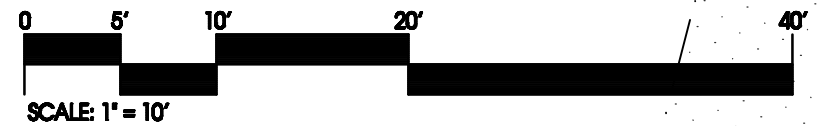

APPROVED by the Town of Cary
Development Review Committee

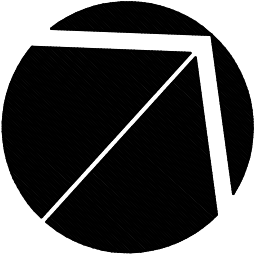
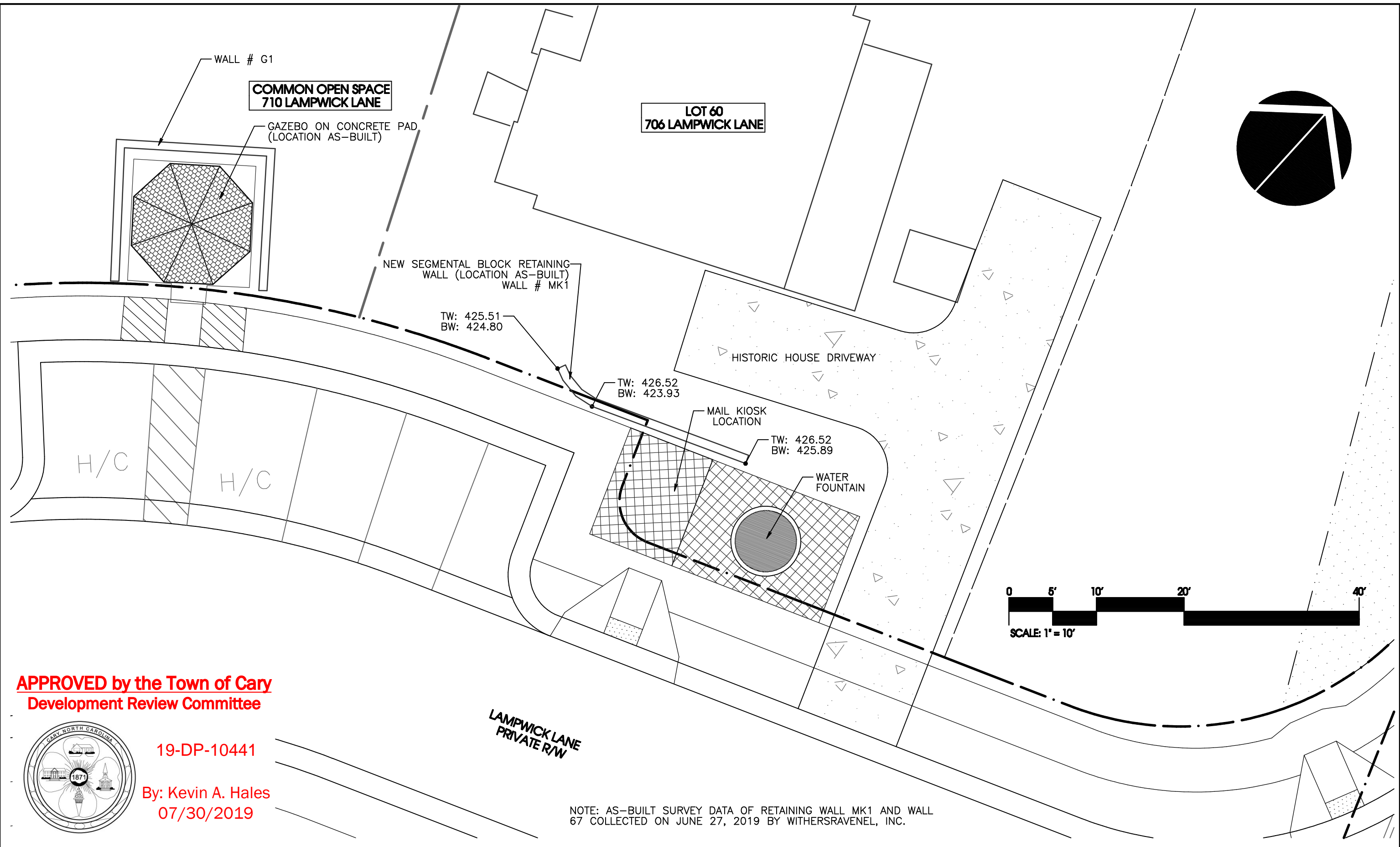

19-DP-10441

By: Kevin A. Hales
07/30/2019

NOTE: AS-BUILT SURVEY DATA OF RETAINING WALL MK1 AND WALL 67 COLLECTED ON JUNE 27, 2019 BY WITHERSRAVENEL, INC.

No.	Revision	Date	By	Designer	Scale
1	Town Comments	7/23/19	RSF	WR	1" = 10'
				Drawn By	Date
				RSF	7/3/2019
				Checked By	Job No.
				RSF	2150037.10

PARK WEST TOWNES RETAINING WALLS
TOWN OF CARY WAKE COUNTY NORTH CAROLINA

MINOR ALTERATION PLAN
RETAINING WALL MK1

WithersRavenel
Engineers | Planners
137 S. Wilmington Street | Suite 200 | Raleigh, NC 27601
t: 919.469.3340 | license #: C-0832 | www.withersravenel.com

Sheet No.
2 of 4