

NOTE: AS-BUILT SURVEY DATA OF RETAINING WALL 25 PROVIDED BY BATEMAN CIVIL SURVEY COMPANY TO WITHERSRAVENEL ON 7/10/2019.

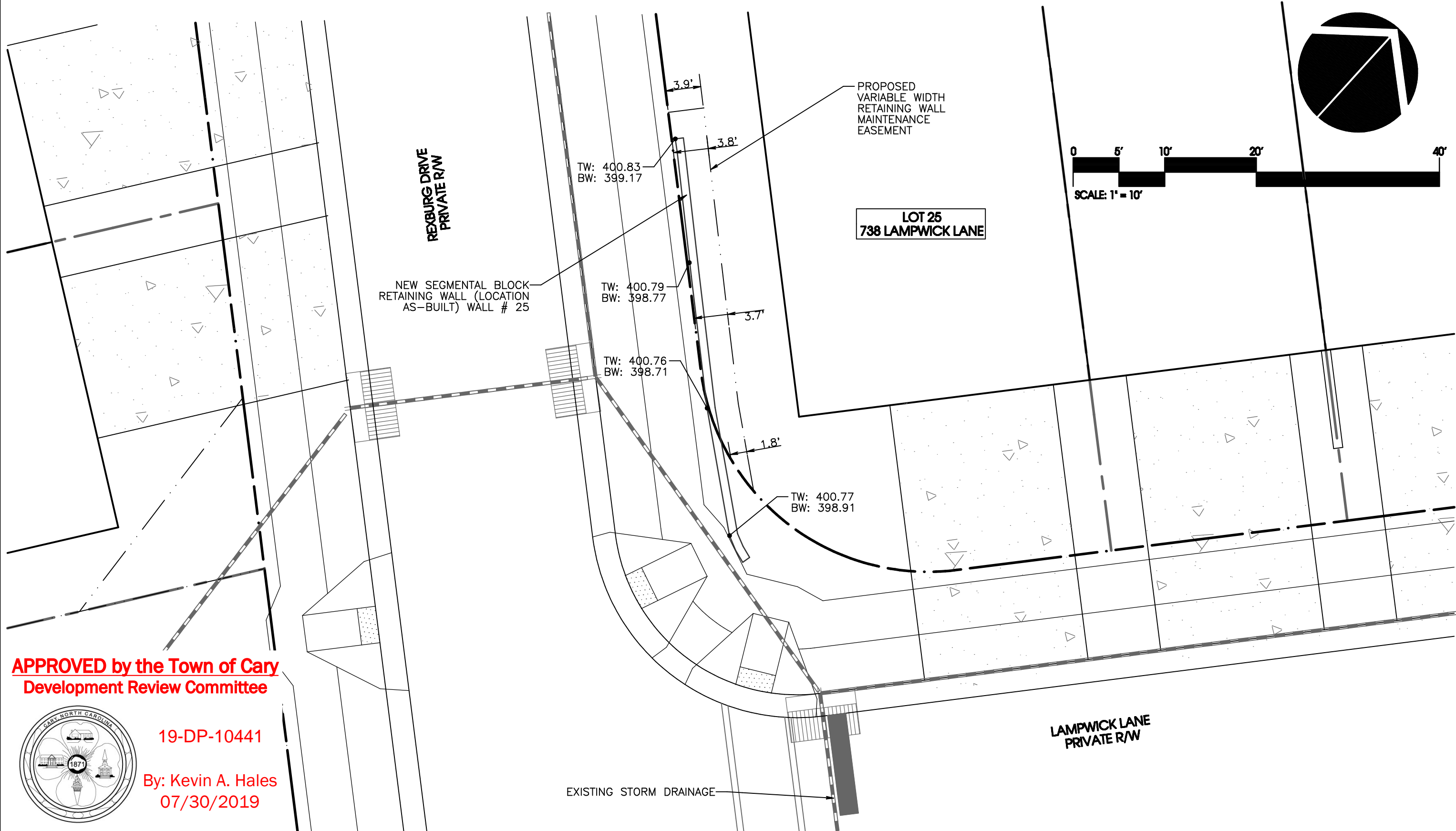

**APPROVED by the Town of Cary
Development Review Committee**



19-DP-10441

**By: Kevin A. Hales
07/30/2019**

K:\15-0030\150037.10-Chapel Hill Road Townes\CAD\Plan.pro Tue Jul 23, 2019 11:45:27AM WITHERS & RAVENEL, ENGINEERS, PLANNERS & SURVEYORS

No.	Revision	Date	By	Designer	WR	Scale
1	Town Comments	7/23/19	RSF			1" = 10'
				Drawn By		Date
				RSF		7/3/2019
				Checked By		Job No.
				RSF		2150037.10

PARK WEST TOWNES RETAINING WALLS
TOWN OF CARY WAKE COUNTY NORTH CAROLINA

**MINOR ALTERATION PLAN
RETAINING WALL 25**

WithersRavenel
Engineers | Planners
137 S. Wilmington Street | Suite 200 | Raleigh, NC 27601
t: 919.469.3340 | license #: C-0832 | www.withersravenel.com

Sheet No.
4 of 4