

TEMPORARY SEDIMENT TRAP SCHEDULE

| STRUCTURE # | DRAINAGE AREA (AC) | DENUDED AREA (AC) | WIDTH (FT) | SIZE LENGTH (FT) | DEPTH (FT) | WEIR LENGTH (FT) | VOLUME REQD. (CF) | VOLUME PROV. (CF) | SA REQD. (SF) | SA PROV. (SF) |
|-------------|--------------------|-------------------|------------|------------------|------------|------------------|-------------------|-------------------|---------------|---------------|
| W           | 2.77               | 0.90              | 20         | 40               | 5          | 8                | 1,620             | 2,800             | 289           | 800           |
| X           | 0.87               | 0.20              | 13         | 26               | 3          | 4                | 360               | 546               | 60            | 338           |
| Y           | 0.71               | 0.44              | 16         | 32               | 4          | 4                | 792               | 1,024             | 131           | 512           |
| Z           | 0.83               | 0.41              | 16         | 32               | 4          | 4                | 738               | 1,024             | 122           | 512           |
| AB          | 0.30               | 0.30              | 14         | 28               | 4          | 4                | 540               | 672               | 90            | 392           |
| AC          | 0.29               | 0.29              | 14         | 28               | 4          | 4                | 522               | 672               | 87            | 392           |
| AD          | 1.76               | 0.62              | 18         | 35               | 4          | 5                | 1,116             | 1,330             | 195           | 613           |

DOES NOT INCLUDE 1' OF FREE BOARD.

NOTE:  
ALL CONSTRUCTED PONDS SHOWN TO ACT AS TEMPORARY SEDIMENT TRAPS DURING CONSTRUCTION.

- ROADWAY CROSS DRAINAGE PIPING CONSTRUCTION SEQUENCE
1. INSTALL EROSION CONTROL DEVICES AS SHOWN ON PLANS. CLEAR ONLY AS REQUIRED TO CONSTRUCT THESE DEVICES.
  2. INSTALL A TEMPORARY DIVERSION ACROSS ROADWAY AS SHOWN TO NEAREST EROSION CONTROL DEVICE.
  3. CONSTRUCT PIPE FOLLOWING THE BEDDING DETAILS.
  4. WHEN CONSTRUCTION OF CROSS DRAINAGE PIPING IS COMPLETE REMOVE TEMPORARY SILT FENCE ADJACENT TO DIVERSION DITCH ONLY.
  5. BEGIN BACKFILLING AROUND CROSS DRAINAGE PIPING.
  6. INSTALL "FINAL" SILT FENCE AROUND PIPE OUTLET PILES.
  7. REMOVE TEMPORARY DIVERSIONS THAT CROSS PROPOSED ROADWAY.
  8. BEGIN REMAINING ROADWAY CONSTRUCTION.
  9. MAINTAIN ALL EROSION CONTROL DEVICES AS SHOWN TO PREVENT SEDIMENT ENTERING THE CROSS DRAIN PIPING.

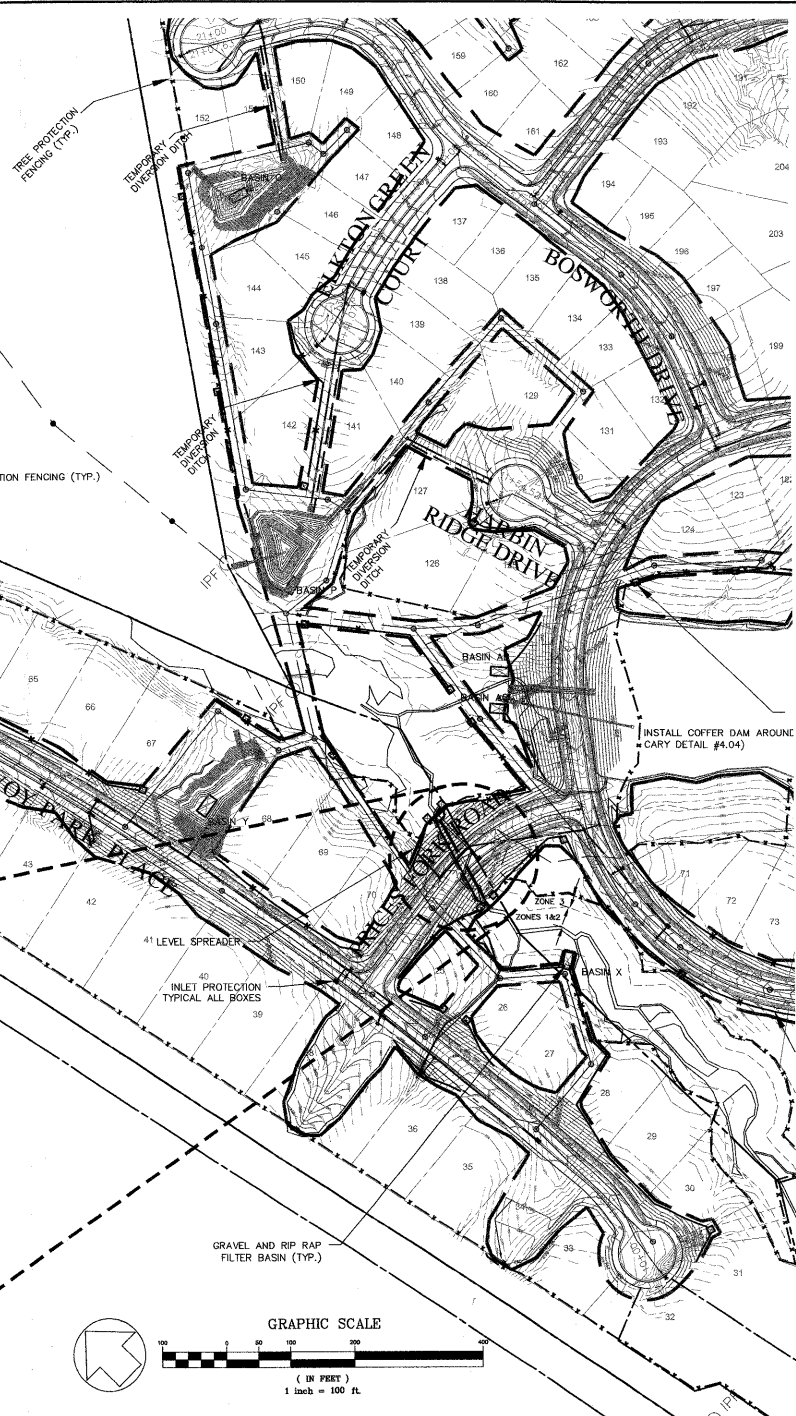
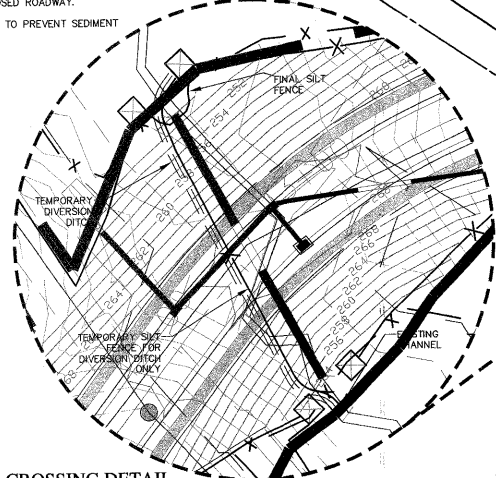
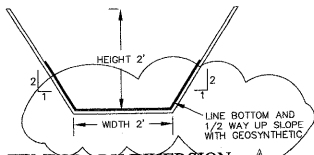

**CHAS. H. SELLS, INC.**  
 Consulting Engineers, Surveyors & Environmentalists  
 15300 Weston Parkway  
 Cary, NC 27513  
 Tel: 919-678-0035  
 Fax: 919-678-0206  
 www.chasheis.com

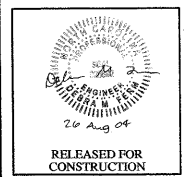

The Peninsula at Amberly  
 Yates Store Road - Cary, NC

REVISIONS

|         |                              |
|---------|------------------------------|
| 1/5/04  | REVISED PER TOC COMMENTS     |
| 2/23/04 | REVISED PER TOC COMMENTS     |
| 4/5/04  | REVISED PER TOC COMMENTS     |
| Δ       | REVISED - 05/17/04           |
| Δ       | 05/21/04 - ADDED TYP TO PLAN |

PROJECT #: 03423 DATE: 11/01/03  
 DRAWN BY: SLS CHECKED BY: JBS  
 TITLE: EROSION CONTROL PLAN  
 SHEET: C5.3

03-SB-012  
 APPROVED  
 TOWN OF CARY

Approved by: *DR* Date: 8-2-04  
 Planning: *ES* Date: 8-21-04  
 Engineering: *TS* Date: 8-30-04

© CHAS. SELLS, INC. ALL RIGHTS ARE RESERVED. ANY REPRODUCTION OR OTHER USE OF THIS DOCUMENT WITHOUT PRIOR PERMISSION FROM CHAS. H. SELLS, INC. IS EXPRESSLY PROHIBITED.

GS Carolina  
 11600 North Carolina Road, Suite 200  
 Charlotte, NC 28277