

EROSION CONTROL ACTIVITY SCHEDULE

ACTIVITY	1999				
	MONTH 1	MONTH 2	MONTH 3	MONTH 4	MONTH 5
START CONSTRUCTION					
INSTALLATION OF EROSION CONTROL DEVICES					
CLEARING & GRUBBING					
STORM SEWER SYSTEM INSTALLATION					
BUILDING CONSTRUCTION					
INSTALLATION OF UTILITIES					
PERMANENT VEGETATION STABILIZATION					
MAINTENANCE OF EROSION CONTROL DEVICES					
REMOVE EROSION CONTROL DEVICES					
END OF CONSTRUCTION					

CONSTRUCTION SEQUENCE ON PROJECTS SHALL BE AS FOLLOWS:

1. OBTAIN GRADING PERMIT;
2. INSTALL ALL EROSION CONTROL MEASURES AS SHOWN;
3. OBTAIN CERTIFICATE OF COMPLIANCE THROUGH ON-SITE INSPECTION BY TOWN ENVIRONMENTAL INSPECTOR;
4. PROCEED WITH GRADING;
5. CLEAN SEDIMENT BASINS WHEN ONE-HALF FULL;
6. SEED AND MULCH DENUDED AREA WITHIN THIRTY (30) DAYS AFTER FINISHED GRADES ARE ESTABLISHED;
7. MAINTAIN SOIL EROSION CONTROL MEASURES UNTIL PERMANENT GROUND COVER IS ESTABLISHED;
8. REQUEST FINAL APPROVAL BY TOWN ENVIRONMENTAL INSPECTOR;
9. REMOVE SOIL EROSION CONTROL MEASURES AND STABILIZE THESE AREAS.

EROSION CONTROL NOTES

1. SILT FENCE SHALL MEET ANY JURISDICTIONAL REQUIREMENTS.
2. ADDITIONAL EROSION CONTROL MEASURES WILL BE EMPLOYED WHERE DETERMINED NECESSARY BY ACTUAL SITE CONDITIONS.
3. TOTAL AREA OF SITE: 1.04 ACRES
TOTAL DISTURBED AREA: 0.79 ACRES
TOTAL EXISTING IMPERVIOUS AREA OF THE SITE: .69 ACRES
TOTAL PROPOSED IMPERVIOUS AREA OF SITE: .92 ACRES
TOTAL DENUDED AREA: THE SITE WAS PREVIOUSLY CLEARED.
4. SEDIMENT & EROSION CONTROL MEASURES SHALL BE PROVIDED ON ALL GRADED AND/OR DISTURBED AREAS UNTIL SUCH AREAS HAVE BEEN STABILIZED WITH VEGETATIVE COVER.
5. SEDIMENT & EROSION CONTROL MEASURES SHOWN ON THE DRAWINGS ARE CONSIDERED MINIMUM. THE CONTRACTOR IS RESPONSIBLE FOR PROVIDING CONTROL AS NECESSARY TO PREVENT EROSION RUNOFF.
6. IF FINES OR PENALTIES ARE LEVIED AGAINST THE PROPERTY OR PROPERTY OWNER BECAUSE OF LACK OF EROSION & SEDIMENTATION CONTROL, THE CONTRACTOR SHALL BE RESPONSIBLE FOR PAYMENT OF SUCH FINES OR PENALTIES OR THE COSTS OF ANY FINES OR PENALTIES SHALL BE DEDUCTED FROM THE CONTRACT AMOUNT.
7. ALL SEDIMENT CONTROL STRUCTURES ARE TO BE INSTALLED PRIOR TO ANY GRADING AND ARE TO BE MAINTAINED AND KEPT IN PLACE THROUGHOUT THE COURSE OF CONSTRUCTION.
8. PRIOR TO ANY OTHER CONSTRUCTION, A STABILIZED CONSTRUCTION ENTRANCE SHALL BE CONSTRUCTED AT EACH POINT OF ENTRY TO OR EXIT FROM THE SITE.
9. THE CONSTRUCTION EXIT SHALL BE MAINTAINED IN A CONDITION WHICH WILL PREVENT TRACKING OR FLOW OF MUD ONTO PUBLIC RIGHT-OF-WAY. THIS MAY REQUIRE PERIODIC TOP DRESSING WITH STONE, AS CONDITIONS DEMAND, AND REPAIR AND/OR CLEAN-OUT OF ANY STRUCTURES USED TO TRAP SEDIMENT. ALL MATERIALS SPILLED, DROPPED, WASHED, OR TRACKED FROM VEHICLE OR SITE ONTO PUBLIC ROADWAY OR INTO STORM DRAINS MUST BE REMOVED IMMEDIATELY, OR A WASH STATION WILL HAVE TO BE ADDED. STREETS IN FRONT OF THE PROJECT MUST BE KEPT CLEAN AT ALL TIMES.
10. PRIOR TO COMMENCING LAND DISTURBANCE ACTIVITY, THE LIMITS OF LAND DISTURBANCE SHALL BE CLEARLY AND ACCURATELY DEMARCATED WITH STAKES, RIBBONS, OR OTHER APPROPRIATE MEANS. THE LOCATION AND EXTENT OF ALL AUTHORIZED LAND DISTURBANCE ACTIVITY SHALL BE DEMARCATED FOR THE DURATION OF THE CONSTRUCTION ACTIVITY. NO LAND DISTURBANCE SHALL OCCUR OUTSIDE THE APPROVED PLANS.
11. IMMEDIATELY AFTER THE ESTABLISHMENT OF CONSTRUCTION ENTRANCES/EXITS, ALL PERIMETER EROSION CONTROL DEVICES AND STORMWATER MANAGEMENT DEVICES SHALL BE INSTALLED PRIOR TO ANY OTHER CONSTRUCTION.
12. OWNER AGREES TO PROVIDE AND MAINTAIN OFF-STREET PARKING ON THE SUBJECT PROPERTY DURING THE ENTIRE CONSTRUCTION PERIOD.
13. THE CONTRACTOR SHALL FURNISH AND MAINTAIN ALL NECESSARY BARRICADES WHILE ROADWAY FRONTAGE IMPROVEMENTS ARE BEING MADE.
14. A COPY OF THE APPROVED LAND DISTURBANCE PLAN AND PERMIT SHALL BE PRESENT ON THE SITE WHENEVER LAND DISTURBANCE ACTIVITY IS IN PROGRESS.
15. NO WETLANDS ARE KNOWN TO EXIST ON THIS SITE.
16. THE STREETS IN FRONT OF THE PROJECT WILL BE KEPT CLEAN AT ALL TIMES OR A WASH STATION WILL BE REQUIRED.
17. THIS PROJECT MAY REQUIRE A PRE-CONSTRUCTION CONFERENCE BEFORE THE GRADING PERMIT IS ISSUED.
18. FOR COMPLETE SEEDING SCHEDULE PLEASE REFER TO SHEET C-8.
19. CUT & FILL SLOPES WILL BE STABILIZED WITHIN 30 DAYS OF ANY PHASE OF GRADING.
20. THIS SITE IS NOT LOCATED IN FLOOD PLAIN. THE PANEL NUMBER OF THE FIRM MAP IS 371_83C0506E.
21. THE SITE IS LOCATED WITHIN THE NEUSE RIVER BASIN WATERSHED.

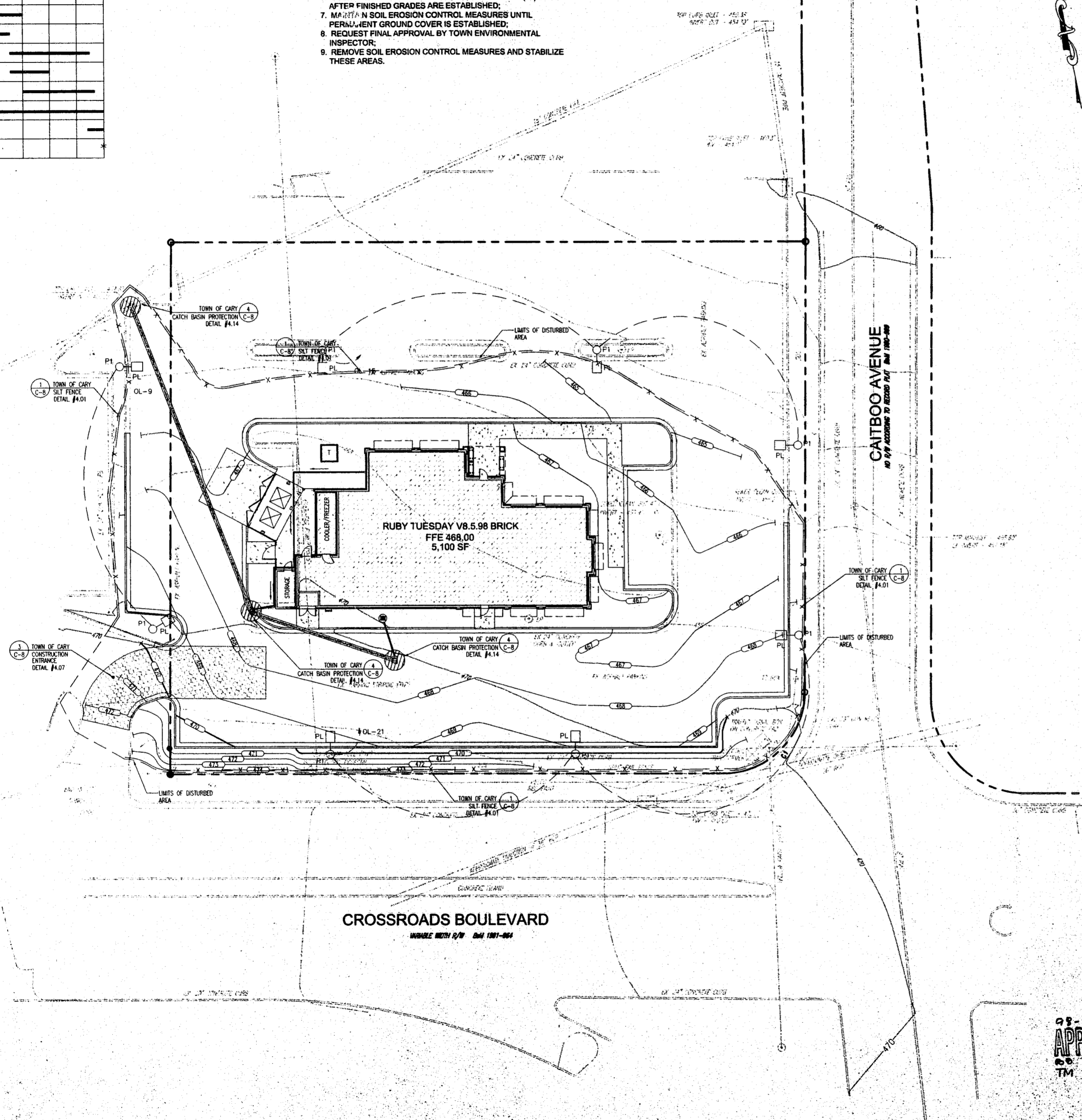

EROSION CONTROL LEGEND

	CONSTRUCTION EXIT
	SEDIMENT BARRIER/SILT FENCE
	INLET SEDIMENT TRAP
	STORM DRAIN OUTLET PROTECTION
	DISTURBED AREA STABILIZATION (WITH TEMPORARY SEEDING)
	DISTURBED AREA STABILIZATION (WITH PERMANENT VEGETATION)

98-EP-205
APPROVED
08-26-99
TM 4-16-99

SITE DEVELOPMENT PLANS FOR
RUBY TUESDAY RESTAURANT
103 CROSSROADS BOULEVARD
CROSSROADS PLAZA
CARY, NORTH CAROLINA

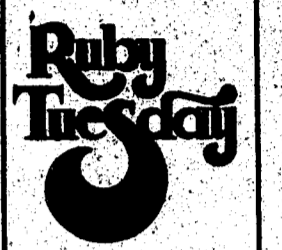

PLANS PREPARED FOR
RUBY TUESDAY, INC.
4721 MORRISON DRIVE
MOBILE, ALABAMA 36625
(334) 344-3000

RBA
ENGINEERS-ARCHITECTS-PLANNERS
One William H. Rouse II Building
1650 Peachtree Street
Atlanta, Georgia 30309
Phone (404) 881-4500 Fax (404) 881-4501

REVISIONS

NO.	DATE	DESCRIPTION

GRAPHIC SCALE 1"=20'

DATE: 04/05/99
JOB NUMBER: 0204.01
FILE NUMBER: 2004 SHEET 07
PLOTTED: 04/05/99

SEDIMENT & EROSION CONTROL PLAN
SHEET **C-7**