

LOT 12
 TOTAL
 AREA=23.213 ACRES
 1,011,207 SQ. FEET
 PIPE & UTILITY EASEMENT
 AREA=0.950 ACRES
 41,385 SQ. FEET
 PRIVATE SHARED ACCESS EASEMENT
 AREA=0.229 ACRES
 9,984 SQ. FEET

LOT 11
 TOTAL
 AREA=12.852 ACRES
 559,827 SQ. FEET
 PRIVATE SHARED ACCESS EASEMENT
 AREA=0.398 ACRES
 17,343 SQ. FEET
 PIPE & UTILITY EASEMENT
 AREA=0.204 ACRES
 8,871 SQ. FEET
 STORM WATER MAINTENANCE EASEMENT
 AREA=1.205 ACRES
 52,484 SQ. FEET
 MAINTENANCE & ACCESS EASEMENT
 AREA=0.164 ACRES
 7,128 SQ. FEET

LOT 12
 TOTAL
 AREA=23.213 ACRES
 1,011,207 SQ. FEET
 PIPE & UTILITY EASEMENT
 AREA=0.950 ACRES
 41,385 SQ. FEET
 PRIVATE SHARED ACCESS EASEMENT
 AREA=0.229 ACRES
 9,984 SQ. FEET

I, JOHN H. CHANDLER, PLS L-4389, CERTIFY THAT THIS PLAT WAS DRAWN UNDER MY SUPERVISION FROM AN ACTUAL SURVEY MADE UNDER MY SUPERVISION FROM INFORMATION SHOWN IN DEED BOOKS REFERENCED ON MAP AND MAP BOOKS REFERENCED ON MAP; THAT ANY LINES NOT ACTUALLY SURVEYED APPEAR AS BROKEN LINES AND WERE PLOTTED FROM INFORMATION AS NOTED ON THE PLAT; THAT THE RATIO OF PRECISION AS CALCULATED IS BETTER THAN 1:10,000; THAT THE AREA IS COMPUTED BY COORDINATE METHOD; THAT THIS PLAT WAS PREPARED IN ACCORDANCE WITH G.S. 47-30 AS AMENDED. WITNESS MY ORIGINAL SIGNATURE, REGISTRATION NUMBER, AND SEAL THIS THE ____ DAY OF _____ A.D., 2007.

JOHN H. CHANDLER L-4389
 PROFESSIONAL LAND SURVEYOR

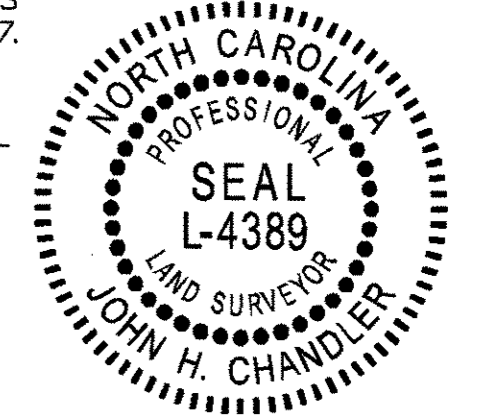

DATE	REVISION	INITIAL

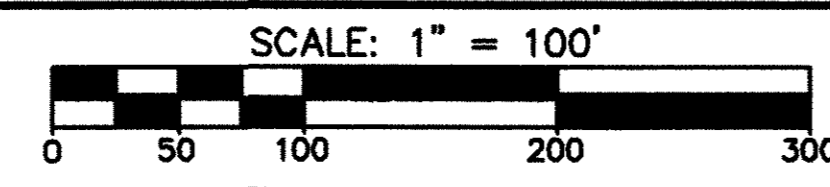

The chandler GROUP
 7621 Purfoy Road, Suite 201
 Fuquay-Varina, NC 27526
 P: 919.552.4845
 F: 919.552.6962
 3206 Heritage Trade Dr., Ste 108B
 Wake Forest, NC 27587
 P: 910.278.9415
 F: 910.278.9060
 www.tcgp.com

EASEMENT PLAT
 OF
SHILOH CROSSING
 DATE: JANUARY 7, 2007
 CEDAR FORK TOWNSHIP
 WAKE COUNTY
 SCALE: 1" = 100'
 NORTH CAROLINA

PROJECT #: 05-1012
 PROJ. SVYR: JHC
 DRAWN BY: BSP
 COMP. FILE: 05-1012-easement
 SHEET #: 5 OF 5
 DWG. #: C-6D