

January 07, 2008 - 3:23pm By: Gene Brunson

LOT NUM	DURHAM CITY PIN #
1	0747-03-40-6845
14	0747-04-50-3843
15	0747-04-70-7899

Kimley-Horn and Associates, Inc.
 4651 CHARLOTTE PARK DRIVE
 SUITE 302
 CHARLOTTE, NORTH CAROLINA 28217
 PHONE: (704) 333-8844
 FAX: (704) 333-0845
 © 2007

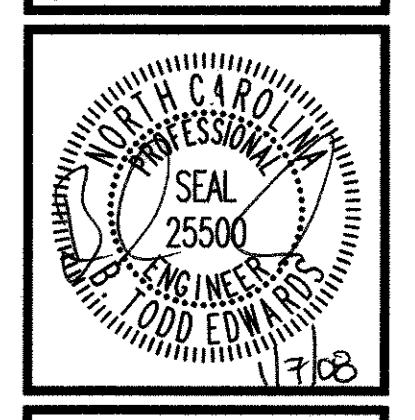

FINAL SET
FOR CONSTRUCTION

NO.	DATE	REVISIONS
1	1/15/07	1ST PLAN REVIEW
2	1/17/07	2ND PLAN REVIEW
3	10/17/07	3RD PLAN REVIEW
4	11/30/07	4TH PLAN REVIEW
5	1/07/08	5TH PLAN REVIEW

WAL-MART STORES, INC.
 SAM WALTON DEVELOPMENT COMPLEX
 2001 SE 10TH STREET
 BENTONVILLE, ARKANSAS 72716-0550
 TEL: (479) 273-4000

WAL-MART - MORRISVILLE
 STORE NO. 4250-00
 C-195-GL-NO
 NC HWY 54 AND SURLERS COURT
 MORRISVILLE, WAKE COUNTY
 NORTH CAROLINA

PROJECT: **SLATER & SERVICE ROADS ROADWAY IMPROVEMENTS**

DESIGNED BY: MOS
 DRAWN BY: MOS
 CHECKED BY: BTE
 DATE: 12-22-06
 PROJECT#: 015476039
R2

NOTES:

- ALL CONSTRUCTION SHALL BE PER NCDOT AND THE CITY OF DURHAM STANDARDS, SPECIFICATIONS AND DETAILS.
- ALL DIMENSIONS ARE TO THE EDGE OF PAVEMENT & PROPOSED WIDENING CENTERLINE UNLESS OTHERWISE NOTED.
- CONTRACTOR SHALL RELOCATE AND/OR ADJUST ALL UTILITIES THAT CONFLICT WITH THE PROPOSED ROAD IMPROVEMENTS. EASEMENTS WILL BE REQUIRED AND SHOWN ON PLAN SHEETS WHEN WARRANTED.
- CONTRACTOR SHALL REMOVE, STOCKPILE, AND RESET ANY NCDOT SIGNAGE ALONG SLATER ROAD AND THE NCDOT SERVICE ROAD.
- THE LOCATION AND SIZE OF EXISTING UTILITIES AS SHOWN IS APPROXIMATE ONLY. THE CONTRACTOR IS RESPONSIBLE FOR HORIZONTALLY AND VERTICALLY LOCATING AND PROTECTING ALL PUBLIC OR PRIVATE UTILITIES (SHOWN OR NOT SHOWN) WHICH LIE IN OR ADJACENT TO THE CONSTRUCTION SITE. AT LEAST 48 HOURS PRIOR TO ANY DEMOLITION, GRADING, OR CONSTRUCTION ACTIVITY, THE CONTRACTOR SHALL NOTIFY THE NORTH CAROLINA ONE-CALL UTILITIES LOCATION SERVICE (ULOCO) AT 1-800-632-4949 FOR PROPER IDENTIFICATION OF EXISTING UTILITIES WITHIN THE SITE.
- REFER TO STORM DRAINAGE SHEETS FOR ALL DRAINAGE DESIGN INFORMATION.
- CONTRACTOR SHALL MILL ACROSS EXISTING ROADWAY TO PROVIDE A MINIMUM 1.5" OVERLAY AT THE LIMITS OF CONSTRUCTION TO PROVIDE A SMOOTH TIE-IN TO EXISTING PAVEMENT.

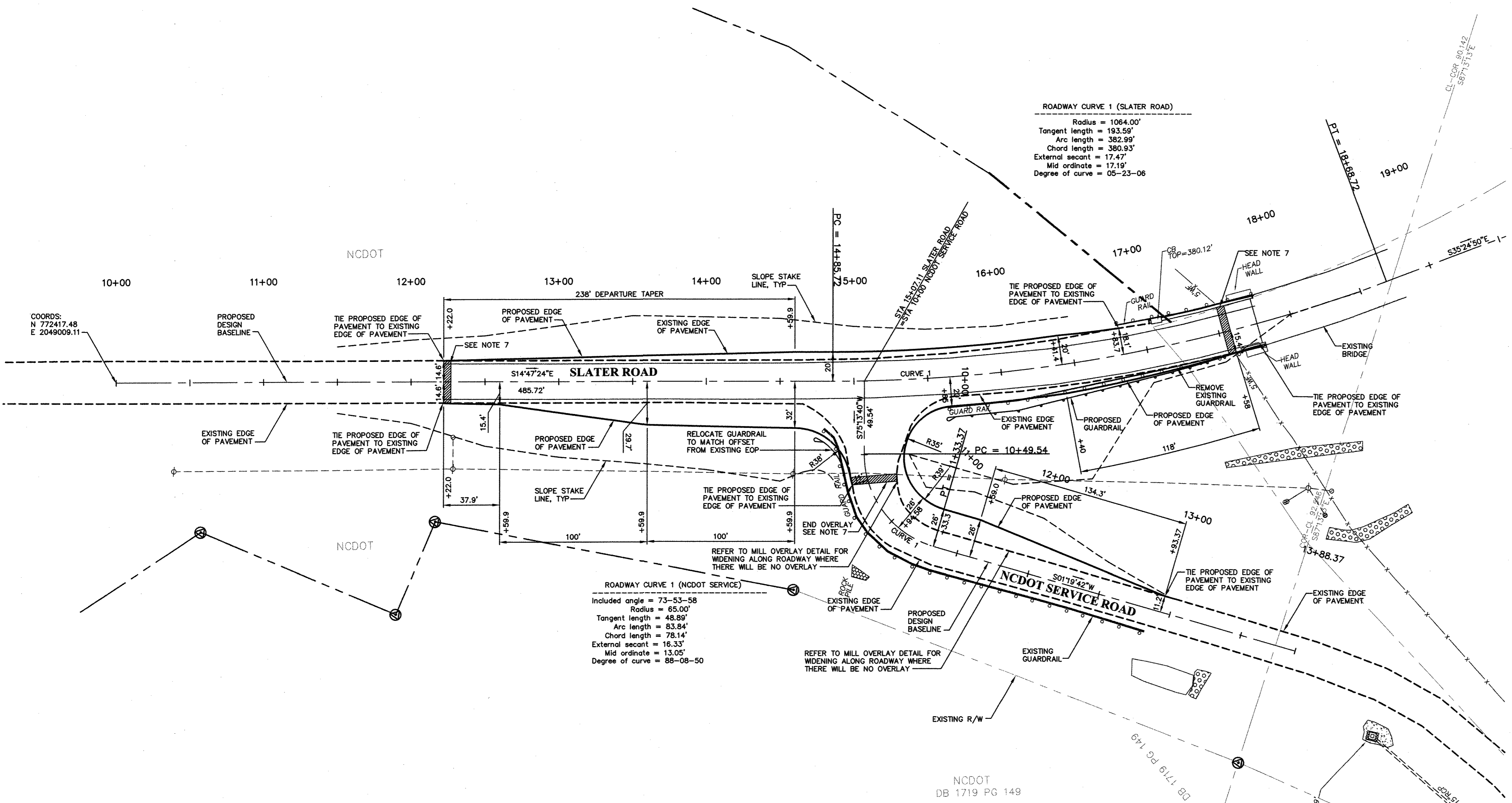

ROADWAY CURVE 1 (SLATER ROAD)
 Radius = 1064.00'
 Tangent length = 193.59'
 Arc length = 382.99'
 Chord length = 380.93'
 External secant = 17.47'
 Mid ordinate = 17.19'
 Degree of curve = 05-23-06

ROADWAY CURVE 1 (NCDOT SERVICE)
 Included angle = 73-53-58
 Radius = 65.00'
 Tangent length = 48.89'
 Arc length = 83.84'
 Chord length = 78.14'
 External secant = 16.33'
 Mid ordinate = 13.05'
 Degree of curve = 88-08-50

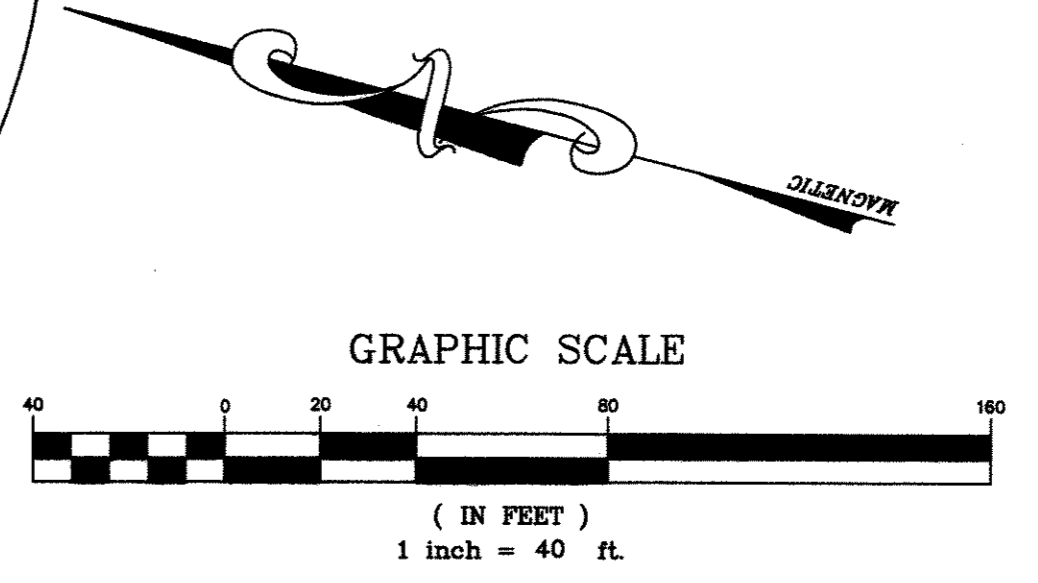
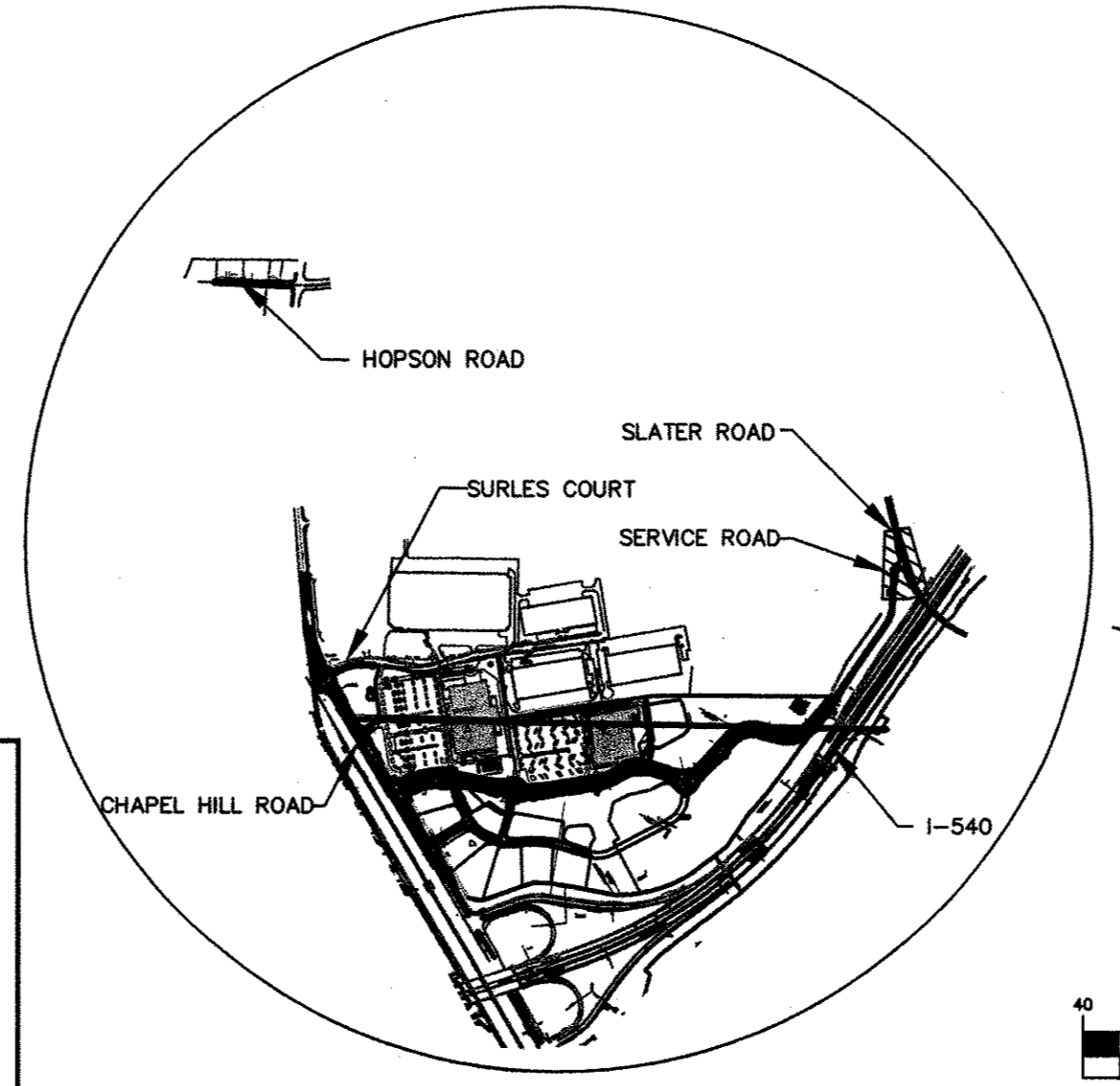

GROUNDWATER NOTE
 THE PRESENCE OF GROUNDWATER SHOULD BE ANTICIPATED ON THIS PROJECT. CONTRACTOR'S BID SHALL INCLUDE CONSIDERATION FOR ADDRESSING THIS ITEM.

Construction Requirements
 All public and private work including but not limited to watermain, water services, sanitary sewers, sanitary sewer services, storm sewers, drainage systems, roads, sidewalks, parking lots, site grading and landscaping shall be constructed in accordance with the Town of Morrisville and the Town of Cary Ordinances, Standards, Specifications, and Details that are applicable. No deviations from the Owner/Developer's Submittal plans will be allowed unless written approval from the Town of Morrisville is received, along with permission from the Town of Cary for water and sanitary sewer deviations. All Public and Private Easements shall be recorded prior to final acceptance by the Town.

Review Disclaimer
 Should the Town of Morrisville or Town of Cary fail to identify, that the Owner/Developer has not addressed the comments made by either Town, or that the Plans and Specifications are not in compliance with the respective town Ordinances, Standards, Specifications, and Details whether from lack of discovery or for any other reason it shall in no way relieve the Owner/Developer of their obligation thereof, nor obligate the Town of Morrisville or the Town of Cary to correct such errors or omissions. Execution of this construction plan by the Review Engineer or Planner for either Town in no way limits the responsibility of the Owner and Engineer of Record with regard to compliance with all Federal, State, and local standards, regulations and/or conditions.

Engineer/Inspector Disclaimer
 The presence of the Town of Morrisville or Town of Cary Engineer or Inspector at the work site shall in no way lessen the Owner's responsibility for conformity with the plans and specifications. Should the Engineer or Inspector prior to, during, or after construction fail to identify or reject materials or work that does not conform with the plans and specifications, whether from lack of discovery or for any other reason, it shall in no way prevent later rejection and correction of the unsatisfactory materials or work when discovered. This is also true if the work has been accepted and is currently being maintained by the Town of Morrisville or Town of Cary. The Owner shall be responsible for the correction of all work that does not conform to the plans and specifications.

Town of Morrisville Engineering & Planning Fees Paid

Infrastructure Fees	Yes	No	Comments
	X		

Town of Morrisville Released for Construction
Jenna Meyer
 (signature required)
 2/26/08
 Date

Morrisville Project Town of Cary Utility Approval
 Water And Sanitary Sewer System
 On April 3, 2008 the ownership, construction, operation, maintenance, management, and financing of the Town of Morrisville's water and sanitary sewer system within the present and future corporate limits and Urban Service Area limits of the Town of Morrisville was transferred by the Town of Cary as per the merger agreement between these two Towns. All water and sanitary sewer system design and construction shall be in accordance with the Town of Cary, Standard, Specifications, and the Standard Construction Detail Drawings.

Approved by the Town of Cary
 Engineering Date

Owner Certification
 The Owner/Developer hereby certifies that all Town comments have been incorporated into the Drawings and Specifications, the Drawings are in compliance with all Federal, State, Local Standards, and Town of Morrisville and Town of Cary Ordinances and Standards, specifications, and Details and the Owner has checked the plans to confirm that there are no errors or omissions. The Owner/Developer hereby certifies and agrees to take such action as may be required by the Town of Morrisville and Town of Cary to correct any errors, omissions or non-compliance with Town of Morrisville and Town of Cary Ordinances, Standards, Specifications, and Details and/or non-execution of this construction plan with the appropriate corrections and/or revisions.

JAN 1 0 2008
 Date
Alban
 Owner

TOWN OF MORRISVILLE PROJECT No. 06-80000041