

LOT NUM.	DURHAM CTY PIN #
1	0747-03-40-6845
14	0747-04-50-3843
15	0747-04-70-7699

**Kimley-Horn and Associates, Inc.**  
 4851 CHARLOTTE PARK DRIVE  
 SUITE 300  
 CHARLOTTE, NORTH CAROLINA 28217  
 PHONE: (704) 333-0191  
 FAX: (704) 333-0845  
 © 2007

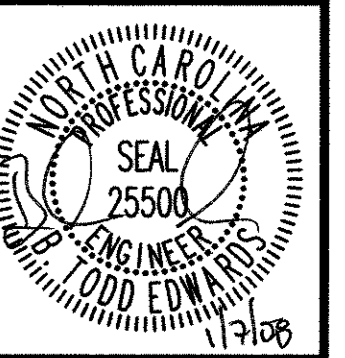

**PERMIT SET**  
 NOT FOR CONSTRUCTION

NO.	DATE	REVISIONS
4	11/20/07	4TH PLAN REVIEW
3	10/17/07	3RD PLAN REVIEW
2	7/20/07	2ND PLAN REVIEW
1	1/19/07	1ST PLAN REVIEW

**WAL-MART STORES, INC.**  
 SAM WALTON DEVELOPMENT COMPLEX  
 2001 SE 10TH STREET  
 BENTONVILLE, ARKANSAS 72716-0650  
 TEL: (479) 273-4000

**WAL-MART - MORRISVILLE**  
 STORE NO. 4250-00  
 C-185-GJ-NO  
 NC HWY 54 AND SURLIS COURT  
 MORRISVILLE, WAKE COUNTY  
 NORTH CAROLINA

**NCDOT SERVICE ROAD CROSS SECTIONS**

DESIGNED BY: MOS  
 DRAWN BY: MOS  
 CHECKED BY: BTE  
 DATE: 12-22-06  
 PROJECT#: 015476039  
**XS3**

TOWN OF MORRISVILLE PROJECT No. 06-80000041

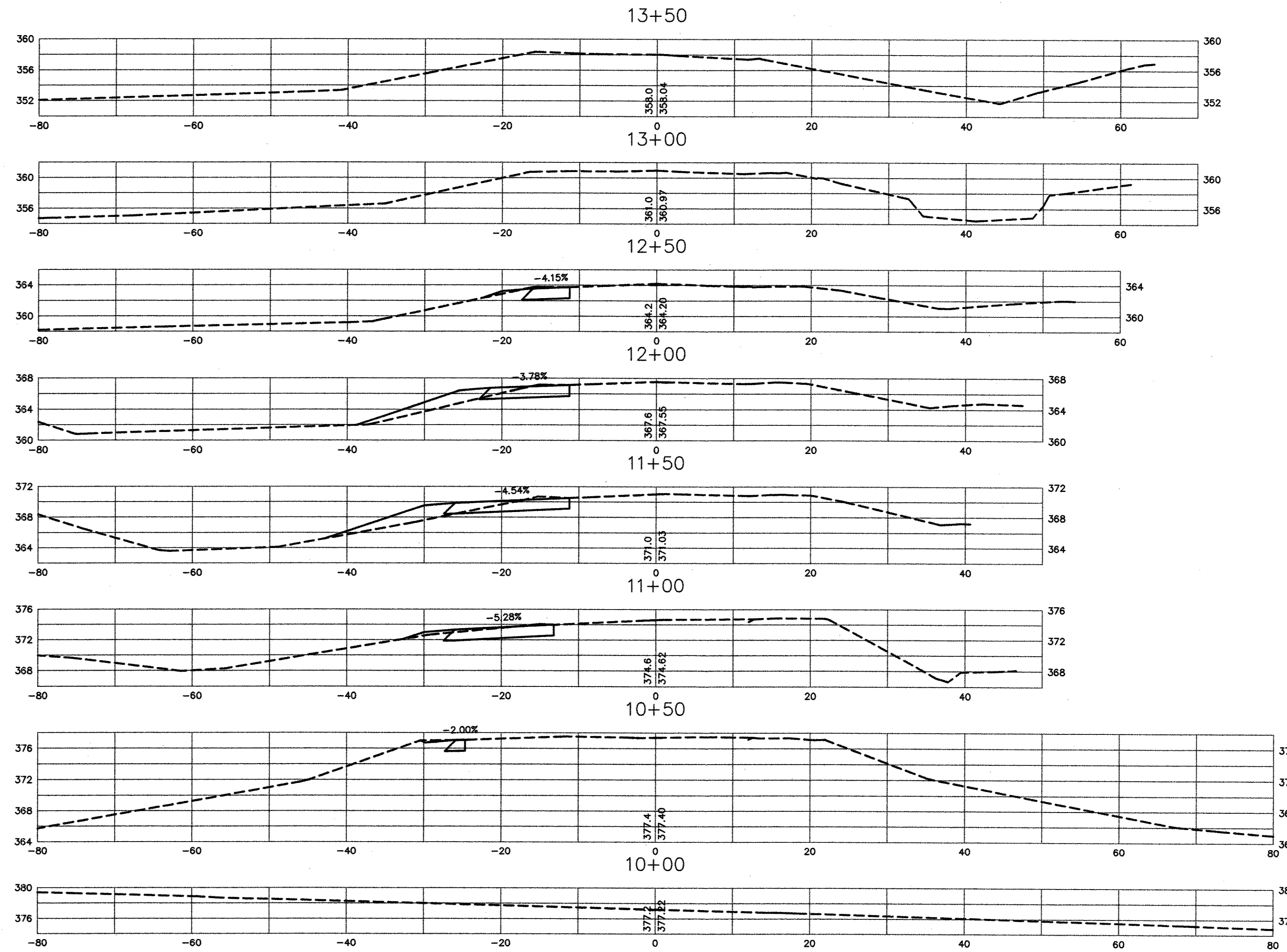

**SCALE:**  
 1"=10' HORIZ  
 1"=10' VERT



**GROUNDWATER NOTE**  
 THE PRESENCE OF GROUNDWATER SHOULD BE ANTICIPATED ON THIS PROJECT. CONTRACTOR'S BID SHALL INCLUDE CONSIDERATION FOR ADDRESSING THIS ITEM.

K:\PAL\_DEV\02211010 Shih\_Crossing\_CSA\CA\02211010-SECC3.dwg

**Construction Requirements**  
 All public and private work, including but not limited to watermain, water services, sanitary sewers, sanitary sewer services, storm sewers, drainage systems, roads, sidewalks, parking lots, site grading and landscaping shall be constructed in accordance with the Town of Morrisville and the Town of Cary Ordinances, Standards, Specifications, and Details that are applicable. No deviations from the Owner/Developer's Submittal phase will be allowed unless written approval from the Town of Morrisville or the Town of Cary is received. Execution of this construction plan by the Review Engineer or Planner for the Town of Morrisville or the Town of Cary shall be subject to the approval of the Engineer of Record with regard to compliance with all Federal, State, and local standards, regulations and/or conditions.

**Review Disclaimer**  
 Should the Town of Morrisville or Town of Cary fail to identify, that the Owner/Developer has not addressed the comments made by either Town, or that the Plans and Specifications are not in compliance with respective town Ordinances, Standards, Specifications, and Details whether from lack of discovery or for any other reason it shall in no way relieve the Owner/Developer of their obligation thereof, nor obligate the Town of Morrisville or the Town of Cary to correct such errors or omissions. Execution of this construction plan by the Review Engineer or Planner for the Town of Morrisville or the Town of Cary shall be subject to the approval of the Engineer of Record with regard to compliance with all Federal, State, and local standards, regulations and/or conditions.

**Engineer/Inspector Disclaimer**  
 The presence of the Town of Morrisville or Town of Cary Engineer or Inspector at the work site shall in no way lessen the Owner's responsibility for conformity with the plans and specifications. Should the Engineer or Inspector prior to, during, or after construction fail to identify or reject materials or work that does not conform with the plans and specifications, whether from lack of discovery or for any other reason, it shall in no way prevent later rejection and correction of the unsatisfactory materials or work when discovered. This is also true if the work has been accepted and is currently being maintained by the Town of Morrisville or Town of Cary. The Owner shall be responsible for correction of all work that does not conform to the plans and specifications.

**Town of Morrisville Engineering & Planning Fees Paid**

Infrastructure Fees	Yes	No	Comments
	X		

**Town of Morrisville Released for Construction**  
*James May*  
 (signature required)  
 2/24/08  
 Date

**Morrisville Project Town of Cary Utility Approval**  
 Water And Sanitary Sewer System  
 On April 3, 2008 the ownership, construction, operation, maintenance, management, and financing of the Town of Morrisville's water and sanitary sewer systems within the present and future corporate limits and Urban Service Area limits of the Town of Morrisville was transferred to the Town of Cary as per the merger agreement between these two Towns. All water and sanitary sewer system design and construction shall be in accordance with the Town of Cary, Standard, Specifications, and the Standard Construction Detail Drawings

Approved by the Town of Cary  
 Engineering \_\_\_\_\_ Date \_\_\_\_\_

**Owner Certification**  
 The Owner/Developer hereby certifies that all Town comments have been incorporated into the Drawings and Specifications, the Drawings are in compliance with all Federal, State, Local Ordinances and Standards, specifications, and Details and the Owner has checked the plans to confirm that there are no errors or omissions. The Owner/Developer hereby certifies and agrees to take such action as may be required by the Town of Morrisville and Town of Cary to correct any errors, omissions or non-compliance with Town of Morrisville and Town of Cary Ordinances, Standards, Specifications, and Details and/or re-execution of this construction plan with the appropriate corrections and/or revisions.

*J.P. Edwards*  
 JAN 10 2008  
 Owner Date