

**Reynolds  
 & Jewell**

Landscape Architecture  
 Land Planning

Suite 201  
 128 East Hargett Street  
 Raleigh NC 27601

(919) 821-5074  
 fax (919) 821-5139

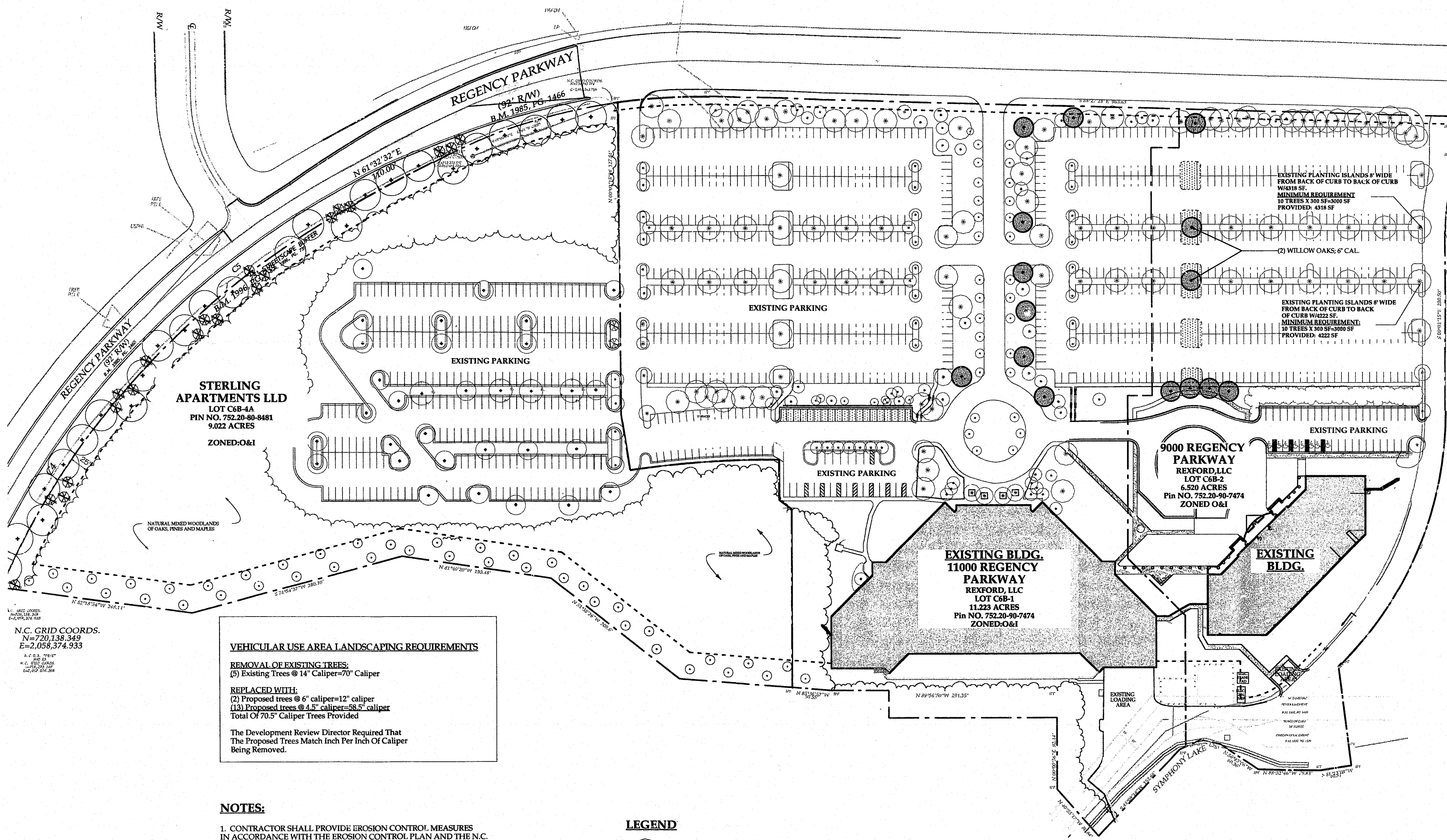
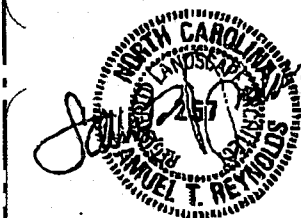

**STERLING APARTMENTS LLD**  
 LOT C6B-4A  
 PIN NO. 752.20-80-8481  
 9.022 ACRES  
 ZONED-O&I

**9000 REGENCY PARKWAY REXFORD, LLC**  
 LOT C6B-2  
 6.520 ACRES  
 Pin NO. 752.20-90-7474  
 ZONED O&I

**EXISTING BLDG. 11000 REGENCY PARKWAY REXFORD, LLC**  
 LOT C6B-1  
 11.223 ACRES  
 Pin NO. 752.20-90-7474  
 ZONED-O&I

**EXISTING BLDG.**

**VEHICULAR USE AREA LANDSCAPING REQUIREMENTS**

**REMOVAL OF EXISTING TREES:**  
 (5) Existing Trees @ 14" Caliper=70" Caliper

**REPLACED WITH:**  
 (2) Proposed trees @ 6" caliper=12" caliper  
 (13) Proposed trees @ 4.5" caliper=58.5" caliper  
 Total Of 70.5" Caliper Trees Provided

The Development Review Director Required That The Proposed Trees Match Inch Per Inch Of Caliper Being Removed.

- NOTES:**
- CONTRACTOR SHALL PROVIDE EROSION CONTROL MEASURES IN ACCORDANCE WITH THE EROSION CONTROL PLAN AND THE N.C. EROSION AND SEDIMENT CONTROL PLANNING AND DESIGN MANUAL.
  - NO CHANGES TO ANY ASPECT OF THIS SITE PLAN, INCLUDING BUT NOT LIMITED TO, LANDSCAPING, GRADING, BUILDING ELEVATIONS (ESPECIALLY COLORS), LIGHTING, OR UTILITIES WILL BE MADE WITHOUT THE APPROVAL OF THE DEVELOPMENT REVIEW GROUP OF THE DEPARTMENT OF DEVELOPMENT SERVICES.
  - THE SITE SHALL BE STABILIZED AND SEEDED PRIOR TO THE ISSUANCE OF A CERTIFICATE OF OCCUPANCY.
  - THE OWNER RESERVES THE RIGHT TO SUBSTITUTE PLANT MATERIAL PROVIDING THAT ALL LANDSCAPE REQUIREMENTS PER THE TOWN OF CARY ARE SATISFIED. ANY PLANT SUBSTITUTION SHALL BE THE MINIMUM SIZE AND SPECIES IN ACCORDANCE WITH THE TOWN OF CARY UNIFIED DEVELOPMENT ORDINANCE.

- LEGEND**
- \*(\*) EXISTING TREES TO REMAIN
  - (●) PROPOSED TREES

**PLANT LIST**

QTY	BOTANICAL NAME	COMMON NAME	CALIPER	HEIGHT	ROOT
2	Quercus phellos	Willow Oak	6"	18'-20'	B & B
13	Quercus phellos	Willow Oak	4.5"	16'-18'	B & B

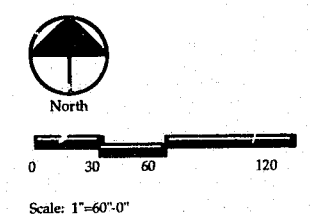

Revisions:  
 1/2/01 - 2nd Submittal

Project:  
**Regency Park - Additional Parking**  
 Cary, North Carolina

Client:  
**Grubb Management, Inc.**

Date:  
**November 20, 2000**

Scale:  
**1"=60'-0"**

Drawing Title:  
**OVERALL PLANTING PLAN**

Sheet No.:

**L-3**