

K:\13-080\13080-1\Drawings\13-SECTION\13-SECTION.dwg - Wednesday, April 16, 2014 4:03:32 PM - TALLETT, BOSS

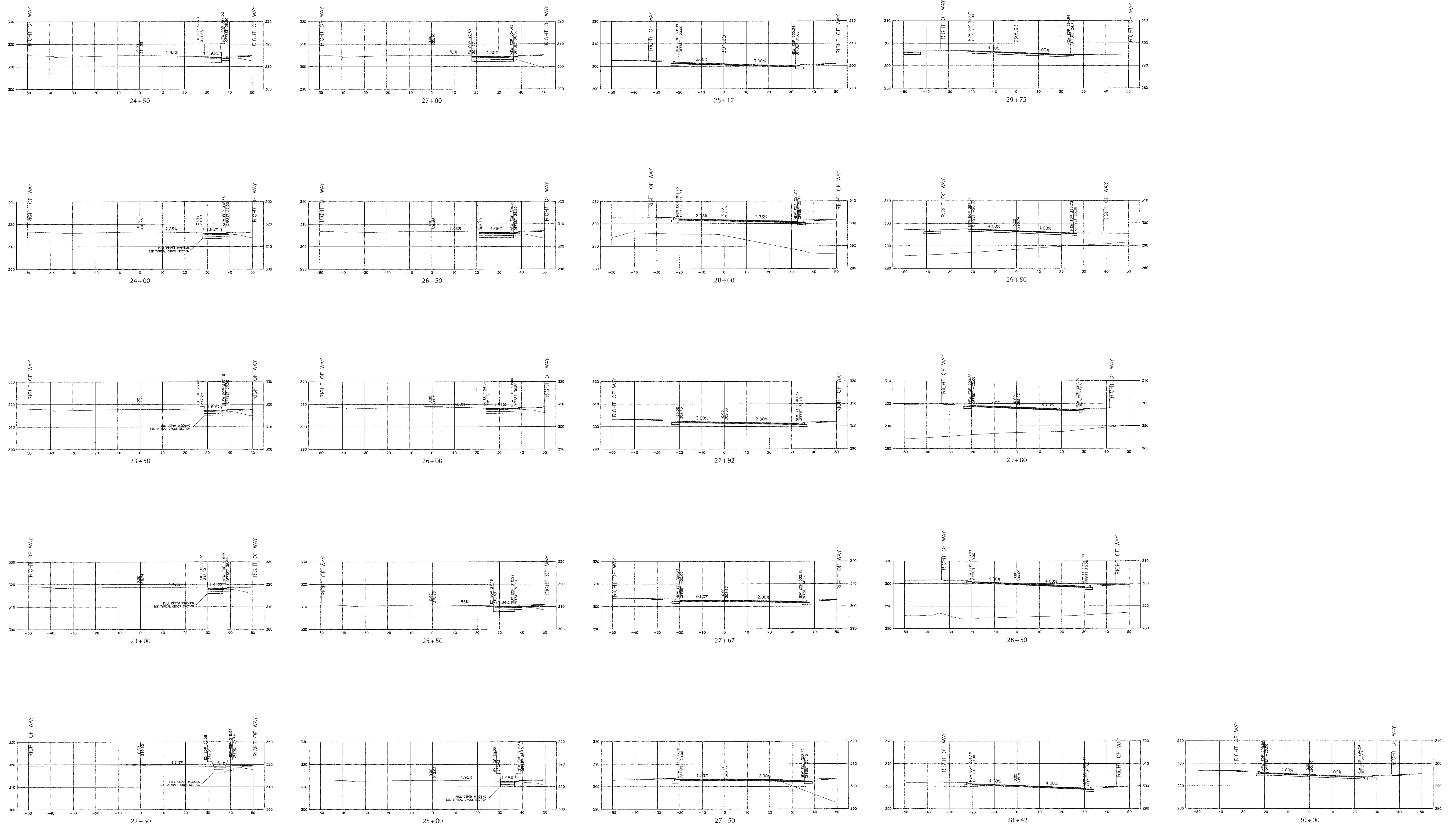

| No. | Revision                      | Date     | By  |
|-----|-------------------------------|----------|-----|
| 6   | AS PER TOC REVIEW, MASTER SET | 04/16/14 | KLJ |

| No. | Revision                            | Date     | By  |
|-----|-------------------------------------|----------|-----|
| 1   | AS PER TOC REVIEW COMMENTS          | 09/29/13 | KLJ |
| 2   | REVISED PER TOC 2ND REVIEW COMMENTS | 11/26/13 | KLJ |
| 3   | REVISED PER TOC 3RD REVIEW COMMENTS | 01/11/14 | KLJ |
| 4   | REVISED PER TOC 4TH REVIEW COMMENTS | 02/14/14 | KLJ |
| 5   | REVISED PER TOC 5TH REVIEW COMMENTS | 03/10/14 | KLJ |

|            |     |         |             |
|------------|-----|---------|-------------|
| Designer   | KJ  | Scale   | AS NOTED    |
| Drawn By   | ATC | Date    | 7/11/13     |
| Checked By | KJ  | Job No. | 02130084.00 |

**VILLAGE AT THE PARK**  
 Town of Cary      Wake County      North Carolina

**KIT CREEK RD. CROSS SECTIONS**

**WITHERS & RAVENEL**  
ENGINEERS | PLANNERS | SURVEYORS

111 MacKenzie Drive, Cary, North Carolina 27511 | tel: 919-469-3340 | www.wITHERSRAVENEL.COM | License No. C-0832

Cary Project Number 13-58-013  
HTE #: 14-0152

**Approved by the Town of Cary**  
Development Review Committee

Planner *K. Kelly*      Date *5/16/14*

Sheet No.  
**13.3**