

Layout Tab Name: C300 GRADING AND DRAINAGE PLAN, Images: Morrisville aerial new.jpg, Xrefs: 075356-X.dwg; 075356-P.dwg; 075356-TBLK.dwg; 075356-G.dwg; 075356-Buildings.dwg  
 Last Saved By: lzdznzski, 12/19/2017 12:41:26 PM  
 G:\DE\Clients\WaterWalk\075356 Morrisville, NC\4.0 Disciplines\Civil\Cadd\C300-GR.dwg Plotted By: lzdznzski, Jake Plotted: January 17, 2018, 2:49:01 PM

**BENCHMARK:**  
 THE BASIS OF ELEVATIONS HEREON IS NAVD 88.  
 IRON ROD SET - SEE THE VICINITY MAP FOR LOCATION  
 ELEVATION = 370.82' (371.51' NGVD29)

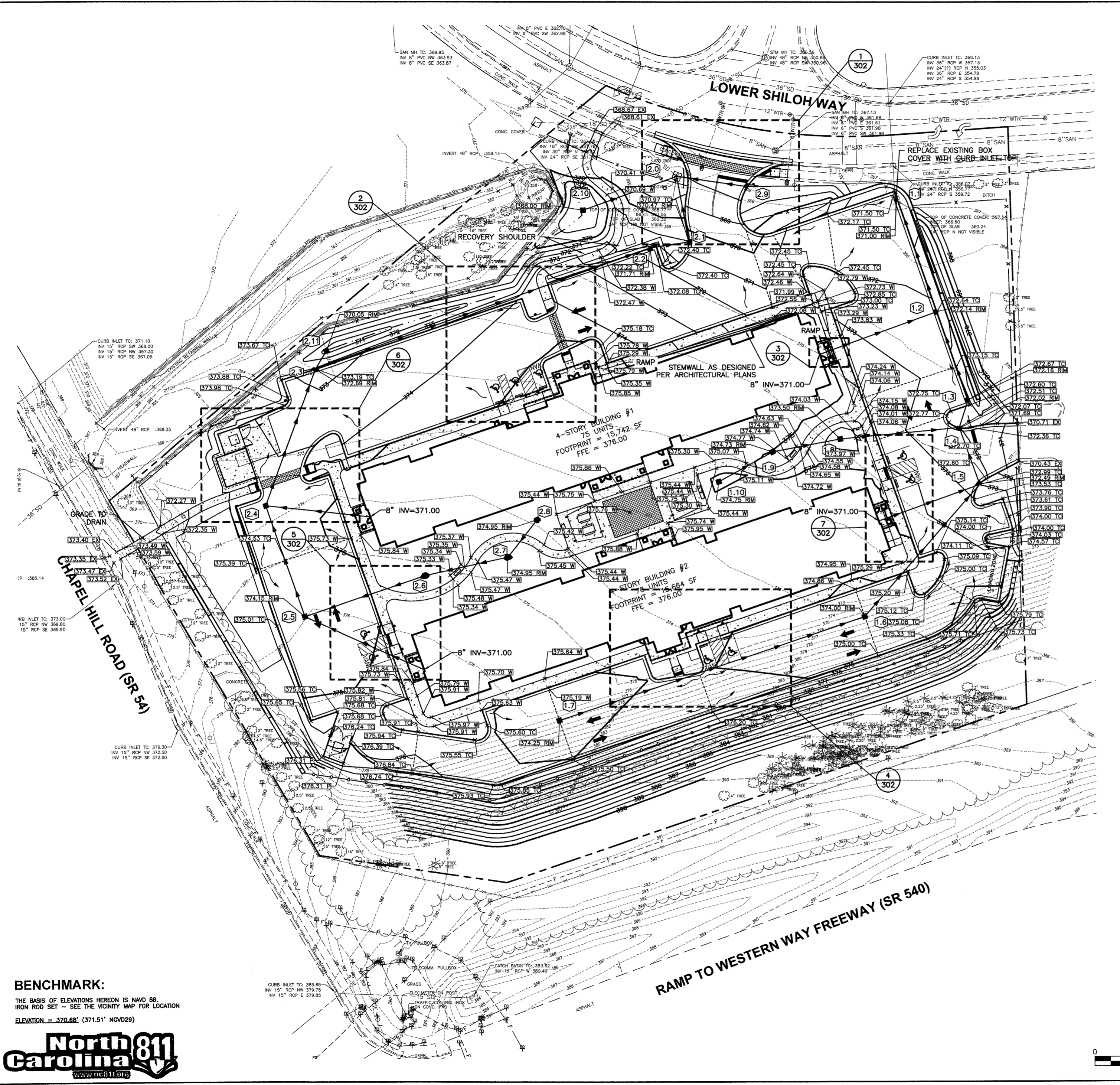

**GRADING LEGEND**

- EXISTING BOUNDARY
- - - PROPOSED BOUNDARY
- - - EXISTING 1' CONTOUR
- - - EXISTING 5' CONTOUR
- - - PROPOSED 1' CONTOUR
- - - PROPOSED 5' CONTOUR
- - - PROPOSED STORM DRAIN
- - - CENTERLINE DRAINAGE SWALE
- - - PAVEMENT GRADE BREAK

- DIRECTION OF FLOW
- X ELEVATION AT TOP OF CURB
- X ELEVATION AT TOP OF PAVEMENT
- X ELEVATION AT GRADE
- X ELEVATION AT TOP OF WALK
- X ELEVATION AT TOP OF CURB
- X ELEVATION TO MATCH EXISTING GRADE
- PROPOSED CATCH BASIN
- PROPOSED CURB INLET
- PROPOSED STORM MANHOLE
- PROPOSED CLEANOUT
- POSITIVE SLOPED CURB
- NEGATIVE SLOPED CURB
- 1.3 PROPOSED STORM STRUCTURE CALLOUT
- 1.3 PROPOSED DETAIL CALLOUT

**GRADING AND DRAINAGE NOTES**

1. ALL CONCRETE CATCH BASINS SHALL BE CONSTRUCTED IN ACCORDANCE WITH NCDOT STANDARD DRAWING NO. 840.02 & 840.03. CONTRACTOR MAY ELECT TO USE A 48" DIA. WITH TOP SLAB FOR STRUCTURES 1.2, 1.3, 2.1, AND 2.13.
2. ALL CONCRETE DROP INLETS SHALL BE CONSTRUCTED IN ACCORDANCE WITH NCDOT STANDARD DRAWING NO 840.14 UNLESS OTHERWISE NOTED.
3. WATER QUALITY AND DETENTION FACILITIES FOR THE IMPROVEMENTS SHOWN HEREON ARE PROVIDED IN THE MASTER STORMWATER PLAN FOR THE SHILOH CROSSING SUBDIVISION RECORDED IN THE BOOK OF MAPS 2014 AT PAGES 1379-1381 OF THE WAKE COUNTY REGISTER OF DEEDS AND AS FURTHER DESCRIBED IN THE DECLARATION OF COVENANTS, RESTRICTIONS, AND EASEMENTS RECORDED IN THE WAKE COUNTY REGISTER OF DEEDS BOOK 015925, PAGE 02160 THROUGH 02169.
4. SEE C301 FOR DRAINAGE STRUCTURE AND STORM SEWER INFORMATION.
5. MEASURES SHALL BE MAINTAINED TO PREVENT SEDIMENT FROM GETTING INTO THE OFF-SITE STORMWATER WETLAND BMP. ANY SEDIMENT FROM THE PROJECT SITE THAT DOES GET INTO THE EXISTING BMP MUST BE REMOVED AND CORRECTED.
6. ALL ROOF DRAINS SHALL BE CONSTRUCTED TO HAVE A MINIMUM SLOPE OF 1/8" / FT. COORDINATE ROOF DRAIN CONNECTIONS WITH PLUMBING PLAN.
7. REFER TO SHEET C302 FOR DETAILED GRADING OF THE DRIVEWAY AND ADA ACCESSIBLE PARKING.
8. ALL CONCRETE WALKS WITHIN LANDSCAPED AREAS TO HAVE A 2' WIDE RECOVERY ON BOTH SIDES OF THE SIDEWALK. THE RECOVERY SHALL HAVE A CROSS SLOPE NOT SURPASSING 1:48.

ALLOWABLE ROOF AREA PER TABLE 1106.3	
4"	1,800 SQ. FT.
6"	5,350 SQ. FT.
*8"	11,500 SQ. FT.
10"	20,700 SQ. FT.

\* ALL ROOF DRAINS WILL ACCEPT AN AREA LESS THAN 11,500 SQ. FT. AND HAVE THUS BEEN SIZED AS 8".

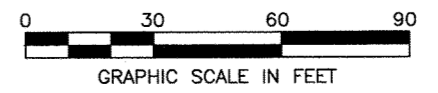

REVISION	DATE	NO.

PROJECT No: 075356  
 DATE 01/24/17  
 DES. JG  
 DR. DH  
 CKD. TR

11301 Carmel Commons Blvd.  
 Suite 300  
 Charlotte, NC 28226  
**WOOLPERT**  
 ARCHITECTURAL ENGINEERING & CONSTRUCTION  
 FAX: 704.525.8529

**SITE IMPROVEMENT PLANS**  
**WATERWALK MORRISVILLE**  
 1012 & 1016 LOWER SHILOH WAY  
 MORRISVILLE, NORTH CAROLINA

**GRADING AND DRAINAGE PLAN**

MORRISVILLE PROJECT #: 17-11000001 FILE #: 17-0001-S/C

Town of Morrisville  
 APPROVED FOR CONSTRUCTION

Signature: *[Signature]* Date: 5/23/18  
 Town of Morrisville, Town Engineer

Signature: *[Signature]* Date: 5/23/18  
 Town of Cary Utilities, Water and Sewer

Engineering Inspection Services must be contacted (919) 463-6907 at a minimum 24 hours prior to the commencement of any construction activities.

SHEET NO.  
**C300**