

Last Saved By:ladzinski, 11/18/2017 4:45:00 PM G:\DE\Clients\WaterWalk\075356\Morrisville, NC\4.0 Disciplines\Civil\Cadd\Cd\075356-C600-DET.dwg Plotted By:ladzinski, Jake Plotted:January 17, 2018, 2:51:56 PM

THE SUBGRADE IN PAVED AREAS SHALL BE PROOF-ROLLED WITH A LOADED DUMP TRUCK OR SIMILAR PNEUMATIC TIRE VEHICLE WITH A LOADED WEIGHT OF AT LEAST 20 TONS. ANY IDENTIFIED UNSTABLE AREAS SHALL BE REPAIRED.

AREAS THAT RUT OR PUMP SHALL BE UNDERCUT TO STABLE SOILS OR AN EVALUATION MADE BY THE DEVELOPER'S ENGINEER OR QUALIFIED GEOTECHNICAL FIRM TO DETERMINE IF SOME OTHER METHOD OF SUBGRADE STABILIZATION IS APPROPRIATE.

APPROVED METHODS OF STABILIZATION SHALL INCLUDE LIME STABILIZATION OF HIGH PLASTICITY CLAYS OR EXCESSIVELY WET SOILS, THE USE OF GEOSYNTHETIC OR GEGRID MATERIAL, OR OTHER STABILIZATION METHODS AS APPROVED BY THE ENGINEERING DIRECTOR.

GEOTECHNICAL FIRM SHALL PROVIDE ENGINEER OF RECORD CBR OR RESILIENT MODULUS OF SUBGRADE PRIOR TO IMPORT OF AGGREGATE. BASE COURSE DESIGN MAY BE ADJUSTED BY ENGINEER OF RECORD IN ORDER TO MEET FIELD CONDITIONS.

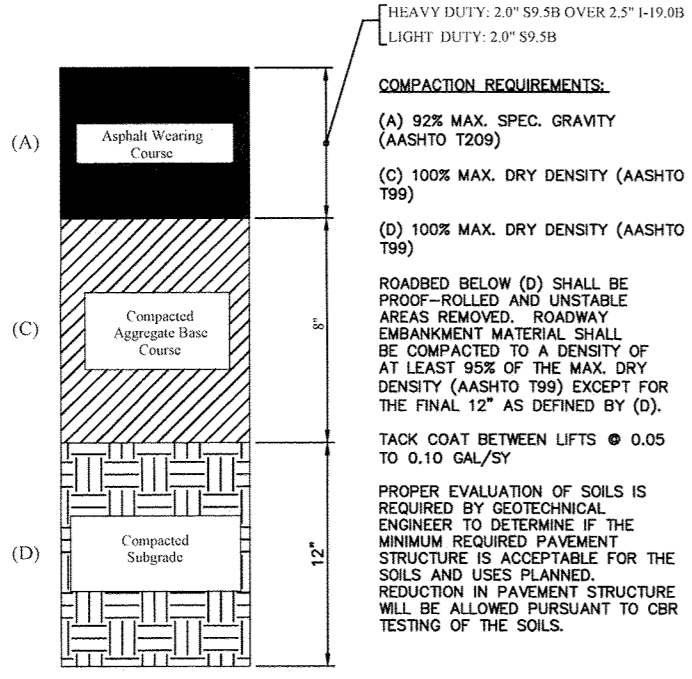

**LIGHT DUTY (LD)/HEAVY DUTY (HD) PAVEMENT DETAIL**  
NTS

1  
C807

- CONSTRUCTION SHALL CONFORM TO ACI COMMITTEE REPORT PUBLICATION 330R-08 UNLESS STATED OTHERWISE.
- SAWCUTS FOR CONTRACTION JOINTS SHALL BE MADE WITHIN 8 HOURS OF CONCRETE POUR.
- ALL CONCRETE SHALL BE 6" MINIMUM THICKNESS UNLESS OTHERWISE NOTED.
- THE SPACING OF JOINTS SHALL BE UNIFORM AND SUCH THAT THE LENGTH OF A PANEL MAY NOT EXCEED THE WIDTH BY MORE THAN 25%. MAXIMUM JOINT SPACING SHALL BE 12' O.C. SEE PLAN SHEET FOR PROPOSED JOINTS.
- ALL ODD SHAPED SLABS SHALL BE REINFORCED WITH 6X6"/10X10 WWF.
- CONCRETE SHALL HAVE A MINIMUM COMPRESSIVE STRENGTH OF 4,000 PSI AT 28 DAYS.
- VEHICULAR TRAFFIC SHALL REMAIN OFF SLAB FOR 3 DAYS MINIMUM AFTER POUR. TRUCKS SHALL REMAIN OFF OF THE SLAB FOR A MINIMUM OF 7 DAYS AFTER POUR AND THE CONCRETE HAS REACHED 75% OF THE DESIGN STRENGTH.
- ISOLATION JOINTS SHALL BE USED WHEN PROPOSED PAVEMENT ABUTS FIXED OBJECTS SUCH AS LIGHT POLES, INLETS, WALLS AND THE EXISTING PAVEMENT EDGE. A THICKENED EDGE SHALL BE USED WHEN ABUTTING / CONNECTING TO THE EXISTING PAVEMENT EDGE.
- CONTRACTOR MAY USE 3/8" THICK DIAMOND OR TRAPEZOIDAL SHAPED STEEL PLATES FOR CONSTRUCTION JOINTS FOR PAVEMENTS 7" OR LESS IN THICKNESS.
- CONSTRUCTION JOINTS SHALL BE USED BETWEEN AREAS OF CONCRETE PLACED AT DIFFERENT TIMES, SUCH AS BETWEEN WORK DAYS.
- SUBGRADE IS ASSUMED TO HAVE A CBR VALUE OF 6. CONTRACTOR SHALL ATTAIN PROCTOR OF EXISTING MATERIAL PRIOR TO COMPACTION TO VERIFY ADEQUACY OF IN-SITU MATERIAL WITH THIS ASSUMPTION. SUBGRADE SHALL BE COMPACTION TO 98% OF MODIFIED DRY DENSITY. REFER TO GEO-TECHNICAL REPORT FOR ADDITIONAL INFORMATION AND PROOF ROLL RECOMMENDATIONS.

**CONCRETE PAVEMENT NOTES**

2  
C807

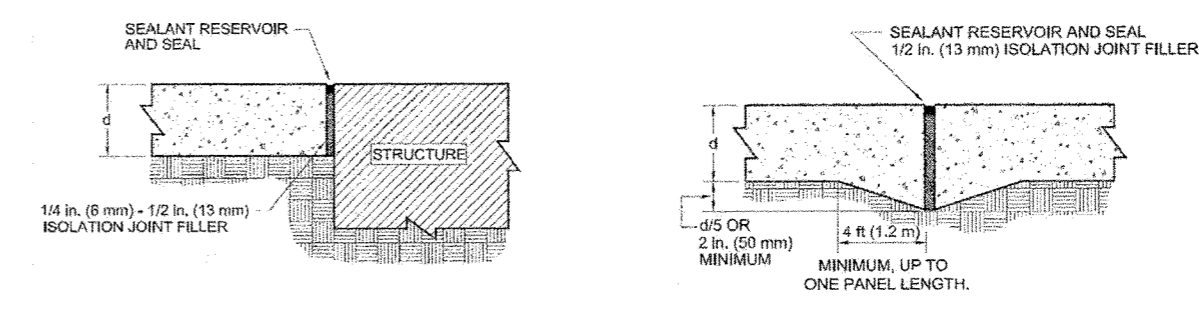

**TYPICAL ISOLATION JOINT DETAILS**  
NTS

3  
C807

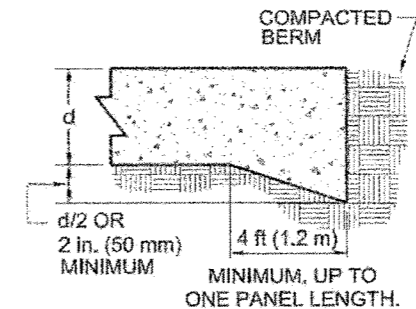

**TYPICAL THICKNESS EDGE**  
NTS

4  
C807

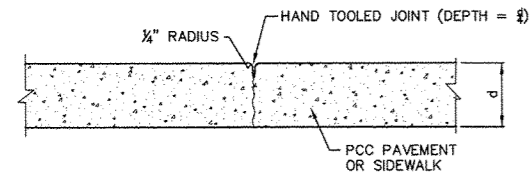

**TYPICAL CONTROL JOINT DETAIL**  
NTS

5  
C807

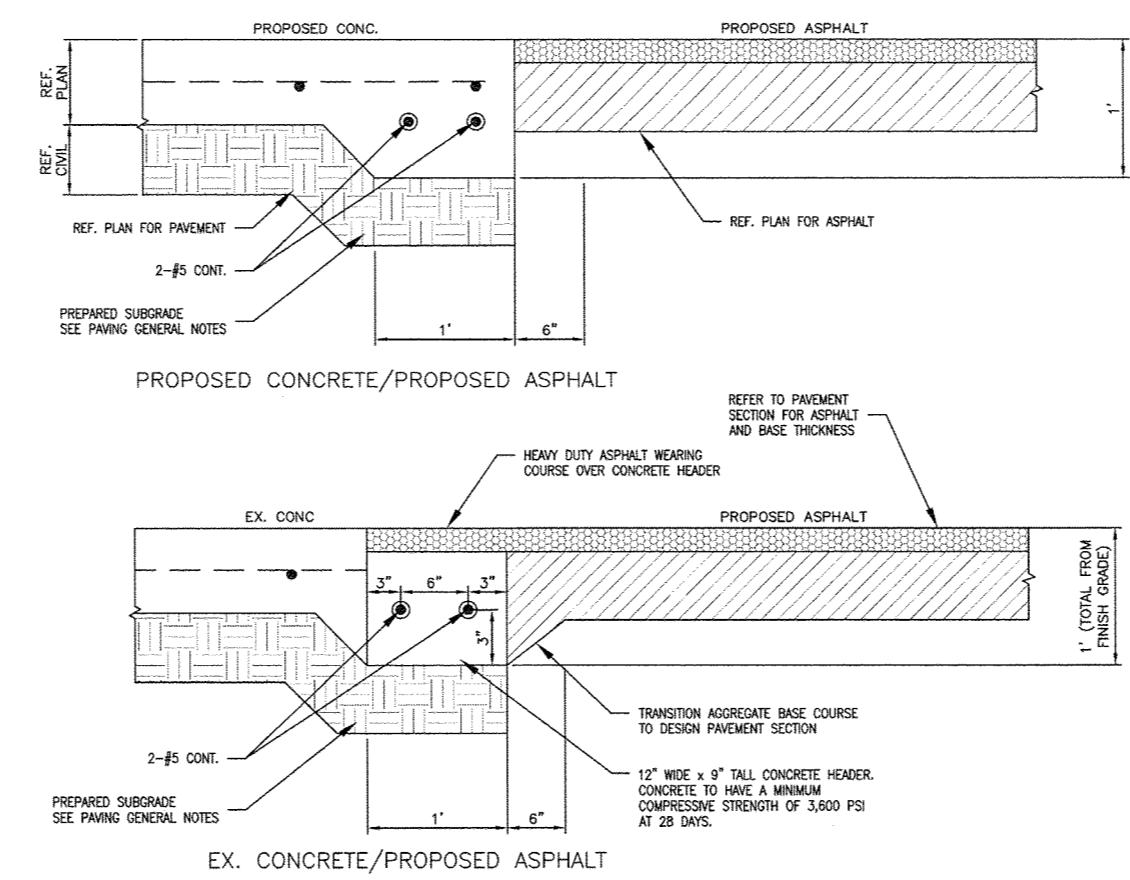

**CONCRETE/ASPHALT TRANSITION**  
NTS

6  
C807

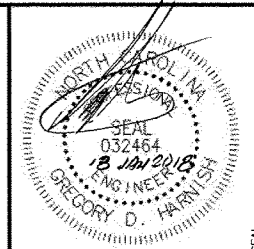

No.	DATE	REVISION

PROJECT No: 075356  
DATE: 01/24/17  
DES. JG  
DR. JL  
CKD. TR

11301 Carmel Commons Blvd.  
Suite 300  
Charlotte, NC 28226  
704.525.6284  
FAX: 704.525.8529



**SITE IMPROVEMENT PLANS**  
**WATERWALK MORRISVILLE**  
1012 & 1016 LOWER SHILOH WAY  
MORRISVILLE, NORTH CAROLINA

**MISCELLANEOUS SITE DETAILS**

MORRISVILLE PROJECT # : 17-11000001 FILE # : 17-0001-S/C

Town of Morrisville  
APPROVED FOR CONSTRUCTION

Signature: *[Signature]* Date: 5/31/18  
Town of Morrisville, Town Engineer

Engineering: *[Signature]* Date: 5/31/18  
Planning: *[Signature]*  
Other (specify): *[Signature]*

Signature: *[Signature]* Date: 5/23/18  
Town of Garry Utilities, Water and Sewer

Engineering Inspection Services must be contacted (919) 463-6907 at a minimum 24 hours prior to the commencement of any construction activities.

SHEET No.  
**C807**