

MARSENSA LANE (PRIVATE)  
STA. 10+00 - STA. 12+20.28  
SCALE 1" = 40'

MARSENSA LANE (PRIVATE)  
STA. 10+00 - STA. 12+20.28  
HORZ. SCALE 1" = 40' VERT. SCALE 1" = 4'

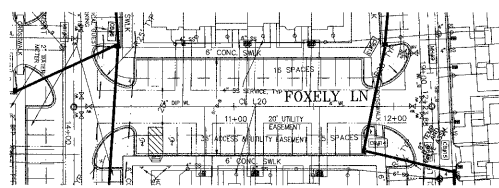
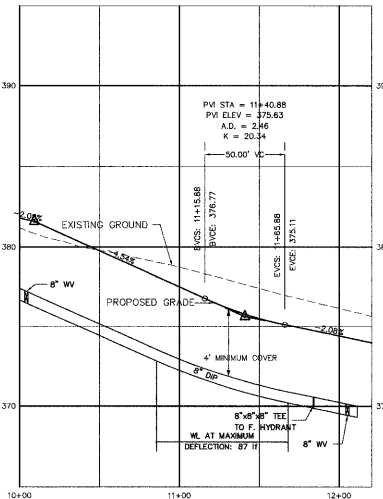

FOXELY LANE (PRIVATE)  
STA. 10+00 - STA. 12+23.85  
SCALE 1" = 40'

FOXELY LANE (PRIVATE)  
STA. 10+00 - STA. 12+23.85  
HORZ. SCALE 1" = 40' VERT. SCALE 1" = 4'

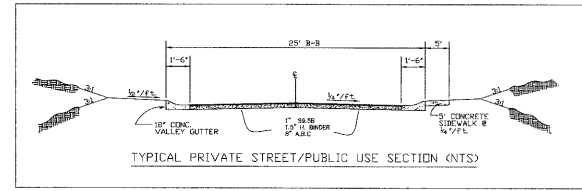
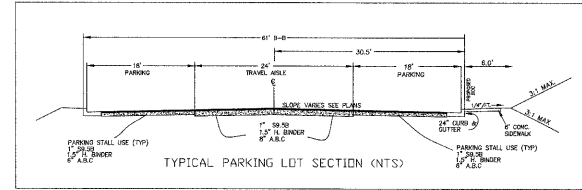
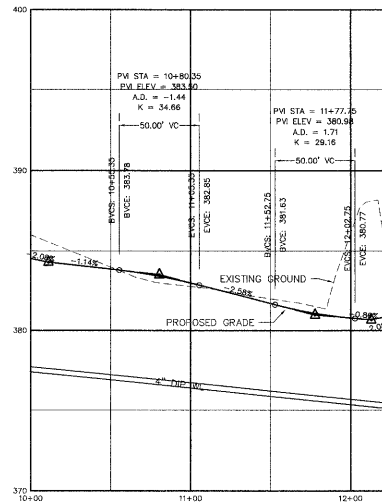

- UTILITY SEPARATION:
1. WATER & SEWER MAINS
  2. MINIMUM LATERAL SEPARATION - 12" (VERTICAL)
  3. SEWAGE LINES WITH 18" MIN VERTICAL SEPARATION
  4. WATER & STORM DRAIN LINES - 12" MIN VERTICAL SEPARATION
  5. SANITARY SEWER & STORM DRAIN LINES - 12" MIN VERTICAL SEPARATION
  6. MINIMUM COVER OVER WATER MAINS - 3.0'
  7. MINIMUM COVER OVER SEWER MAINS - 5.0'
  8. WITHIN TRAFFIC BEARING AREA - 3'
  9. WITHIN NON-TRAFFIC BEARING AREA - 3'

GENERAL CONSTRUCTION NOTES

1. ALL DIMENSIONS SHOWN ARE TO THE BACK OF CURB UNLESS OTHERWISE NOTED ON THE PLANS. CONTACT THE TOWN FOR A LISTING OF COORDINATES FOR ALL PARKING LOTS AND BUILDING CORNERS.
2. ALL CURB AND GUTTER WORK WITHIN THE SITE IS STANDARD 18" 30' WITHIN RIGHT-OF-WAY.
3. EXISTING ROADWAY LINES SHALL BE PAINTED YELLOW AND MARKED ACCORDINGLY. AREAS TO BE MARKED AS SUCH SHALL BE DESIGNATED BY ANGLE OF INTERSECTION OF THE CURB/FREE CURBMENT LINE(S) SHALL BE OF THE PROPOSED IMPROVEMENTS.
4. ALL CONSTRUCTION SHALL BE IN ACCORDANCE WITH CURRENT TOWN OF CARY STANDARD SPECIFICATIONS AND DETAILS.
5. ALL EXTERIOR LIGHTING SHALL BE DESIGNED TO PREVENT OFF-SITE ILLUMINATION.
6. WITH AND SUPER DEVELOPMENT FEES ARE DUE PRIOR TO ISSUANCE OF BUILDING PERMITS.
7. IF THE RESPONSIBILITY OF THE DEVELOPER IS TO SECURE THE FOLLOWING PERMIT AFTER TOWN COUNCIL APPROVAL: THE TOWN OF CARY GRADING PERMIT AND CONES PERMITS THE PROJECT MAY REQUIRE A CERTIFICATE OF INSURANCE TO VERIFY WORKERS COMPENSATION INSURANCE AND A COMPLIANCE CERTIFICATE FROM THE COUNTY.
8. CONVEYED BEFORE AN EASEMENT FROM THE SITE SHALL BE OBTAINED BEFORE ANY CONSTRUCTION COMMENCEMENT BEFORE AN ENVIRONMENTAL PERMIT IS ISSUED.
9. THE CONTRACTOR SHALL LOCATE ALL UTILITIES PRIOR TO THE COMMENCEMENT OF GRADING ACTIVITIES. CONTACT LOCAL UTILITY COMPANIES FOR FIELD LOCATION OF UNDERGROUND UTILITIES.
10. ALL PARKING SHALL BE 2' - 2" & 8" A/C RIND FOR TRAVEL AND 8" A/C RIND FOR PARKING SPACES.
11. UNLESS OTHERWISE NOTED, ALL SPOT ELEVATIONS ARE TOP OF ADJUSTED FINISH GRADE.
12. SEE ARCHITECTURAL AND STRUCTURAL PLANS FOR BUILDING CONSTRUCTION AND FINISHES. SEE LOCATION AND SIZE OF ROOF DRAIN, WATER LEAKS AND SEWER LINES.
13. ALL SEWER LINES SHALL BE PLACED AT A MINIMUM SLOPE OF 1% ON 4" LINES AND 0.5% ON 8" LINES. CLEANOUTS SHALL BE PLACED AT A MINIMUM SPACING OF 70' ON 4" LINES AND 100' ON 8" LINES.
14. THE SLOPE OF HANDICAP PARKING SPACES SHALL NOT EXCEED 1/4" PER FOOT.
15. ALL 20' SPACES SHALL BE FOR ONE CONSTRUCTION TRUCK.
16. AN UNPAVED DRIVEWAY MUST BE CLOSED IN ACCORDANCE WITH THE TOWN OF CARY DRIVEWAY ORDINANCE.
17. ALL VENT PIPES, ETC. EXTENDING ABOVE THE ROOF SURFACE MUST BE PASSED A CURB SHALL BE IN ACCORDANCE WITH THE TOWN OF CARY DRIVEWAY ORDINANCE.
18. ALL STORM DRAINS AND HOSES ON SITE SHALL BE STAMPED WITH 'TOWN OF CARY' TO PREVENT IN ACCORDANCE WITH TOWN OF CARY DRIVEWAY ORDINANCE.
19. STREETS IN FRONT OF THIS PROJECT SHALL BE KEPT CLEAN AT ALL TIMES. A HOSE WASH SHALL BE REQUIRED.
20. ALL WORK SHALL BE DONE IN ACCORDANCE WITH THE TOWN OF CARY DRIVEWAY ORDINANCE.
21. BEST MANAGEMENT PRACTICES AND ENGINEERED STORM WATER CONTROL MEASURES SHALL BE INSTALLED AT THE TIME OF CONSTRUCTION.
22. DEVELOPMENT ORDINANCE (CHAPTER 4 PART 4.6. LUD).
23. IF THERE WILL BE A TRUCK COMPUTER ON THE SITE, A CONNECTION TO SANITARY SEWER AND A COVERED DUMPSTER SITE WILL BE REQUIRED. BARRIERS, STRUCTURES AND SIGNAGE MUST BE ON SITE BEFORE THE GRADING PERMIT IS ISSUED.
24. THE WATERSHED FOR THIS SITE IS GRAYBROOK CREEK.

LINE TABLE		
LINE	LENGTH	BEARING
CL 11	70.00	S89°27'45"W
CL 12	0.47	S81°57'37"E
CL 13	17.50	S80°32'35"E
CL 14	50.70	S46°48'19"W
CL 15	608.67	S27°20'04"W
CL 16	36.56	S25°32'14"W
CL 17	50.70	S82°07'20"W
CL 18	16.40	S82°07'20"W
CL 19	101.30	S84°17'20"W
CL 20	14.00	N47°24'45"E
CL 21	87.50	N20°10'00"W
CL 22	13.00	S10°30'00"W
CL 23	27.94	S10°30'00"W
CL 24	14.87	S10°30'00"W
CL 25	27.94	S10°30'00"W
CL 26	35.81	S42°28'45"E
CL 27	43.81	S32°40'31"E
CL 28	28.43	S20°07'00"W
CL 29	10.00	S65°32'35"W
CL 30	22.83	N20°07'30"W

CURVE TABLE						
CURVE	LENGTH	RAADIUS	DELTA	TANGENT	CHORD	CHORD BISECT
CL 01	157.73	416.56	21°54'28"	74.84	127°34'28"	156.77
CL 02	274.62	141.61	18°57'25"	75.03	143°37'46"	253.91
CL 03	593.33	212.50	10°18'27"	130.71	162°03'37"	368.68
CL 04	94.37	292.90	23°57'12"	46.89	113°07'02"	92.65
CL 05	176.73	187.50	34°17'19"	91.63	130°24'47"	164.54
CL 06	54.56	252.90	27°11'36"	27.13	135°07'07"	53.91
CL 07	104.4	252.90	42°42'28"	51.62	120°37'07"	104.63
CL 08	89.56	262.11	22°19'38"	47.90	164°16'25"	86.72
CL 09	98.32	262.11	34°47'19"	52.92	147°38'47"	98.63
CL 10	112.4	177.50	39°57'55"	56.71	124°21'56"	73.94
CL 11	53.33	127.50	37°17'19"	26.53	120°37'07"	53.91
CL 12	84.48	112.23	38°17'54"	36.91	120°37'07"	73.94
CL 13	65.32	152.03	34°47'19"	32.92	147°38'47"	66.84
CL 14	25.32	290.00	48°08'37"	12.69	161°14'47"	25.32



Approved by: *[Signature]* Date: 1-28-08  
 Planning: *[Signature]* Date: 4-1-08  
 Engineering: *[Signature]* Date: 3/20/08

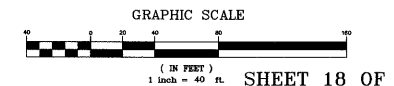

G:\work\projects\weatherfield\pdd\phase 01.dwg, Mon, Nov 15, 12:12:31, 2007