

CONSTRUCTION SEQUENCE

- 1) Obtain Grading Permit.
- 2) Install all erosion control measures as shown.
- 3) Clear site only as necessary to install 36" RCP from CI 1 to FES 3. The 36" RCP must be installed prior to issuance of a Certificate of Compliance.
- 4) Obtain Certificate of Compliance through on-site inspection by Town Erosion Control Engineer.
- 5) Proceed with grading.
- 6) Clean sediment basins when half full.
- 7) Seed and mulch denuded area within 30 days after finished grades are established.
- 8) Maintain soil erosion control measures until permanent ground cover is established.
- 9) Request final approval by Town Erosion Control Engineer.
- 10) Remove soil erosion control measures and stabilize these areas.

SEEDBED PREPARATION

- 1) Chisel compacted areas and spread topsoil 3 inches deep over adverse soil conditions, if available.
- 2) Rip the entire area to 6 inches depth.
- 3) Remove all loose rock, roots and other obstructions leaving surfaces reasonably smooth and uniform.
- 4) Apply agricultural lime, fertilizer, and superphosphate uniformly and mix with soil (see below).
- 5) Continue tillage until a well-pulverized, firm, reasonably uniform seedbed is prepared 4 to 6 inches deep.
- 6) Seed a freshly prepared seedbed and cover seed lightly with seeding equipment or cultipack after seeding.
- 7) Mulch immediately after seeding and anchor mulch.
- 8) Inspect all seeded areas and make necessary repairs or reseeds within the planting season, if possible. If stand should be over 60% damaged, reestablish following original lime, fertilizer and seeding rates.
- 9) Consult Conservation Inspector on maintenance treatment and fertilization after permanent cover is established.

* Apply: Agricultural Limestone - 2 Tons/Acre (3 Ton per Acre on clay soils)
 Fertilizer - 1,000 lbs/acre - 10-10-10
 Superphosphate - 500 lbs/acre - 20%
 Mulch - 2 Tons/Acre - small grain straw
 Anchor - Asphalt Emulsion @ 300 gal. acre

SEEDING SCHEDULE
 SHOULDERS, SIDE DITCHES, SLOPES (max. 3:1)

DATE	TYPE	PLANTING RATE
Aug 15 - Nov 1	Tall Fescue	300 lbs/acre
Nov 1 - Mar 1	Tall Fescue & Abruzzi Rye	300 lbs/acre
Mar 1 - Apr 15	Tall Fescue	300 lbs/acre
Apr 15 - June 30	Hulled Common Bermudagrass	25 lbs/acre
July 1 - Aug 15	Tall Fescue and *** Bromtop Millet *** or Sorghum-Sudan Hybrids	120 lbs/acre 35 lbs/acre 30 lbs/acre
SLOPES (3:1 to 2:1)		
Mar 1 - June 1	Sericea Lespedeza (scarified) and ADD Tall Fescue	50 lbs/acre
Mar 1 - Apr 15	ADD Tall Fescue	120 lbs/acre
Mar 1 - June 30	ADD Weeping Lovegrass	10 lbs/acre
Mar 1 - June 30	ADD Hulled Common Bermudagrass	25 lbs/acre
June 1 - Sep 1	*** Tall Fescue and *** Bromtop Millet *** or Sorghum-Sudan Hybrids	120 lbs/acre 35 lbs/acre 30 lbs/acre
Sep 1 - Mar 1	Sericea Lespedeza (unhulled-uncarified) and Tall Fescue	70 lbs/acre
Nov 1 - Mar 1	ADD Abruzzi Rye	120 lbs/acre 25 lbs/acre

Consult Erosion Control Engineer or Soil Conservation Service for additional information concerning other alternatives for vegetation of denuded areas. The above vegetation rates are those which do well under local conditions; other seeding rate combinations are possible.

*** Temporary - Reseed according to optimum season for desired permanent vegetation. Do not allow temporary cover to grow over 12 inches in height before mowing, otherwise fescue may be shaded out.

DENUDED AREA = 1.1 ACRES

EROSION CONTROL NARRATIVE

THIS 2.01 ACRES SITE IS LOCATED JUST SOUTH OF AIRPORT BOULEVARD NEAR I-40 AND BORDERS STIRRUP IRON CREEK. SUFFICIENT FILL WILL BE REQUIRED TO RAISE THE SITE ABOVE THE FLOOD ELEVATION. THE PROJECT WILL INVOLVE APPROXIMATELY 1.1 DENUDED ACRES. OFFSITE DRAINAGE WILL BE CARRIED ACROSS THE SITE VIA 36" RCP AS SHOWN ON PLANS AND DESCRIBED IN THE CONSTRUCTION SEQUENCE. SEDIMENT RUNOFF IS TO BE CONTROLLED BY THE USE OF TEMPORARY DIVERSION DITCH, SILT FENCE AND FILTER BASINS AS SHOWN ON PLANS.

SEDIMENT DEVICE SUMMARY 10/26/95
 AIRPORT WENDY'S

STR #	DENUDED AREA (AC)	DRAIN AREA (AC)	FLOW Q 10 (CFS)	BASIN Q 10 DEPTH (FT)	DIMENSIONS LENGTH (FT) WIDTH (FT)	PROP. VOLUME (CF)	CLEANOUT FREQ (MONTHS)	REQ'D VOLUME (CF)	WEIR LENGTH (FT)
FB1	0.5	0.3	8.0	3	20 15	900	12	900	4
FB2	0.6	0.6	4.0	3	23 16	1104	12	1080	4

CURVE TABLE

CURVE	RADIUS	LENGTH	CHORD	BEARING
C.1	720.25'	189.63'	188.08'	N 21°29'35" W
C.2	435.54'	197.90'	196.20'	N 26°58'04" W

CONTRACTOR IS TO INSTALL SILT FENCE AT LIMITS OF CONSTRUCTION IN THIS AREA. DIVERSION DITCH IS TO BE INSTALLED IMMEDIATELY INSIDE THE SILT FENCE TO DIVERT RUNOFF TO FB1. DIVERSION DITCH IS TO REMAIN IN PLACE UNTIL SUBGRADE AT CURB LINE IS ESTABLISHED. AT THIS TIME THE CURB LINE/SHOULDER WILL DIVERT RUNOFF TO CB1/FB1 AND FILL-SLOPE CAN BE COMPLETED.

CONTRACTOR IS TO INSTALL SILT FENCE AT LIMITS OF CONSTRUCTION IN THIS AREA. DIVERSION DITCH IS TO BE INSTALLED IMMEDIATELY INSIDE THE SILT FENCE TO DIVERT RUNOFF TO FB2. DIVERSION DITCH IS TO REMAIN IN PLACE UNTIL SUBGRADE AT CURB LINE IS ESTABLISHED. AT THIS TIME THE CURB LINE/SHOULDER WILL DIVERT RUNOFF TO CB4/FB2 AND FILL-SLOPE CAN BE COMPLETED.

FILL SLOPE IS TO BE ARMORED FROM TOE OF SLOPE TO ELEVATION 289.0 USING CLASS I RIP-RAP ON MIRAFI 140N GEOTEXTILE (SEE DETAIL)

SEWER FLOW: 2500 GPD AVG. 3610 GPD PEAK
 BASED ON 12 MONTH OBSERVATION OF ACTUAL FLOWRATES FOR WENDY'S 7/94 - 7/95.

DISSIPATOR 4.5' X 18' X 22' CLASS "B" RIP-RAP WITH FABRIC UNDERLINER

DISSIPATOR 3' X 6' X 22' CLASS "B" RIP-RAP WITH FABRIC UNDERLINER

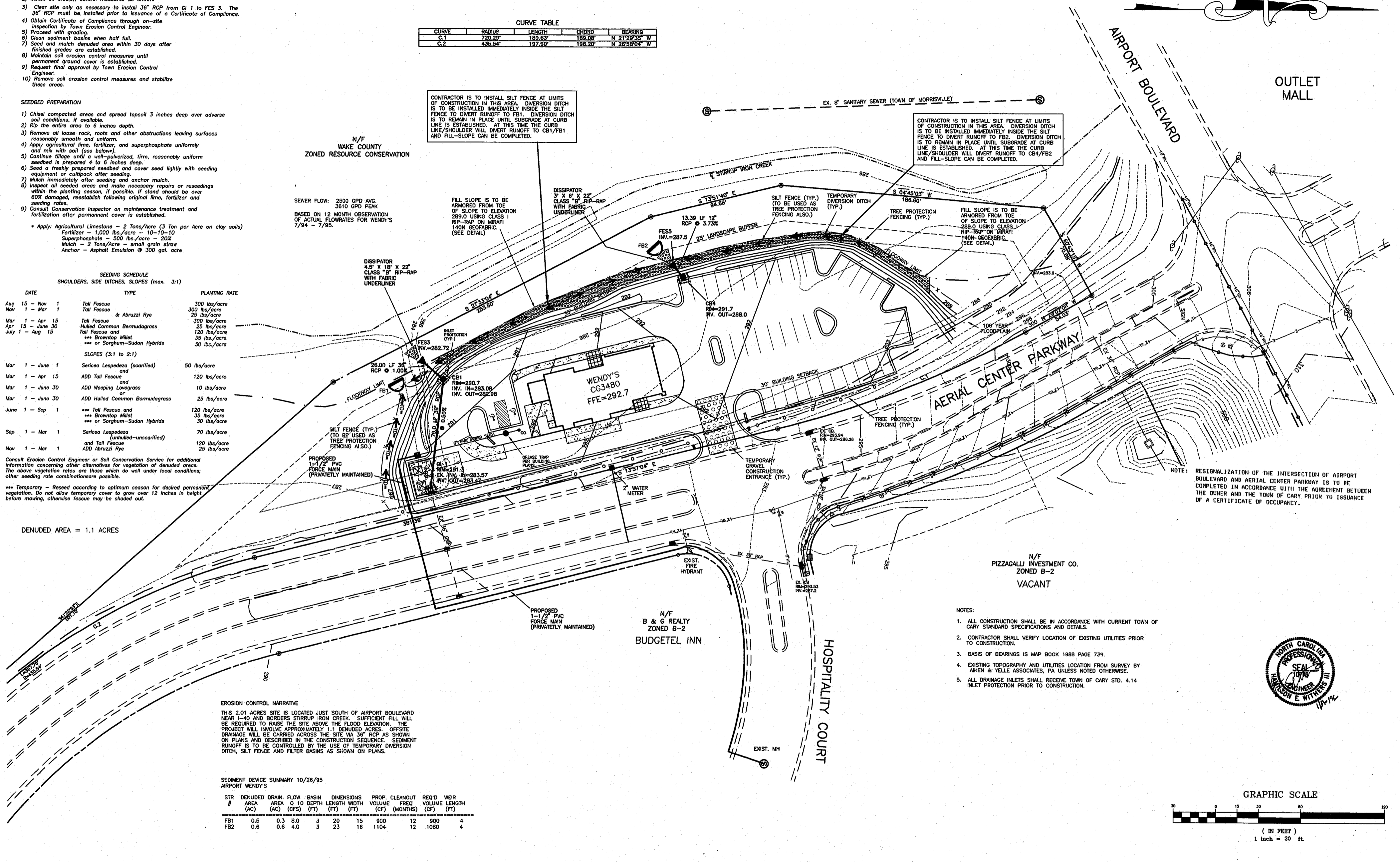

NOTE: RESIGNALIZATION OF THE INTERSECTION OF AIRPORT BOULEVARD AND AERIAL CENTER PARKWAY IS TO BE COMPLETED IN ACCORDANCE WITH THE AGREEMENT BETWEEN THE OWNER AND THE TOWN OF CARY PRIOR TO ISSUANCE OF A CERTIFICATE OF OCCUPANCY.

- NOTES:
1. ALL CONSTRUCTION SHALL BE IN ACCORDANCE WITH CURRENT TOWN OF CARY STANDARD SPECIFICATIONS AND DETAILS.
 2. CONTRACTOR SHALL VERIFY LOCATION OF EXISTING UTILITIES PRIOR TO CONSTRUCTION.
 3. BASIS OF BEARINGS IS MAP BOOK 1988 PAGE 739.
 4. EXISTING TOPOGRAPHY AND UTILITIES LOCATION FROM SURVEY BY AIKEN & YELLE ASSOCIATES, PA UNLESS NOTED OTHERWISE.
 5. ALL DRAINAGE INLETS SHALL RECEIVE TOWN OF CARY STD. 4.14 INLET PROTECTION PRIOR TO CONSTRUCTION.

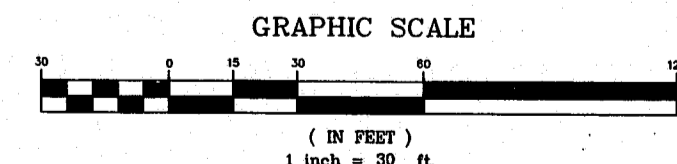
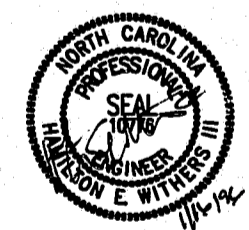

Withers & Ravenel
 Engineering and Surveying, Inc.
 111 MacKenzie Drive, Cary NC 27511 Phone: 919-463-3340 Fax: 919-467-6008

Revisions

No.	Description	Date	By
1.	PER TDC 151 REVIEW	11/20/95	BDH
2.	PER TDC 2ND REVIEW	12/7/95	BDH
3.	PER-RMP ADDED	1/13/96	BDH

AIRPORT WENDY'S
CARY, NORTH CAROLINA

GRADING, UTILITY & EROSION CONTROL PLAN

Designer	W&R	Scale	1"=30'	CAD File	
Drawn By	BDH	Date	10/26/95	Sheet No.	
Checked By	TW	Job No.	95134		2 of .