

NOTES:

1. THIS PLAN IS FOR PLANTING PURPOSES ONLY. FOR INFORMATION RELATING TO GRADING, WALLS, BUILDING, ETC., REFER TO THE SITE & GRADING PLANS AND/OR ARCHITECTURAL PLANS.
2. ALL GRASS IS TO BE REBEL II FESCUE
3. ALL PLANTS AND PLANTING PROCEDURES SHALL MEET OR EXCEED A.A.N. STANDARDS AS SET FORTH IN "AMERICAN STANDARD FOR NURSERY STOCK" 1986 OR LATEST EDITION.
4. ALL SHRUB AND PLANT BEDS SHALL BE MULCHED WITH 3" CLEAN PINE STRAW. GROUND COVER BEDS WITH 3" PINE BARK MULCH.
5. ALL TREES AND SHRUBS SHALL BE FULL WELL BRANCHED PLANTS WHICH ARE CHARACTERISTIC OF THE SPECIES. TOPSOIL SHALL BE SPREAD OVER THE ENTIRE LANDSCAPE AREA TO A DEPTH OF AT LEAST 4" IN LAWN AREAS AND 6" IN SHRUB AND GROUND COVER BEDS.

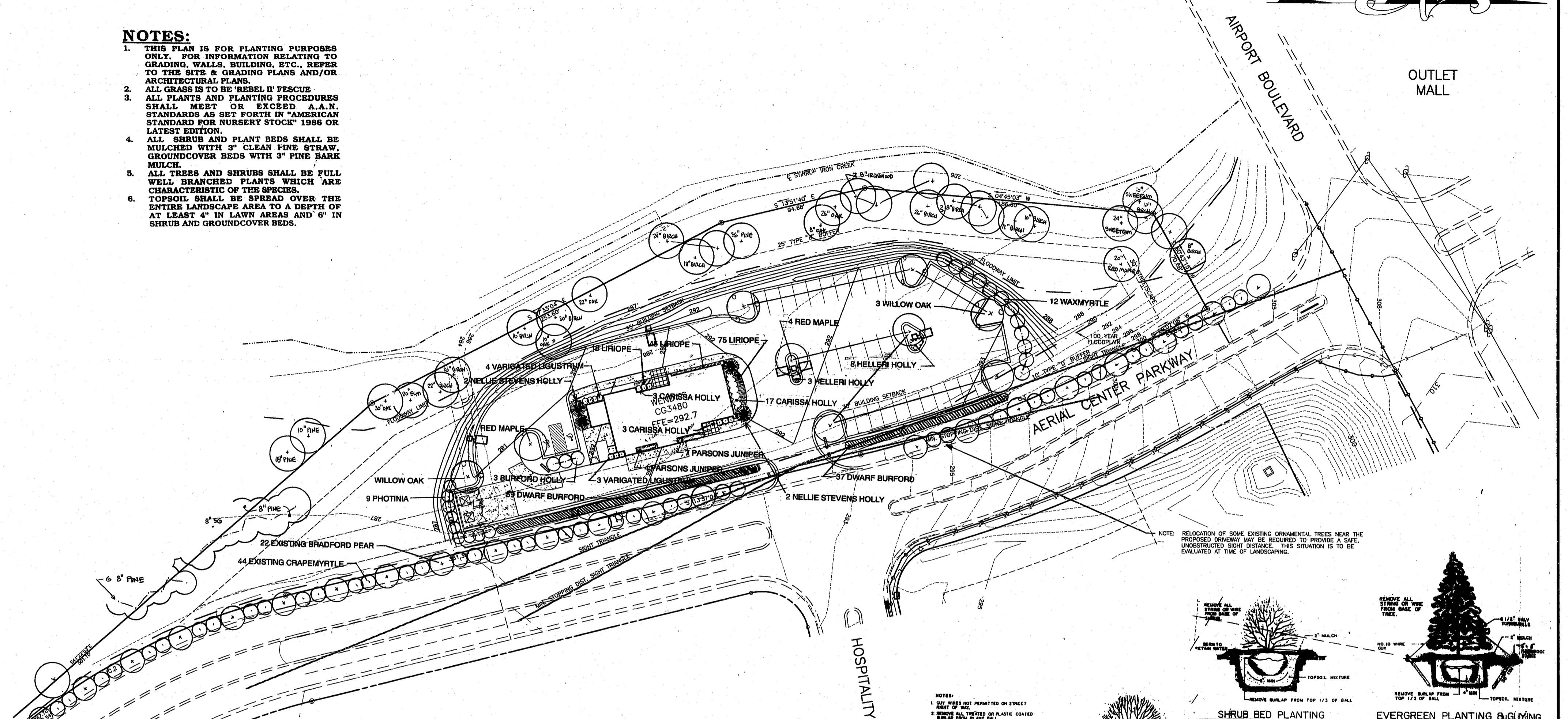

NOTE: RELOCATION OF SOME EXISTING ORNAMENTAL TREES NEAR THE PROPOSED DRIVEWAY MAY BE REQUIRED TO PROVIDE A SAFE, UNOBSTRUCTED SIGHT DISTANCE. THIS SITUATION IS TO BE EVALUATED AT TIME OF LANDSCAPING.

- NOTES:
1. GUY WIRES NOT PERMITTED ON STREET FRONT OF BALL.
 2. REMOVE ALL TREES OR PLASTIC COATED BURLAP FROM PLANT BALL.
 3. SUSTAIN TOP OF PLANT BALL UP TO 2" ABOVE EXISTING GRADE.
 4. SOAK PLANT BALL AND PIT IMMEDIATELY AFTER INSTALLATION.
 5. WRAP TREES FROM GROUND TO LOWEST BRANCHES WITH TREE WRAP PAPER. SECURE TOP & BOTTOM WITH NEAP STRINGS ONLY.
 6. REMOVE ALL STRINGS OR WIRE FROM BASE OF TREE.

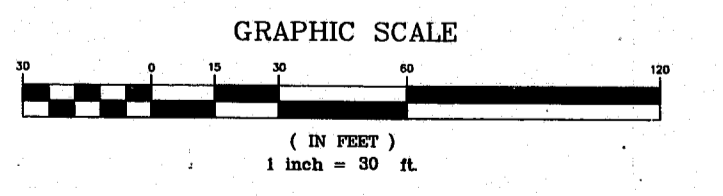
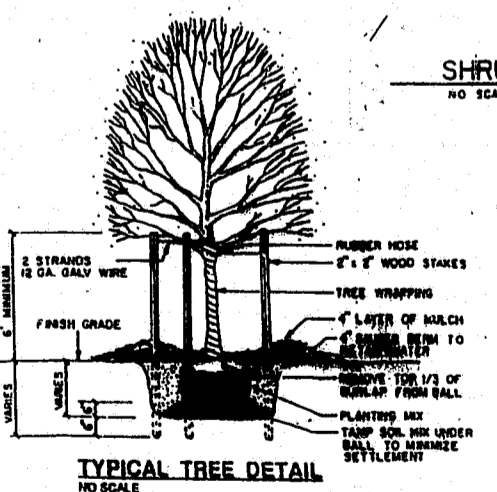
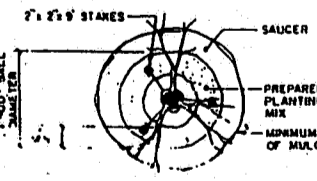
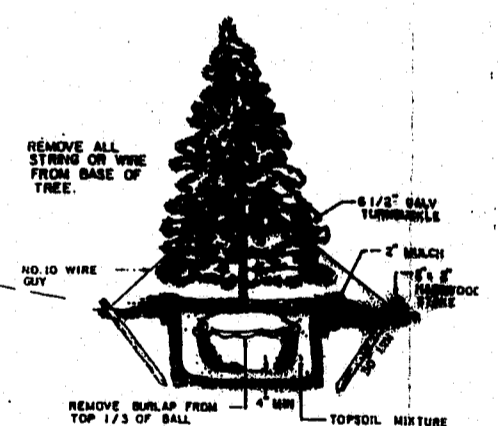
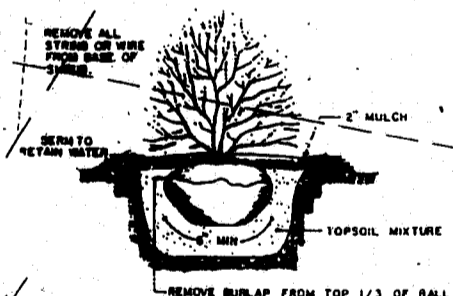

PLANT LIST						
QTY.	BOTANICAL NAME	COMMON NAME	CAL.	HT.	ROOT	REMARKS
5	Acer Rubrum	Red Maple	2.5" - 3"	10' - 12'	B & B	
4	Quercus Phellos	Willow Oak	2.5" - 3"	10' - 12'	B & B	
12	Myrica Cerifera	Waxmyrtle		36" - 42"	Cont.	
4	Ilex 'Nellie R. Stevens'	Nellie Stevens Holly		4' - 5'	B & B	
23	Ilex Cornuta 'Carissa'	Carissa Holly		15" - 18"	Cont.	3 Gal., 3' o. c.
7	Ligustrum Sinense 'Variegata'	Variegated Ligustrum		24" - 30"	Cont.	
11	Juniperus Parsonii	Parsons Juniper		15" - 18"	Cont.	3 Gal., 3' o. c.
3	Ilex Cornuta 'Burfordii'	Burford Holly		3' - 4'	Cont.	
9	Photinia Glabra	Chinese Photinia		4'	B & B	
96	Ilex Cornuta 'Burfordii Nana'	Dwarf Burford Holly		15" - 18"	Cont.	3 Gal., 3' o. c.
138	Liriope Muscarii 'Variegata'	Variegated Liriope		15" - 18"	Cont.	4" Pots, 12" o. c.
11	Ilex crenata "Helleri"	Helleri Holly		15" - 18"	Cont.	3 Gal., 3' o. c.

Withers & Ravenel
Engineering and Surveying, Inc.
111 MacKenan Drive, Cary NC 27511 Phone: 919-469-3340 Fax: 919-467-8008

Revisions			
No.	Description	Date	By

**AIRPORT WENDY'S
CARY, NORTH CAROLINA**

LANDSCAPE PLAN

Designer W&R	Scale 1"=30'	CAD File
Drawn By BDH	Date 10/9/95	Sheet No.
Checked By TW	Job No. 95134	3 of .