

WESTON OFFICE BUILDING

Cary,
North Carolina

FIRST FLOOR PLAN

- Revisions:
- 1 12/10/99
VALUE ENGINEERING REVISIONS
 - 2 1/04/00
TOWN OF CARY REVISIONS
 - 3 2/14/00
VALUE ENGINEERING REVISIONS
 - 4 4/17/00
TOWN OF CARY REVISIONS

TOWN OF CARY
PROJECT NO.
00-SP-039

Project Number
185.01

Drawn By: KAJ,MRW
Checked By: JWS
Date: 09/17/99

Sheet Number
A-1.2

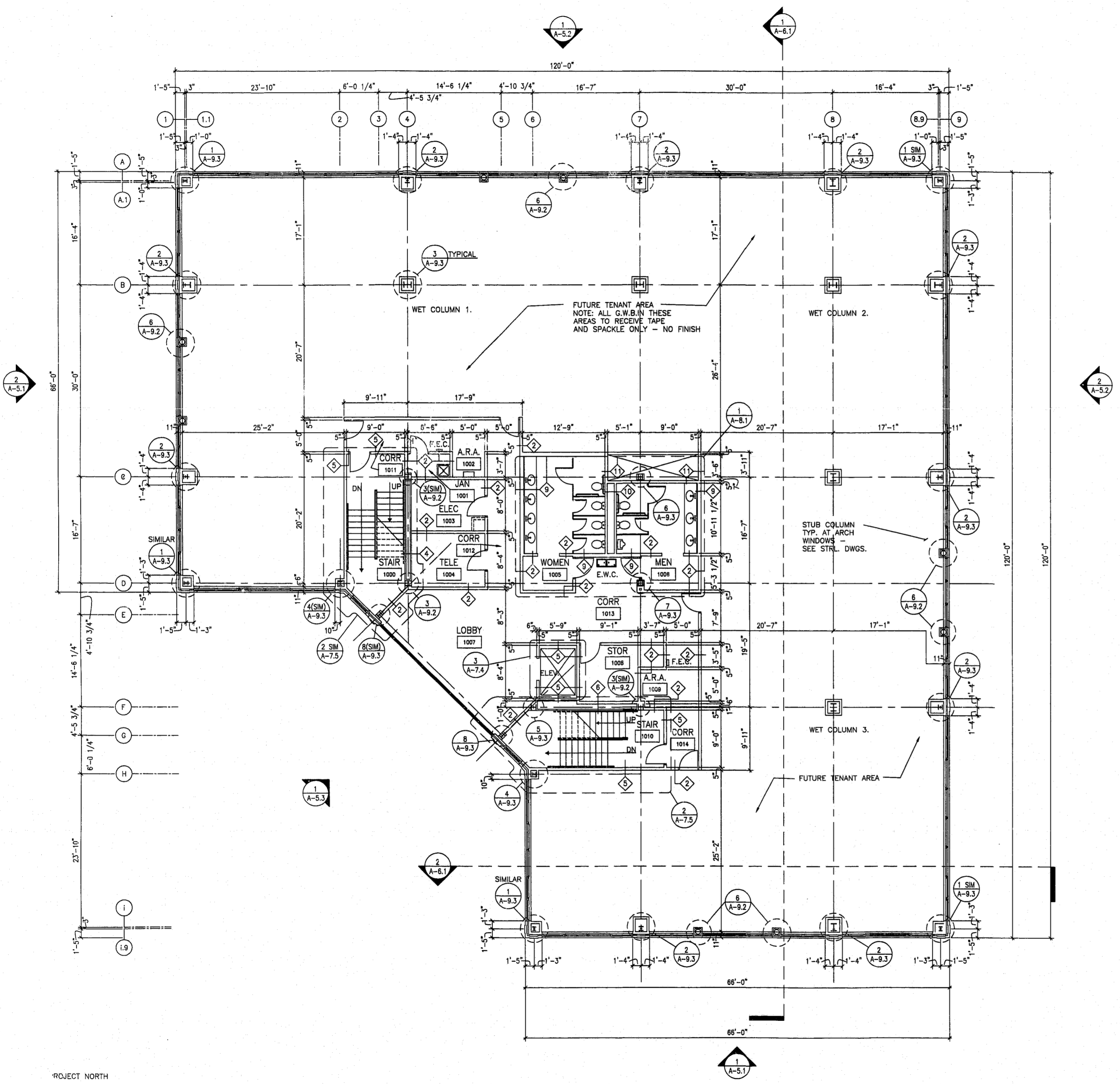

GENERAL NOTES:

1. SEE CIVIL/SITE DRAWINGS FOR EXTENT OF PAVING, SIDEWALKS, GRADING, SITE IMPROVEMENTS, AND UTILITIES.
2. SEE LANDSCAPING PLAN FOR EXTENT OF PLANTINGS, LAWN SEEDING, AND LANDSCAPING.
3. WALL AND PARTITION DIMENSIONS ARE FINISH-FACE TO FINISH-FACE.
4. COLUMN DIMENSIONS ARE TO CENTERLINE OF COLUMN.
5. ALL STEEL COLUMNS SHALL RECEIVE EITHER 1-HOUR RATED SPRAY-ON FIREPROOFING OR G.W.B./METAL STUD ENCLOSURE FULL HEIGHT TO UNDERSIDE OF METAL FLOOR DECK OR METAL ROOF DECK PER U.L. REQUIREMENTS AND DESIGN NUMBERS.

NOTE: SIGNAGE PACKAGE IS FORTHCOMING, AND WILL BE A SEPERATE APPROVAL PROCESS. SIGNAGE HAS NOT BEEN REVIEWED AS A PART OF THIS PLAN SUBMITTAL.

PROJECT NORTH



1 FIRST FLOOR PLAN
A-1.2 1/8"=1'-0" 18501.dwg