

WESTPARK PLACE P.U.D.

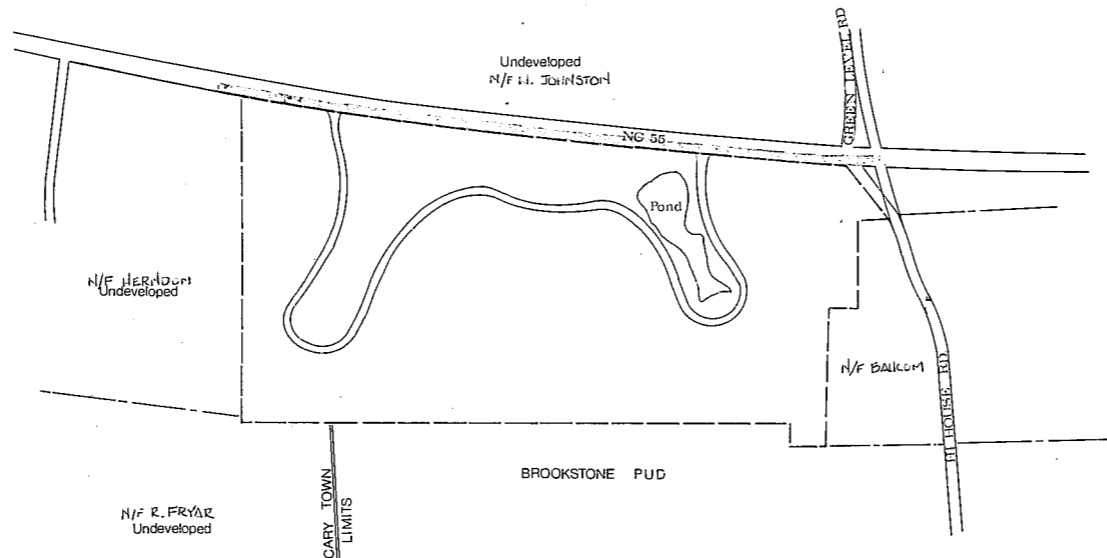

Owners

SHELL OIL CO.
P.O. BOX 2463
HOUSTON, TEXAS
77256
(713) 241-0245

Index

- SHEET
 1 COVER SHEET
 2-5 PLAN & PROFILE
 DI-D2 DETAILS
 CI-C5 CULVERT EXTENSION
 DETAILS

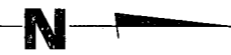
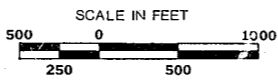

APPROVED
 DATE: 7/16/89
 BY: [Signature]
 TOWN OF CARY
 ENGINEERING DEPARTMENT

paton
zucchino &
associates
p.a.
LANDSCAPE ARCHITECTURE, LAND PLANNING & ECOLOGICAL MANAGEMENT
 Cooper Square 17 Glenwood Avenue Raleigh, NC 27603 (919) 834-8920

NC 55 WIDENING

HUGH J. GILLEECE & ASSOC.
 104 FOUNTAINBROOK CIRCLE SUITE C CARY N.C. 27511 (919) 469-1101

REVISIONS	

DESIGNER	DATE
TOM	AS NOTED
CHECKED BY	JOB NO. 1460.10

SHEET
1
OF