

WING PLAN

The portion of wing footing that extends under the bottom slab is to have a minimum thickness not less than the thickness shown for the bottom slab in TYPICAL BARREL SECTION

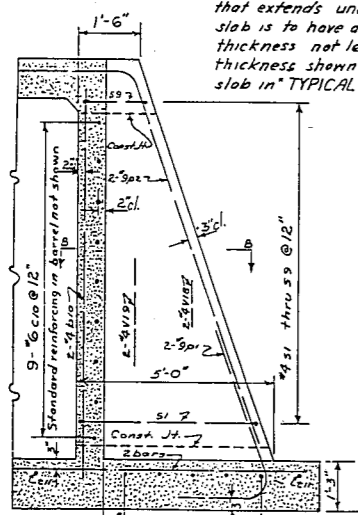

SECTION A-A

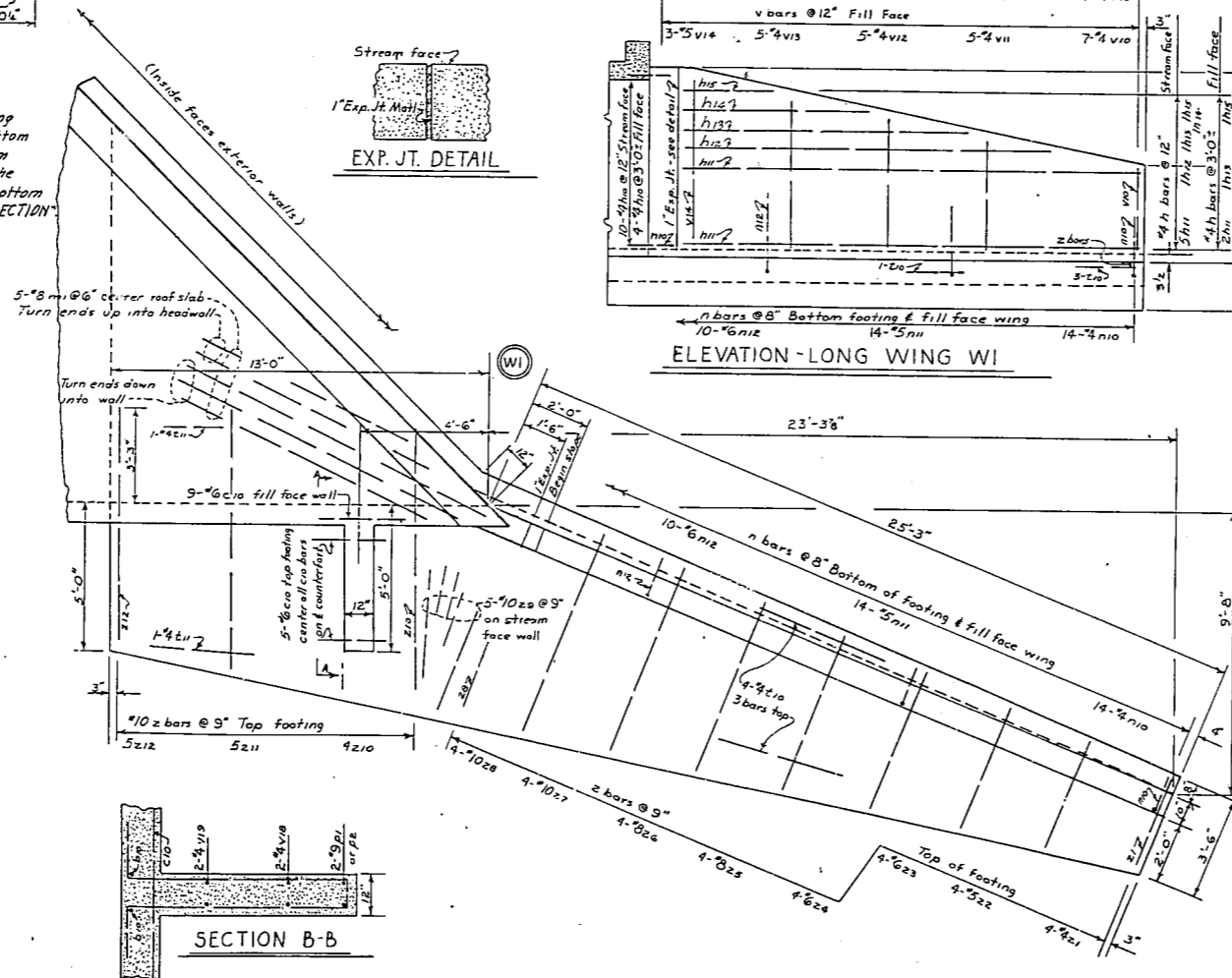

ELEVATION - LONG WING W1

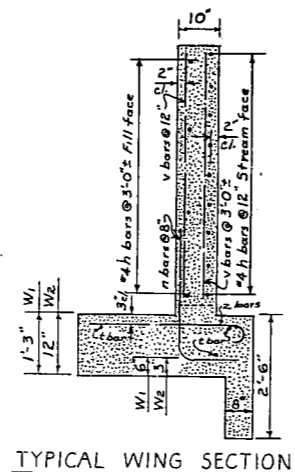

TYPICAL WING SECTION

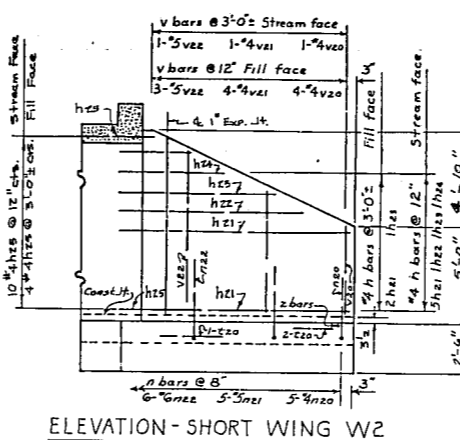

ELEVATION - SHORT WING W2

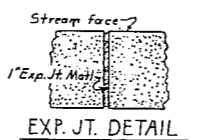

EXP. JT. DETAIL

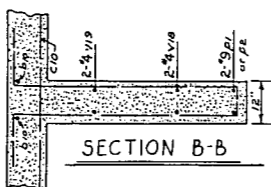

SECTION B-B

REINFORCING STEEL

BAR SCHEDULE

LONG WING (W1)				
BAR NO.	SIZE	TYPE	LENGTH	WEIGHT
B10	2	4	STR 10'-0"	13
C16	14	6	STR 9'-0"	189
H10	14	4	20 3'-1"	33
H11	7	4	STR 23'-0"	108
H12	2	4	STR 13'-0"	13
H13	2	4	STR 14'-0"	19
H14	1	4	STR 9'-0"	7
H15	2	4	STR 5'-0"	6
H1	5	8	4 16'-0"	214
N10	14	4	9 4'-1"	28
N11	14	5	9 4'-1"	66
N12	10	6	9 5'-0"	75
P1	2	9	13 7'-3"	49
P2	2	9	14 13'-2"	90
S1	1	4	30 11'-9"	8
S2	1	4	30 11'-1"	7
S3	1	9	30 10'-5"	7
S4	1	9	30 9'-1"	7
S5	1	4	30 9'-1"	6
S6	1	4	30 8'-3"	6
S7	1	4	30 8'-3"	6
S8	1	4	30 6'-11"	5
S9	1	4	30 6'-3"	4
T10	4	4	STR 25'-0"	67
T11	2	4	STR 13'-0"	17
V10	8	4	STR 4'-6"	24
V11	6	4	STR 5'-0"	23
V12	7	4	STR 6'-0"	30
V13	6	4	STR 7'-0"	30
V14	5	5	STR 8'-0"	28
V15	2	4	STR 4'-6"	6
V16	4	4	STR 8'-0"	12
21	4	4	2 3'-7"	10
22	4	4	2 4'-4"	18
23	4	4	2 7'-0"	30
24	4	6	2 5'-0"	34
25	4	8	2 6'-0"	71
26	4	8	2 7'-0"	77
27	4	10	2 8'-0"	142
28	4	10	2 8'-0"	151
29	5	10	2 9'-0"	203
210	4	10	STR 9'-0"	164
211	4	10	STR 8'-0"	188
212	4	10	STR 8'-0"	172

SHORT WING (W2)

H21	7	4	STR 8'-7"	40
H22	1	4	STR 7'-4"	5
H23	2	4	STR 5'-1"	7
H24	1	4	STR 3'-4"	2
H25	14	4	20 3'-6"	33
N20	5	4	9 4'-1"	14
N21	5	5	9 4'-6"	23
N22	6	6	9 5'-0"	45
S20	3	6	STR 6'-0"	27
T20	3	1	STR 10'-3"	21
V20	5	4	STR 4'-9"	16
V21	5	4	STR 6'-6"	22
V22	4	5	STR 8'-3"	34
220	5	4	2 3'-9"	13
221	5	5	2 4'-10"	25
222	6	6	2 5'-8"	51

TOTAL 2850

WING QUANTITIES

CLASS 'A' CONCRETE
WINGS ONLY AS SHOWN 22.7 CY.
HEADWALL AND END CURTAIN WALL 2.2 CY.
TOTAL 24.9 CY.
REINFORCING STEEL 2850 LBS.

BENDING DIAGRAMS

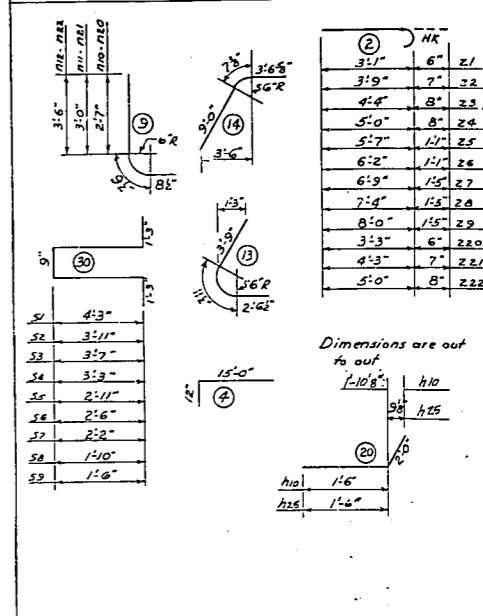

Dimensions are out to out of h10 h25 h10 h25 h10 h25



6-5-89

NC 55 WIDENING

HUGH J. GILLEECE & ASSOC.
104 FOUNTAINBROOK CIRCLE SUITE C CARY N.C. 27511 (919) 469-1101

REVISIONS Approved 7/14/89

DESIGNER	DATE	SHEET
3151	6-5-89	C-2
DRAWN BY	SCALE	
CHECKED BY	JOB NO.	OF
		5