

NOTE: MANHOLES LABEL "SEALED" OR "WATER TIGHT" TO BE TOWN OF CARY STANDARD 7.06

- EROSION CONTROL NOTES:
- EXCAVATED MATERIALS SHALL BE PILED UPHILL FROM PIPE TRENCHES - NOT ON THE STREAM OR DITCH SIDE OF THE TRENCH.
 - ALL DISTURBED AREAS SHALL BE TAMPED, SEEDED AND MULCHED AS SOON AS POSSIBLE AFTER THE LINE IS INSTALLED AND/OR GRADING IS FINISHED.
 - EXCAVATED MATERIAL WHICH GETS ONTO ROADWAY PAVEMENTS SHALL BE CLEANED UP AT THE END OF EACH WORKING DAY.

APPROVED
 DATE: 5-4-89
 BY: *Sullivan*
 TOWN OF CARY
 ENGINEERING DEPARTMENT

NOTE: NOT FOR CONSTRUCTION
 IT IS THE CONTRACTOR'S RESPONSIBILITY TO VERIFY THE LOCATIONS OF ALL EXISTING UTILITIES.
 NOTE: ALL WORK IS TO BE IN CONFORMANCE WITH TOWN OF CARY STANDARDS AND SPECIFICATIONS.

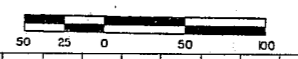

SCALE
 HORIZ. 1" = 50'
 VERT. 1" = 5'

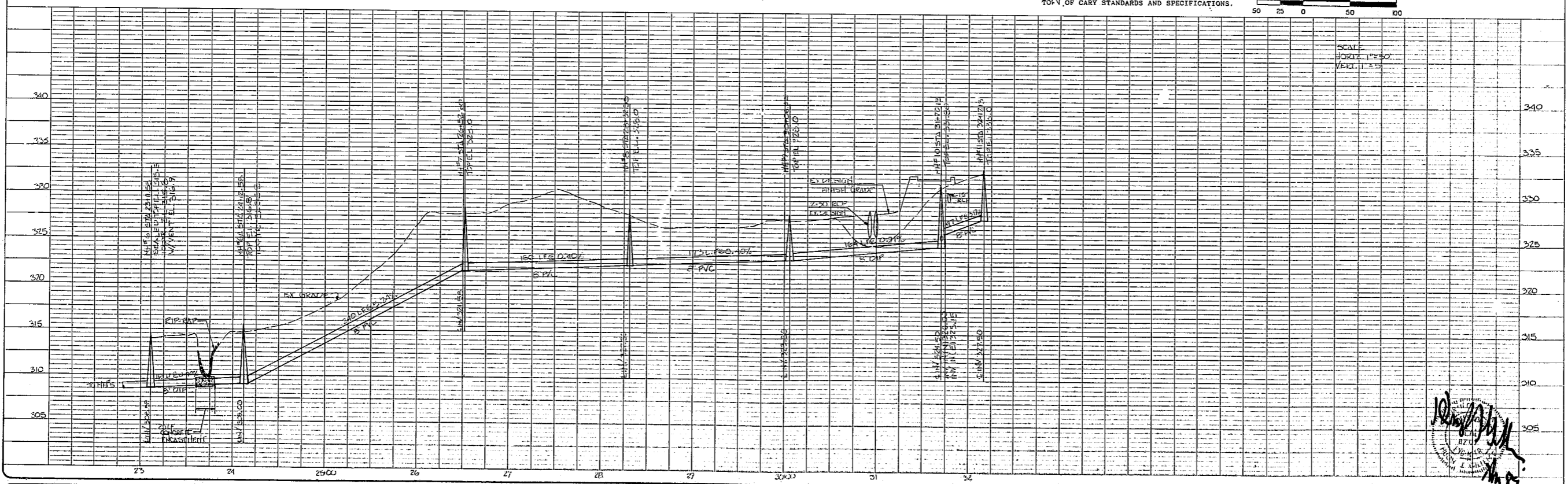

Handwritten signature and date: Sullivan 5/4/89

WESTPARK OUTFALL A (CONT.)

HUGH J. GILLEECE & ASSOC.
 104 FOUNTAINBROOK CIRCLE SUITE C CARY N.C. 27511 (919) 400-1101

DESIGNER	DATE	SHEET 3
DRAWN BY	SCALE	
CHECKED BY	DATE	
	DATE	