

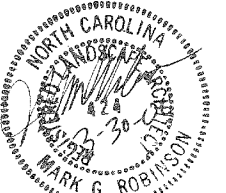

Mark Robinson & Associates

LANDSCAPE ARCHITECTURE & PLANNING
Phone: 251.536.9550 Fax: 251.536.9552 PO Box 126 / 662 Prospect Street
Email: markr@markr.com East Jordan, Michigan 49727



SEAL SEAL

CONSULTANT

NOTES:

- The information contained in the signed and sealed documents should be deemed to be correct and superior to electronic information.
*Electronic information is a component of the instruments of service and is only for the client's benefit on the specific project and for a specific use.
*There is no representation of the suitability of the electronic information for other purposes, of the durability of the information of the medium through which the information is furnished.
*Any use for a purpose other than that for which the information is intended shall be at the receiver's risk, and therefore the receiver shall protect and indemnify the sender from any claims, costs, losses or damages.
*Transfer of the information does not transfer any license to use the underlying software or extinguish the rights of the sender to reuse the information in the general course of a professional practice.
- Topographic and property boundary information within approximately 25 ft. of trail centerline is from field survey prepared by:
BBM Associates
527 Keisler Dr., Suite 164
Cary, NC 27511
Field survey shows 1 ft. contours.
- Topographic data beyond the trail corridor is from Town of Cary GIS adjusted to match field survey.

NOTES

DATE	REVISIONS	DATE	DESCRIPTION
04/28/05		02/01/05	2nd Review
			1st Review

SCALE 1" = 30'

White Oak Creek Greenway - Phase 4

Town of Cary
Cary, North Carolina

Project No. 05-SP-005
PROJECT/OWNER

Bond Park Section -
Existing Conditions / Demolition
SHEET TITLE

DATE December 21, 2004

SHEET NUMBER

L-BP-2

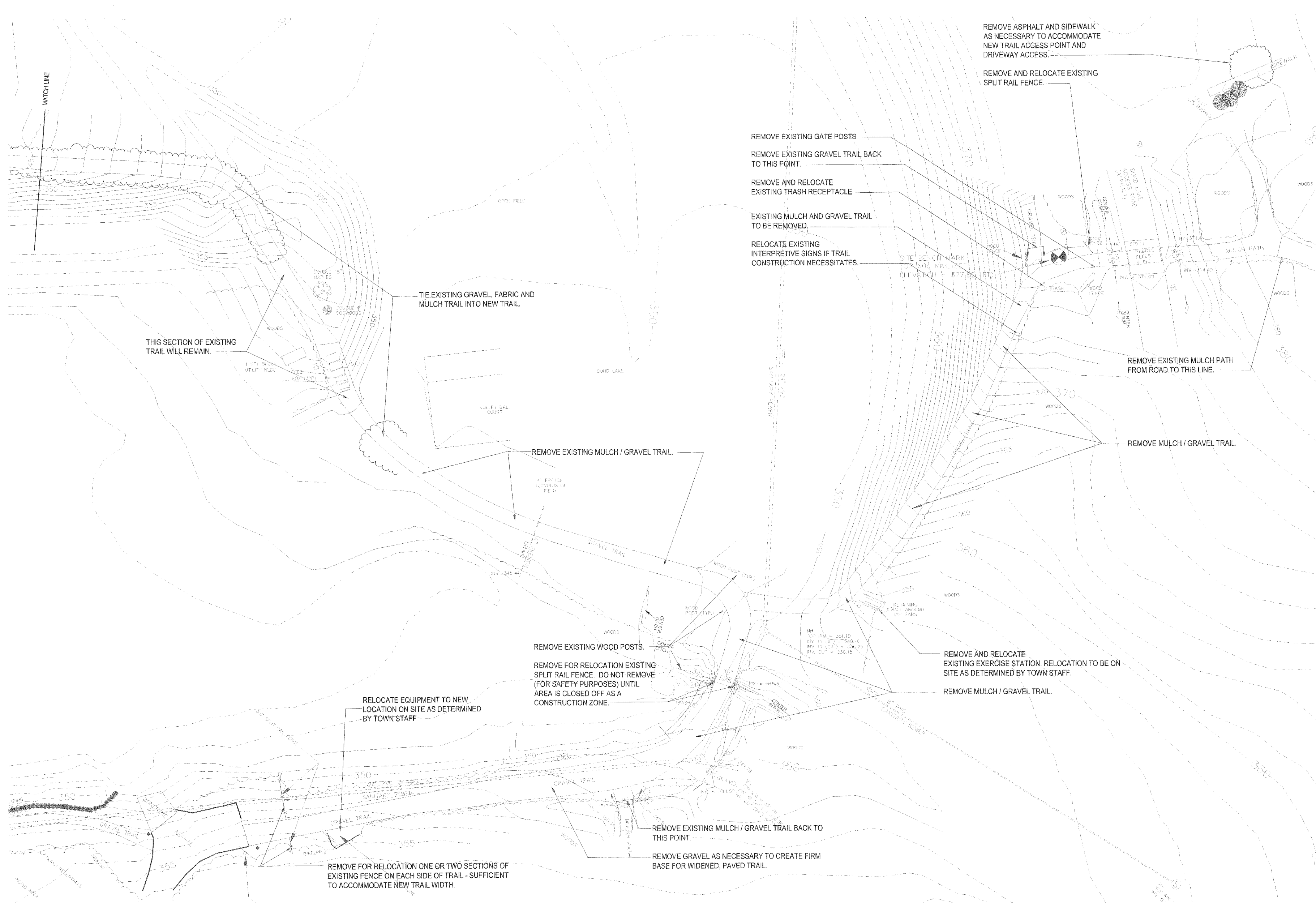

APPROVED
TOWN OF CARY

Approved By: DRC Date: _____
 Planning: DR Date: 4-10-04
 Engineering: TS Date: 4-11-04

