

SEAL SEAL

CONSULTANT

NOTES:

- *The information contained in the signed and sealed documents should be deemed to be correct and superior to electronic information.
 *Electronic information is a component of the instruments of service and is only for the client's benefit on the specific project and for a specific use.
 *There is no representation of the suitability of the electronic information for other purposes, of the durability of the information of the medium through which the information is furnished.
 *Any use for a purpose other than that for which the information is intended shall be at the receiver's risk, and therefore the receiver shall protect and indemnify the sender from any claims, costs, losses or damages.
 *Transfer of the information does not transfer any license to use the underlying software or extinguish the rights of the sender to reuse the information in the general course of a professional practice.
- Topographic and property boundary information within approximately 25 ft. of trail centerline is from field survey prepared by:
 BBM Associates
 527 Keisler Dr., Suite 164
 Cary, NC 27511
 Field survey shows 1 ft. contours.
- Topographic data beyond the trail corridor is from Town of Cary GIS adjusted to match field survey.
- Proposed NC 55 road improvements and underground utilities in NC 55 ROW provided by Barbara H. Mulkey Engineering Inc. for information only. Contractor shall field locate all utilities and verify road improvement plans prior to starting work in this area.

NOTES

04/28/05	2nd Review
02/01/05	1st Review
DATE	DESCRIPTION
REVISIONS	

SCALE 1"=30'

White Oak Creek Greenway-Phase 4
 Town of Cary
 North Carolina

Project # 05-SP-005
 PROJECT/OWNER

Park Scene Section
 Planting Plan
 SHEET TITLE

DATE December 21, 2004

SHEET NUMBER

L-PS-8

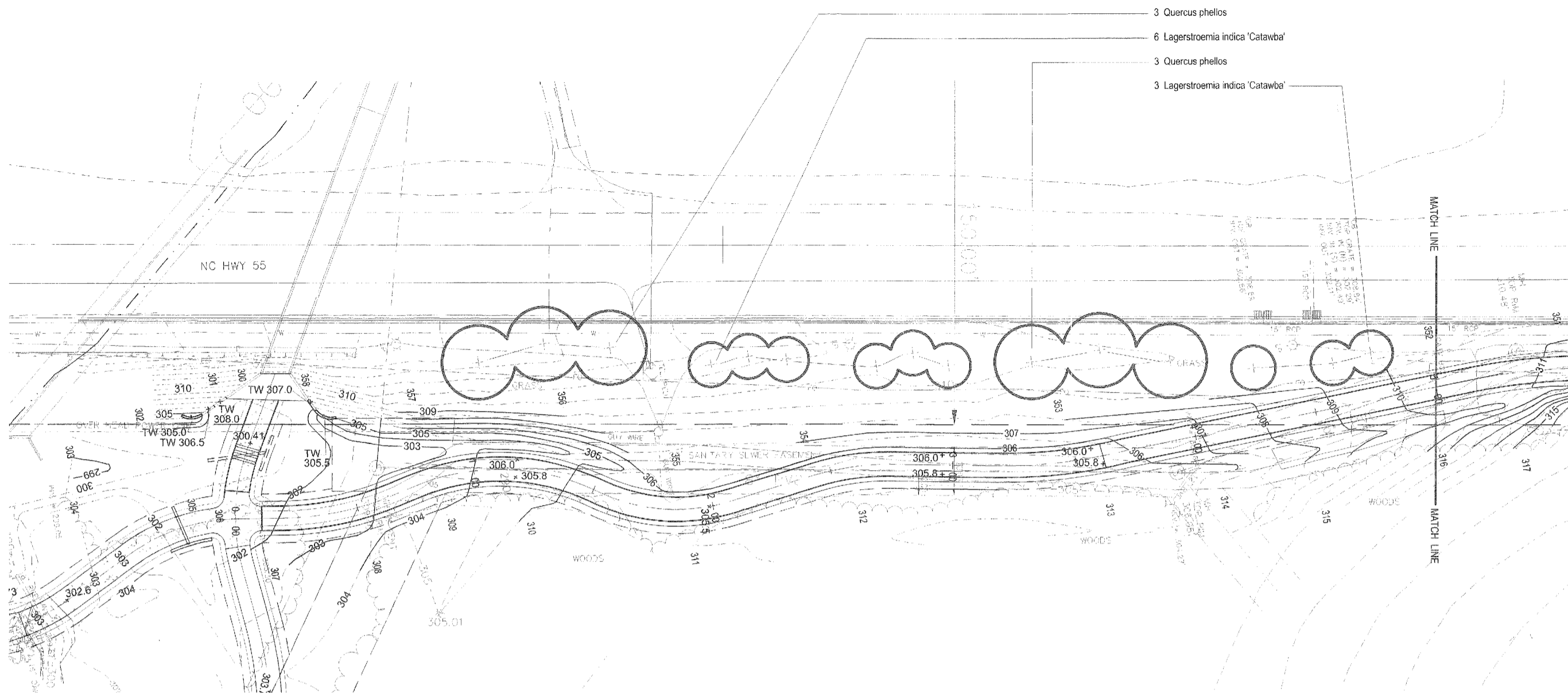

TRAIL SLOPES

CROSS SLOPE: 2%
 LONGITUDINAL SLOPE: 5% MAX. EXCEPT WHERE OTHERWISE NOTED ON THE GRADING PLAN.

SIDE SLOPES: 3:1 MAX. SLOPE EXCEPT WHERE OTHERWISE NOTED, 2% MIN.

GRADE SIDE SLOPES AND ADJACENT GROUND TO DRAIN.

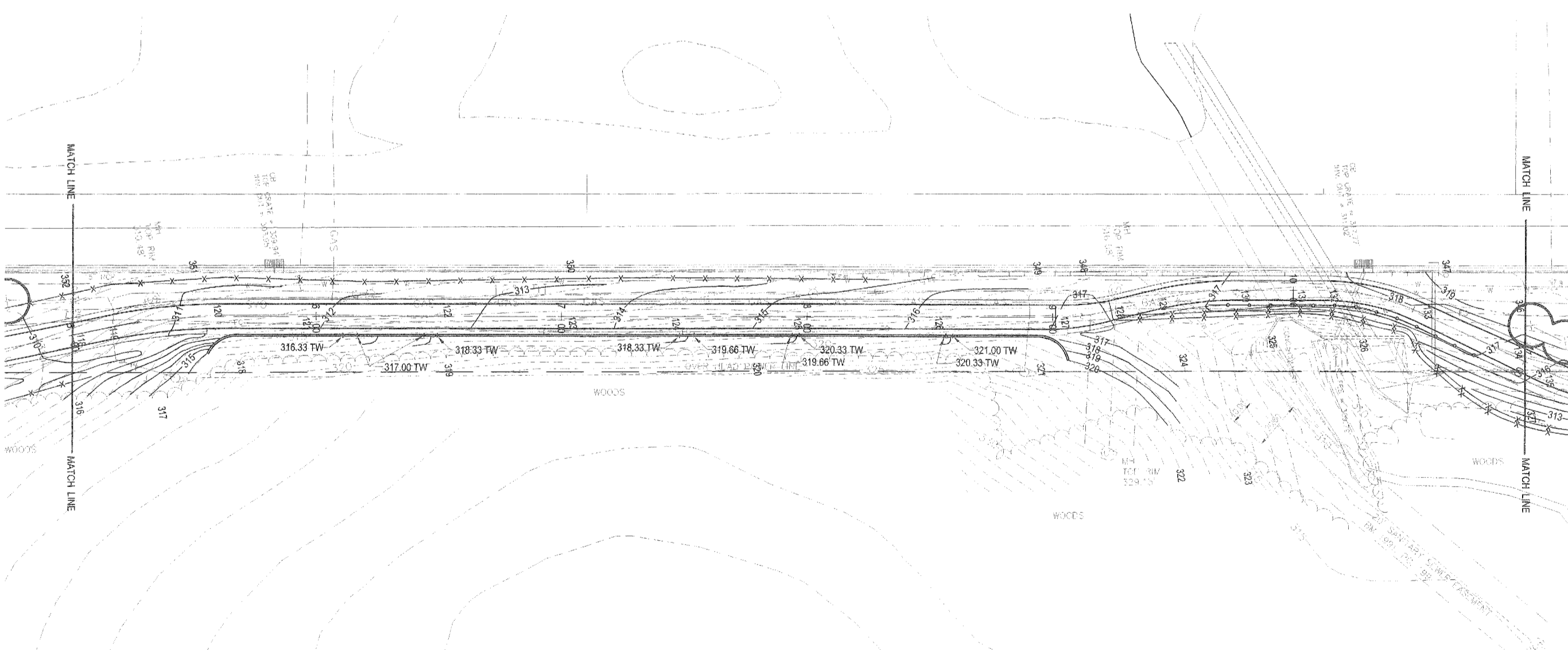

LEGEND:

- THICKENED ASPHALT PAVEMENT SECTION
- NORMAL ASPHALT PAVEMENT SECTION
- NORMAL 2 FT. SHOULDER
- MODIFIED ASPHALT PAVEMENT SECTION
- SOFT SURFACE TRAIL
- STAMPED AND COLORED ASPHALT
- CONCRETE PAVEMENT
- SHEET AND DETAIL NUMBER DESIGNATION

APPROVED
 TOWN OF CARY

Approved By: [Signature] Date: _____
 Planning Director: [Signature] Date: 8-6-06
 Engineering: [Signature] Date: 4-11-06

