

STANDARD SITE ABBREVIATIONS

ABC	AGGREGATE BASE COURSE	MAX	MAXIMUM
AC	ACRES	MED	MEDIAN
ANSI	AMERICAN NATIONAL STANDARDS INSTITUTE	MH	MANHOLE
APPROX	APPROXIMATE	MIN	MINIMUM
ASPH	ASPHALT	MJ	MECHANICAL JOINT
ASTM	AMERICAN SOCIETY FOR TESTING MATERIALS	MON	MONUMENT
AWWA	AMERICAN WATER WORKS ASSOCIATION	MTL	METAL
		MW	MONITOR WELL
B-B	BACK OF CURB TO BACK OF CURB	N/A	NOT APPLICABLE
BL	BOLLARD LIGHT	NAD 27	NORTH AMERICAN DATUM: 1927
BLDG	BUILDING	NAD 83	NORTH AMERICAN DATUM 1983
BM	BENCHMARK	NBL	NORTH BOUND LANE
BOC	BACK OF CURB	NC	NORMAL CROWN
BOL	BOLLARD	NC GRID	NORTH CAROLINA GRID
BVC	BEGIN VERTICAL CURVE	NCDDOT	NORTH CAROLINA DEPARTMENT OF TRANSPORTATION
BW	BARB WIRE	NCGS	NORTH CAROLINA GEODETIC SURVEY
C&G	CURB AND GUTTER	NEMA	NATIONAL ELECTRICAL MANUFACTURERS ASSOCIATION
CATV	CABLE TELEVISION	NIC	NOT IN CONTRACT
CB	CATCH BASIN	NIP	NEW IRON PIPE
CBL	CABLE	NTS	NOT TO SCALE
CFS	CUBIC FEET PER SECOND	O/C	ON CENTER
CHL	CHAIN LINK	OD	OUTSIDE DIAMETER
CI	CURB INLET	OH	OVERHEAD
CI	CAST IRON PIPE	OSHA	OCCUPATIONAL SAFETY AND HEALTH ADMINISTRATION
CL	CENTERLINE	OVH	OVERHANG
CM	CONCRETE MONUMENT	P/A	PARKING AREA
CMP	CORRUGATED METAL PIPE	PC	POINT OF CURVATURE
CO	CLEAN OUT	PCC	POINT OF COMPOUND CURVATURE
COM	COMMUNICATION	PED	PEDESTAL
CONC	CONCRETE	PI	POINT OF INTERSECTION
CONSTR	CONSTRUCTION	PINC	POINT OF INTERSECTION NO CURVE
CONTR	CONTRACTOR	PIV	POST INDICATOR VALVE
COR	CORNER	PL	PROPERTY LINE
CP&L	CAROLINA POWER & LIGHT	POC	POINT ON CURVE
CULV	CULVERT	POS	POINT ON SPIRAL
CW	CHILLED WATER	POT	POINT ON TANGENT
		PP	POWER POLE
Δ	DELTA	PRC	POINT OF REVERSE CURVATURE
DCV	DETECTOR CHECK VALVE	PSI	POUNDS PER SQUARE INCH
DDCV	DOUBLE DETECTOR CHECK VALVE	PT	POINT OF TANGENCY
DI	DROP INLET	PVC	POLYVINYL CHLORIDE
DIA	DIAMETER	PVM	POINT OF VERTICAL INTERSECTION
DIP	DUCTILE IRON PIPE	PVMT	PAVEMENT
DRW	DRIVEWAY	R	RADIUS
DW	DOMESTIC WATER	R/R	RAILROAD
EBL	EAST BOUND LANE	R/W	RIGHT OF WAY
EG	EXISTING GRADE	RCP	REINFORCED CONCRETE PIPE
EIP	EXISTING IRON PIPE	RETW	RETAINING WALL
ELEC	ELECTRIC	REV	REVERSED
ELEV	ELEVATION	RPZ	REDUCED PRESSURE ZONE
EM	ELECTRIC METER	RT	RIGHT
EOP	EDGE OF PAVEMENT	RWM	RIGHT OF MONUMENT
ESMT	EASEMENT		
EVC	END VERTICAL CURVE	SAN	SANITARY
EX	EXISTING	SB	SOIL BORING
FES	FLARED END SECTION	SBL	SOUTH BOUND LANE
FFE	FINISHED FLOOR ELEVATION	SHT	SHEET
FG	FINISHED GRADE	SIA	SIAMSE CONNECTION
FH	FIRE HYDRANT	SIG	SIGNAL
FL	FLOOD LIGHT	SL	SETBACK LINE
FNC	FENCE	SP	SIGNAL POLE
FOC	FACE OF CURB	SPECS	SPECIFICATIONS
FPS	FEET PER SECOND	STA	STATION
		STM	STORM
GALV	GALVANIZED	SW	SIDEWALK
GC	GENERAL CONTRACTOR	T	TANGENT
GL	GAS LINE	TBM	TEMPORARY BENCHMARK
GM	GAS METER	TEL	TERRA COTTA PIPE
GPM	GALLONS PER MINUTE	TELP	TELEPHONE
GRV	GRAVEL	TOC	TOP OF CURB
GTV	GATE VALVE	TOE	TOE OF SLOPE
GV	GAS VALVE	TOP	TOP OF SLOPE
GW	GUY WIRE	TOW	TOP OF WALL
		TP	TELEPHONE POLE
HC	HANDICAP	TRANS	TRANSFORMER
HCP	HANDICAP PARKING	TYP	TYPICAL
HCR	HANDICAP RAMP	U/C	UNDER CONSTRUCTION
HDW	HEADWALL	U/G	UNDERGROUND
HP	HIGH POINT	UP	UTILITY POLE
HT	HEIGHT	VC	VERTICAL CURVE
		VCP	VITRIFIED CLAY PIPE
ID	INSIDE DIAMETER	W&L	WEST BOUND LANE
IN/HR	INCHES PER HOUR	WL	WATER LINE
INV	INVERT	WM	WATER METER
ISL	ISLAND	WV	WATER VALVE
ITL	INDEPENDENT TESTING LABORATORY	WW	WOVEN WIRE
JB	JUNCTION BOX		
L	LENGTH		
LF	LINEAR FEET		
LGT	LIGHT		
LP	LIGHT POLE		
LS	LANDSCAPED		
LT	LEFT		

DRAWING INDEX

CO.1	SITE STANDARD ABBREVIATIONS AND SYMBOLS	C5.1	SITE LANDSCAPE PLAN
CO.2	CONCEPTUAL SITE PLAN	C6.1	LANDSCAPE/PLANTING DETAILS
C1.1	SITE DEMOLITION AND EXISTING CONDITIONS PLAN	C7.1	CIVIL/SITE DETAILS
C2.1	SITE LAYOUT PLAN	C7.2	CIVIL/SITE DETAILS
C3.1	SITE GRADING PLAN AND DRAINAGE PLAN		
C3.2	SITE EROSION CONTROL PLAN		
C4.1	SITE LIGHTING PLAN		

SITE SYMBOLS

EXISTING	NEW	DESCRIPTION
		PROPERTY LINE
		RIGHT OF WAY
		CENTERLINE
		TOWN, VILLAGE, CITY LINE
		EASEMENT
		SETBACK
		LIMITS OF CONSTRUCTION
		CONTOURS
		SPOT ELEVATIONS
		BENCH MARK
		BUILDINGS
		PAVEMENT, SIDEWALKS
		CURB AND GUTTER
		TREE LINE
		POND, LAKE, RIVER, STREAM
		RETAINING WALL
		FENCE
		RAILROAD
		GUARD RAIL
		SWALE/DITCH
		SILT FENCE
		CHECK DAM, INLET PROTECTION
		BOLLARD
		MANHOLE, JUNCTION BOX
		FLARED END SECTION
		CLEAN OUT
		FIRE HYDRANT, BLOW-OFF
		VALVE
		ELECTRIC, GAS, WATER METER
		CABLE, TELEPHONE PEDESTAL
		TRANSFORMER
		LIGHT POLE, WALL LIGHT, BOLLARD LIGHT, FLOOD LIGHT
		UTILITY POLE W/GUY WIRE
		CONCRETE MONUMENT, R/W MONUMENT
		WELL
		SIGN
		TREES
		THRUST BLOCK, THRUST COLLAR, PLUG, REDUCER
		SOIL BORING, MONITOR WELL
		COLUMN LINE NUMBER
		KEY NOTE NUMBER
		STORM DRAINAGE STRUCTURE NUMBER
		SOIL BORING NUMBER
		SANITARY SEWER STRUCTURE NUMBER
		STORM DRAIN LINE
		SANITARY SEWER LINE
		FORCE MAIN
		WATER LINE
		DOMESTIC WATER
		FIRE PROTECTION LINE
		GAS LINE
		ELECTRIC (OVERHEAD)
		ELECTRIC (UNDERGROUND)
		TELEPHONE (OVERHEAD)
		TELEPHONE (UNDERGROUND)
		FUEL LINE
		UNDERGROUND CABLE
		EXISTING BUILDING/STRUCTURE TO BE DEMOLISHED/RAZED
		AREA OF SITE TO BE DISTURBED/MODIFIED/REMOVED
		EXISTING TREES TO BE REMOVED

GENERAL NOTES

- THE CONTRACTOR SHALL BE RESPONSIBLE FOR FIELD VERIFYING ALL ILLUSTRATED KNOWN UNDERGROUND ELEMENTS. ADDITIONALLY, THE CONTRACTOR SHALL BE RESPONSIBLE FOR EXERCISING REASONABLE EFFORTS TO PROTECT ANY UNKNOWN UNDERGROUND ELEMENTS. THE CONTRACTOR SHALL NOTIFY THE ARCHITECT IMMEDIATELY IF UNKNOWN ELEMENTS ARE DISCOVERED THAT WOULD NECESSITATE MODIFICATION TO THE ILLUSTRATED DESIGN.
- PROTECT ALL ADJACENT PROPERTIES, THE GENERAL PUBLIC, AND ALL OF THE OWNER'S FACILITIES. SHOULD DAMAGES OCCUR, CONTRACTOR SHALL REPAIR IMMEDIATELY AS DIRECTED BY THE ARCHITECT.
- CONTRACTOR SHALL HOLD HARMLESS THE OWNER AND THE ARCHITECT FOR DAMAGES, INJURIES OR OTHER ACCIDENTS WHICH OCCUR DURING THESE CONSTRUCTION ACTIVITIES.
- TREES AND EXISTING LANDSCAPING NOT DESIGNATED FOR REMOVAL SHALL BE PROTECTED DURING CONSTRUCTION.
- ALL ELEVATIONS ARE IN REFERENCE TO DESIGNATED BENCHMARKS.
- CONTRACTOR SHALL BE RESPONSIBLE FOR SCHEDULING AND COORDINATION OF ALL ILLUSTRATED CONSTRUCTION ACTIVITIES AT THE JOB SITE.
- ALL WORK TO BE PERFORMED IN ACCORDANCE WITH OSHA SAFETY REGULATIONS.
- CONTRACTOR IS RESPONSIBLE FOR ALL DAMAGES DURING CONSTRUCTION AND SHALL MAKE REPAIRS AT HIS EXPENSE.
- CONTRACTOR SHALL BE RESPONSIBLE FOR LOCATION ADJUSTMENTS OF ALL EXISTING VAULTS (REGARDLESS OF FUNCTION), METER BOXES, FIRE HYDRANTS, CLEAN OUTS, MANHOLES ETC. TO MATCH FINISHED GRADES AND SITE PLAN. ALL SUCH WORK SHALL BE COORDINATED WITH THE ARCHITECT.
- UTILIZE SIGNS, BARRICADES, FLAGMEN, OR GUARDS AS REQUIRED TO ENSURE THE SAFETY OF ALL VEHICULAR AND PEDESTRIAN TRAFFIC DURING ALL CONSTRUCTION ACTIVITIES.
- THE CONTRACTOR SHALL COORDINATE WITH THE OWNER AND ADJACENT PROPERTY OWNERS AS REQUIRED FOR WORK OUTSIDE OF PROPERTY LINES.
- UNDER ABSOLUTELY NO CIRCUMSTANCES SHALL ANY UNMANNED EXCAVATION BE LEFT OPEN OR UNPROTECTED DURING NON-WORKING HOURS. UTILIZE SIGNS, BARRICADES, ETC. TO ENSURE THE SAFETY OF THE GENERAL PUBLIC.
- THE CONTRACTOR SHALL BE RESPONSIBLE FOR LAYOUT OF ALL WORK AS ILLUSTRATED ON PLANS. IF EXISTING CONDITIONS DIFFER FROM THOSE ILLUSTRATED ON PLANS, NOTIFY ARCHITECT PRIOR TO CONSTRUCTION.
- EXISTING SITE SURVEY INFORMATION WAS TAKEN FROM A TOPOGRAPHIC SURVEY PREPARED BY BONEY AND ASSOCIATES, DATED MARCH 1986 AND FROM PLANS BY DSAtlantic CORPORATION.
- VERIFY ALL DIMENSIONS AND GRADES AT THE JOB SITE. IF DIFFERENCES ARE FOUND, NOTIFY ARCHITECT SO THAT MODIFICATIONS TO THESE DRAWINGS CAN BE MADE.
- ALL CONSTRUCTION SHALL BE PERFORMED IN ACCORDANCE WITH THE CURRENT TOWN OF CARY STANDARD SPECIFICATIONS AND DETAILS.
- NO GEOTECHNICAL SUBSURFACE REPORT WAS PROVIDED FOR THE DESIGN OF THIS PROJECT.

GENERAL CIVIL/SITE JOB DESCRIPTION

THIS JOB CONSISTS OF DEMOLITION, CLEARING AND GRUBBING, STRIPPING, SITE GRADING, EROSION CONTROL MEASURES, STORM DRAIN INSTALLATION, WATER LINE INSTALLATION, SEEDING AND OTHER OTHER WORKS DESIGNATED. CONSTRUCTION STAKE OUT FOR THE JOB IS THE RESPONSIBILITY OF THE OWNER.

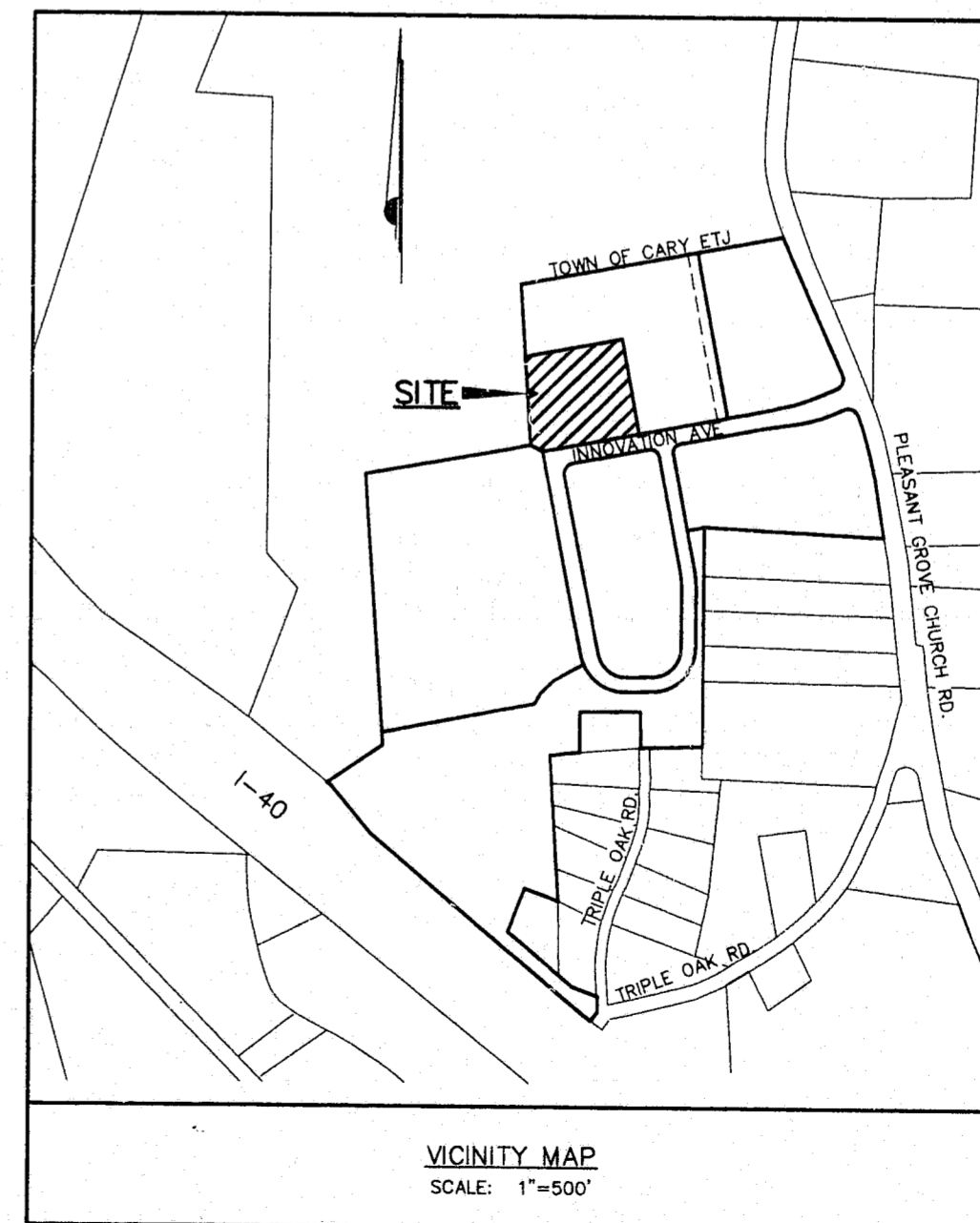

DSAtlantic
 CHARLOTTE, NC ♦ POPE AVENUE, #1 ♦ RALEIGH, NC
 RICHMOND, VA ♦ WINSTON-SALEM, NC
 801 JONES FRANKLIN ROAD, SUITE 300
 RALEIGH, NC 27608

© DSAtlantic Corporation, 1994 (all rights reserved)
 No part of this document may be reproduced, stored in a retrieval system, or transmitted in any form or by any means, electronic, mechanical, photocopying, recording, or by any information storage and retrieval system, without the prior written permission of DSAtlantic Corporation. This document is the property of DSAtlantic Corporation and may be used only in connection with the project of DSAtlantic Corporation for which it was prepared. Any unauthorized use of this document for any other purpose is prohibited. The user shall be liable for any damages, including reasonable attorney's fees, caused by the use of this document, and shall indemnify and hold DSAtlantic Corporation harmless from and against all claims, damages, and expenses, including reasonable attorney's fees, caused by the use of this document.



PARKING LOT
 NORTHERN TELECOM INC.
 LOT 4 WOODLAKE CENTER
 LICHTIN PROPERTIES, INC.
 CARY, NORTH CAROLINA

SITE STANDARD ABBREVIATIONS AND SYMBOLS

ISSUE SEQUENCE		
NO.	DATE	DESCRIPTION
1	7/24/98	ISSUE FOR CONSTRUCTION

PROJECT NO.: LIC002.000
 DESIGNED BY: LVL
 DRAWN BY: TLD
 DATE: 4/26/98

C0.1
 OF 11
 CADD #: 115C0-01 (1)