

STANDARD SITE ABBREVIATIONS

ABC	AGGREGATE BASE COURSE	MAX	MAXIMUM
AC	ACRES	MED	MEDIAN
ANSI	AMERICAN NATIONAL STANDARDS INSTITUTE	MH	MANHOLE
APPROX	APPROXIMATE	MIN	MINIMUM
ASPH	ASPHALT	MJ	MECHANICAL JOINT
ASTM	AMERICAN SOCIETY FOR TESTING MATERIALS	MN	MONUMENT
AWWA	AMERICAN WATER WORKS ASSOCIATION	MTL	METAL
		MW	MONITOR WELL
B-B	BACK OF CURB TO BACK OF CURB	N/A	NOT APPLICABLE
BL	BOLLARD LIGHT	NAD 27	NORTH AMERICAN DATUM 1927
BLDG	BUILDING	NAD 83	NORTH AMERICAN DATUM 1983
BM	BENCHMARK	NBL	NORTH BOUND LANE
BOC	BACK OF CURB	NC	NORMAL CROWN
BOL	BOLLARD	NC GRID	NORTH CAROLINA GRID
BVC	BEGIN VERTICAL CURVE	NC DOT	NORTH CAROLINA DEPARTMENT OF TRANSPORTATION
BW	BARB WIRE	NC GS	NORTH CAROLINA GEODETIC SURVEY
C&G	CURB AND GUTTER	NEMA	NATIONAL ELECTRICAL MANUFACTURERS ASSOCIATION
CATV	CABLE TELEVISION	NIC	NOT IN CONTRACT
CB	CATCH BASIN	NIP	NEW IRON PIPE
CBL	CABLE	NTS	NOT TO SCALE
CFS	CUBIC FEET PER SECOND	O/C	ON CENTER
CHL	CHAIN LINK	OD	OUTSIDE DIAMETER
CI	CURB INLET	OH	OVERHEAD
CIP	CAST IRON PIPE	OSHA	OCCUPATIONAL SAFETY AND HEALTH ADMINISTRATION
CL	CENTERLINE	OVH	OVERHANG
CM	CONCRETE MONUMENT	P/A	PARKING AREA
CMP	CORRUGATED METAL PIPE	PC	POINT OF CURVATURE
CO	CLEAN OUT	PCC	POINT OF COMPOUND CURVATURE
COM	COMMUNICATION	PE	PEDESTAL
CONC	CONCRETE	PI	POINT OF INTERSECTION
CONSTR	CONSTRUCTION	PIV	POINT OF INTERSECTION NO CURVE
CONTR	CONTRACTOR	PIN	POST INDICATOR VALVE
COR	CORNER	PL	PROPERTY LINE
CP&L	CAROLINA POWER & LIGHT	POC	POINT ON CURVE
CULV	CULVERT	POS	POINT ON SPIRAL
CW	CHILLED WATER	POT	POINT ON TANGENT
		PP	POWER POLE
Δ	DELTA	PRC	POINT OF REVERSE CURVATURE
DCV	DETECTOR CHECK VALVE	PSI	POUNDS PER SQUARE INCH
DDCV	DOUBLE DETECTOR CHECK VALVE	PT	POINT OF TANGENCY
DI	DROP INLET	PVC	POLYVINYL CHLORIDE
DIA	DIAMETER	PVI	POINT OF VERTICAL INTERSECTION
DIP	DUCTILE IRON PIPE	PVMT	PAVEMENT
DRW	DRIVEWAY	R	RADIUS
DW	DOMESTIC WATER	R/W	RIGHT OF WAY
		RCP	REINFORCED CONCRETE PIPE
EBL	EAST BOUND LANE	RETW	RETAINING WALL
EG	EXISTING GRADE	REV	REVISED
EIP	EXISTING IRON PIPE	RPZ	REDUCED PRESSURE ZONE
ELEC	ELECTRIC	RT	RIGHT
ELEV	ELEVATION	RWM	RIGHT OF MONUMENT
EM	ELECTRIC METER		
EOP	EDGE OF PAVEMENT	SAN	SANITARY
ESMT	EASEMENT	SB	SOIL BORING
EVC	END VERTICAL CURVE	SBL	SOUTH BOUND LANE
EX	EXISTING	SHT	SHEET
		SIA	SIAMESE CONNECTION
FES	FLARED END SECTION	SIG	SIGNAL
FFE	FINISHED FLOOR ELEVATION	S	SETBACK LINE
FG	FINISHED GRADE	SP	SIGNAL POLE
FH	FIRE HYDRANT	SPECS	SPECIFICATIONS
FL	FLOOD LIGHT	STA	STATION
FNC	FENCE	STM	STORM
FCC	FACE OF CURB	SW	SIDEWALK
FPS	FEET PER SECOND		
		T	TANGENT
GALV	GALVANIZED	TBM	TEMPORARY BENCHMARK
GC	GENERAL CONTRACTOR	TCP	TERRA COTTA PIPE
GL	GAS LINE	TEL	TELEPHONE
GM	GAS METER	TEMP	TEMPORARY
GPM	GALLONS PER MINUTE	TOC	TOP OF CURB
GRV	GRAVEL	TOE	TOE OF SLOPE
GTV	GATE VALVE	TOP	TOP OF SLOPE
GV	GAS VALVE	TOW	TOP OF WALL
GW	GUY WIRE	TP	TELEPHONE POLE
		TRANS	TRANSFORMER
HC	HANDICAP	TYP	TYPICAL
HCP	HANDICAP PARKING	U/C	UNDER CONSTRUCTION
HCR	HANDICAP RAMP	U/G	UNDERGROUND
HDW	HEADWALL	UP	UTILITY POLE
HP	HIGH POINT	VC	VERTICAL CURVE
HT	HEIGHT	VCP	VITREOUS CLAY PIPE
		WBL	WEST BOUND LANE
ID	INSIDE DIAMETER	WL	WATER LINE
IN/HR	INCHES PER HOUR	WM	WATER METER
INV	INVERT	WV	WATER VALVE
ISL	ISLAND	WW	WOVEN WIRE
ITL	INDEPENDENT TESTING LABORATORY		
JB	JUNCTION BOX		
L	LENGTH		
LF	LINEAR FEET		
LG	LIGHT		
LP	LIGHT POLE		
LS	LANDSCAPED		
LT	LEFT		

NOTE: ALL SYMBOLS AND ABBREVIATIONS MAY NOT BE APPLICABLE TO THIS PROJECT.

DRAWING INDEX

CO.1	SITE STANDARD ABBREVIATIONS AND SYMBOLS
C1.1	SITE DEMOLITION & EX CONDITIONS PLAN
C2.1	SITE LAYOUT PLAN
C3.1	SITE GRADING PLAN
C3.2	SITE EROSION CONTROL PLAN
C4.1	SITE UTILITY PLAN
C5.1	SITE LANDSCAPING PLAN
C6.1	STORM DRAINAGE PROFILES
C7.1	CIVIL/SITE DETAILS
C7.2	CIVIL/SITE DETAILS
C7.3	CIVIL/SITE DETAILS
C7.4	CIVIL/SITE DETAILS

SITE SYMBOLS

EXISTING	NEW	DESCRIPTION
		RIGHT OF WAY
		CENTERLINE
		TOWN, VILLAGE, CITY LINE
		EASEMENT
		SETBACK
		LIMITS OF CONSTRUCTION
		CONTOURS
		SPOT ELEVATIONS
		BENCH MARK
		BUILDINGS
		PAVEMENT, SIDEWALKS
		CURB AND GUTTER
		TREE LINE
		POND, LAKE, RIVER, STREAM
		RETAINING WALL
		FENCE
		RAILROAD
		GUARD RAIL
		SWALE/DITCH
		SILT FENCE
		CHECK DAM, INLET PROTECTION
		BOLLARD
		CATCH BASIN, CURB INLET, DROP INLET
		MANHOLE, JUNCTION BOX
		FLARED END SECTION
		CLEAN OUT
		FIRE HYDRANT, BLOW-OFF
		VALVE
		ELECTRIC, GAS, WATER METER
		CABLE, TELEPHONE PEDESTAL
		TRANSFORMER
		LIGHT POLE, WALL LIGHT, BOLLARD LIGHT, FLOOD LIGHT
		UTILITY POLE W/GUY WIRE
		CONCRETE MONUMENT, R/W MONUMENT
		WELL
		SIGN
		TREES
		THRUST BLOCK, THRUST COLLAR, PLUG, REDUCER
		SOIL BORING, MONITOR WELL
		COLUMN LINE NUMBER
		KEY NOTE NUMBER
		STORM DRAINAGE STRUCTURE NUMBER
		SOIL BORING NUMBER
		SANITARY SEWER STRUCTURE NUMBER
		STORM DRAIN LINE
		SANITARY SEWER LINE
		FORCE MAIN
		WATER LINE
		DOMESTIC WATER
		FIRE PROTECTION LINE
		GAS LINE
		ELECTRIC (OVERHEAD)
		ELECTRIC (UNDERGROUND)
		TELEPHONE (OVERHEAD)
		TELEPHONE (UNDERGROUND)
		FUEL LINE
		UNDERGROUND CABLE
		EXISTING BUILDING/STRUCTURE TO BE DEMOLISHED/RAZED
		AREA OF SITE TO BE DISTURBED/MODIFIED/REMOVED
		EXISTING TREES TO BE REMOVED

GENERAL NOTES

- THE CONTRACTOR SHALL BE RESPONSIBLE FOR FIELD VERIFYING ALL ILLUSTRATED KNOWN UNDERGROUND ELEMENTS. ADDITIONALLY, THE CONTRACTOR SHALL BE RESPONSIBLE FOR EXERCISING REASONABLE EFFORTS TO PROTECT ANY UNKNOWN UNDERGROUND ELEMENTS. THE CONTRACTOR SHALL NOTIFY THE ENGINEER IMMEDIATELY IF UNKNOWN ELEMENTS ARE DISCOVERED THAT WOULD NECESSITATE MODIFICATION TO THE ILLUSTRATED DESIGN.
- PROTECT ALL ADJACENT PROPERTIES, THE GENERAL PUBLIC, AND ALL OF THE OWNER'S FACILITIES. SHOULD DAMAGES OCCUR, CONTRACTOR SHALL REPAIR IMMEDIATELY AS DIRECTED BY THE ENGINEER.
- CONTRACTOR SHALL HOLD HARMLESS THE OWNER AND THE ENGINEER FOR DAMAGES, INJURIES OR OTHER ACCIDENTS WHICH OCCUR DURING THESE CONSTRUCTION ACTIVITIES.
- TREES AND EXISTING LANDSCAPING NOT DESIGNATED FOR REMOVAL SHALL BE PROTECTED DURING CONSTRUCTION.
- ALL ELEVATIONS ARE IN REFERENCE TO DESIGNATED BENCHMARKS.
- CONTRACTOR SHALL BE RESPONSIBLE FOR SCHEDULING AND COORDINATION OF ALL ILLUSTRATED CONSTRUCTION ACTIVITIES AT THE JOB SITE.
- CONTR SHALL PROVIDE EXCAVATION AND TRAVELING OPERATIONS AS REQUIRED BY LOCAL AUTHORITIES AND ALL APPLICABLE OSHA REGULATIONS.
- CONTRACTOR IS RESPONSIBLE FOR ALL DAMAGES DURING CONSTRUCTION AND SHALL MAKE REPAIRS AT HIS EXPENSE.
- CONTRACTOR SHALL BE RESPONSIBLE FOR LOCATION ADJUSTMENTS OF ALL EXISTING VAULTS (REGARDLESS OF FUNCTION), METER BOXES, FIRE HYDRANTS, CLEAN OUTS, MANHOLES ETC. TO MATCH FINISHED GRADES AND SITE PLAN. ALL SUCH WORK SHALL BE COORDINATED WITH THE ENGINEER.
- UTILIZE SIGNS, BARRICADES, FLAGMEN, OR GUARDS AS REQUIRED TO ENSURE THE SAFETY OF ALL VEHICULAR AND PEDESTRIAN TRAFFIC DURING ALL CONSTRUCTION ACTIVITIES.
- THE CONTRACTOR SHALL COORDINATE WITH THE OWNER AND ADJACENT PROPERTY OWNERS AS REQUIRED FOR WORK OUTSIDE OF PROPERTY LINES.
- UNDER ABSOLUTELY NO CIRCUMSTANCES SHALL ANY UNMANNED EXCAVATION BE LEFT OPEN OR UNPROTECTED DURING NON-WORKING HOURS. UTILIZE SIGNS, BARRICADES, ETC. TO ENSURE THE SAFETY OF THE GENERAL PUBLIC.
- THE CONTRACTOR SHALL BE RESPONSIBLE FOR LAYOUT OF ALL WORK AS ILLUSTRATED ON PLANS. IF EXISTING CONDITIONS DIFFER FROM THOSE ILLUSTRATED ON PLANS, NOTIFY ENGINEER PRIOR TO CONSTRUCTION.
- ALL WORK SHALL CONFORM TO TOWN OF CARY STANDARDS AND SPECIFICATIONS.
- VERIFY ALL DIMENSIONS AND GRADES AT THE JOB SITE. IF DIFFERENCES ARE FOUND, NOTIFY ENGINEER SO THAT MODIFICATIONS TO THESE DRAWINGS CAN BE MADE.
- CONTR SHALL BE RESPONSIBLE FOR ALL LOCATION ADJUSTMENTS OF ALL EX VAULTS, METER BOXES, FIRE HYDRANTS, SEWER COs, ALL MHS, ETC. TO MATCH FINISHED GRADES AND SITE PLAN.
- EX SITE SURVEY INFORMATION WAS TAKEN FROM A TOPOGRAPHIC AND BOUNDARY SURVEY BY DSATLANTIC CORPORATION DATED 7/31/96.
- NO CHANGES TO ANY ASPECT OF THIS SITE PLAN, INCLUDING BUT NOT LIMITED TO LANDSCAPING, GRADING, BUILDING ELEVATIONS (ESPECIALLY COLORS), LIGHTING, OR UTILITIES WILL BE MADE WITHOUT THE APPROVAL OF THE DEVELOPMENT REVIEW GROUP OF THE DEPARTMENT OF DEVELOPMENT SERVICES.
- THE DEVELOPER WILL BE RESPONSIBLE FOR ALL INSTALLATION COSTS ASSOCIATED WITH STREET LIGHTING ALONG ALL PROPOSED STREETS, ADJACENT STREETS AND THOROUGHFARES AS REQUIRED PER TOWN OF CARY POLICY STATEMENT NO 13. THE DEVELOPER SHALL CONTACT CAROLINA POWER AND LIGHT COMPANY AFTER PLAN APPROVAL AND PRIOR TO CONSTRUCTION IN ORDER TO DEVELOP STREET LIGHTING PLAN FOR THE SITE/ SUBDIVISION PLANS.
- NO CHANGES TO ANY ASPECT OF THIS SITE PLAN, INCLUDING BUT NOT LIMITED TO, LANDSCAPING, GRADING, BUILDING ELEVATIONS (ESPECIALLY COLORS), LIGHTING, OR UTILITIES WILL BE MADE WITHOUT THE APPROVAL OF THE DEVELOPMENT REVIEW GROUP OF THE DEPARTMENT OF DEVELOPMENT SERVICES.
- THE SITE SHALL BE STABILIZED AND SEEDED PRIOR TO THE ISSUANCE OF A CERTIFICATE OF OCCUPANCY.
- THE NEW BUILDING SHALL MATCH APPEARANCE AND COLORS OF SURROUNDING BUILDINGS.

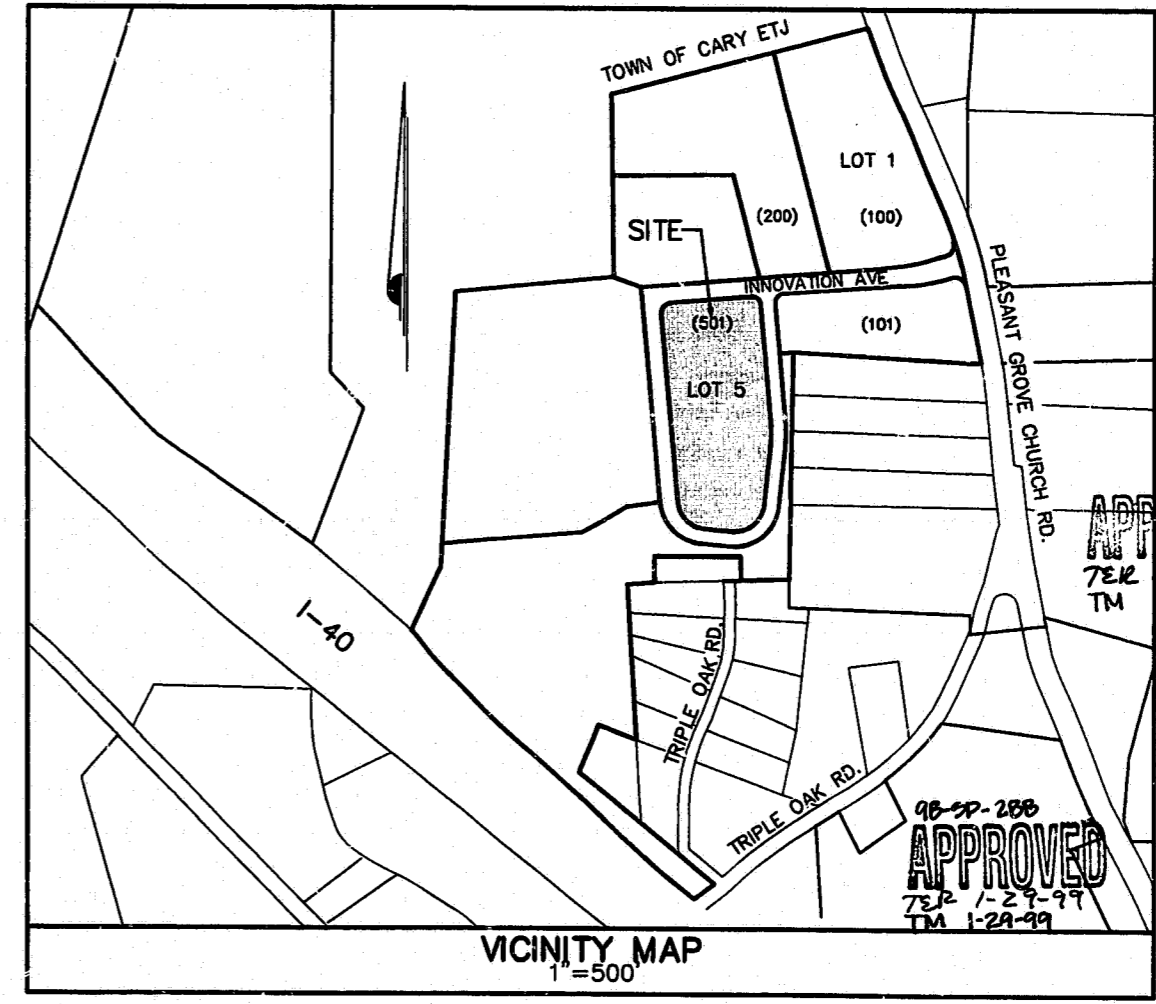

DESIGN INTENTIONS

THIS JOB CONSISTS OF CLEARING AND GRUBBING, STRIPPING, SITE GRADING, EROSION CONTROL MEASURES, STORM DRAIN INSTALLATION, PAVING, SEEDING, SANITARY SEWER & WATER LINE INSTALLATION AND OTHER WORK AS DESIGNATED FOR THE CONSTRUCTION OF NEW WAREHOUSE FACILITY. SPECIFICATIONS ARE PROVIDED FOR THE WATER AND SANITARY SEWER LINES ONLY. ALL CONSTRUCTION SHALL CONFORM TO THE TOWN OF CARY AND/OR N.C. D.O.T. STANDARDS AND SPECIFICATIONS AS APPLICABLE. ALL GRADING OPERATIONS, FOUNDATION PREPARATION, BACKFILLING, ETC. SHALL BE IN ACCORDANCE WITH THE RECOMMENDATIONS OF THE OWNER'S INDEPENDENT SOILS TESTING LABORATORY (ITL).

DSAtlantic
 801 JONES FRANKLIN ROAD • SUITE 300 • RALEIGH, NC 27608
 919-861-8888 • FAX 919-861-7024
 CELEBRATED, NC • COLUMBIA, SC • MACON, GA • NASHVILLE, TN
 RALEIGH, NC • RICHMOND, VA • WINSTON-SALEM, NC

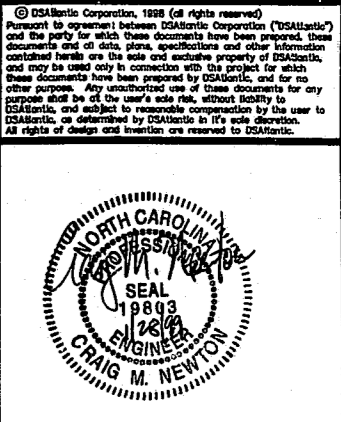

WOODLAKE CENTER
LOT 5
 WEEKS REALTY, LP
 1800 PERIMETER PARK DRIVE, SUITE 200
 MORRISVILLE, NORTH CAROLINA

SITE STANDARD ABBREVIATIONS AND SYMBOLS

ISSUE SEQUENCE	
NO.	DESCRIPTION
1/28/99	ISSUE FOR CONSTRUCTION

PROJECT NO.: LIC045.000
 DESIGNED BY: ARP
 DRAWN BY: ARP
 DATE: 1/28/99

C0.1
 OF 12 13
 CADD #: G.LIC-045-CIVL