

NOW OR FORMERLY  
NCHA GENERAL PARTNERS I  
ZONED: PEC  
USE: INDUSTRIAL

PLEASANT GROVE CHURCH ROAD SR 1789  
(VARIABLE R/W)

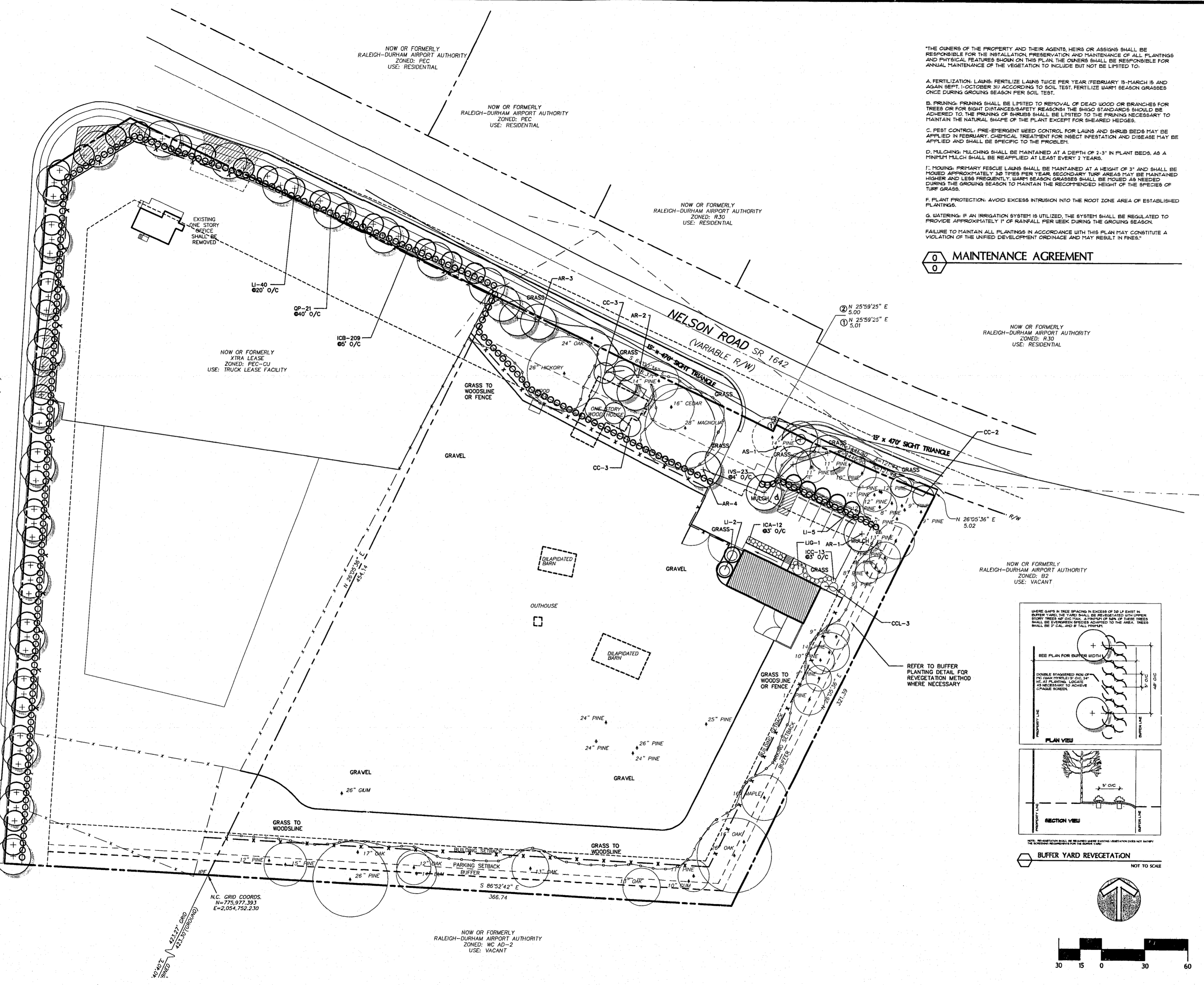

THE OWNERS OF THE PROPERTY AND THEIR AGENTS, HEIRS OR ASSIGNS SHALL BE RESPONSIBLE FOR THE INSTALLATION, PRESERVATION AND MAINTENANCE OF ALL PLANTINGS AND PHYSICAL FEATURES SHOWN ON THIS PLAN. THE OWNERS SHALL BE RESPONSIBLE FOR ANNUAL MAINTENANCE OF THE VEGETATION TO INCLUDE BUT NOT BE LIMITED TO:

A. FERTILIZATION: LAWN, FERTILIZE LAWN TWICE PER YEAR (FEBRUARY 15-MARCH 15 AND AGAIN SEPT. 1-OCTOBER 31) ACCORDING TO SOIL TEST. FERTILIZE WARM SEASON GRASSES ONCE DURING GROWING SEASON PER SOIL TEST.

B. PRUNING: PRUNING SHALL BE LIMITED TO REMOVAL OF DEAD WOOD OR BRANCHES FOR TREES OR FOR SIGHT DISTANCE/SAFETY REASONS. THE SAIGO STANDARDS SHOULD BE ADHERED TO. THE PRUNING OF SHRUBS SHALL BE LIMITED TO THE PRUNING NECESSARY TO MAINTAIN THE NATURAL SHAPE OF THE PLANT EXCEPT FOR SHEARED HEDGES.

C. PEST CONTROL: PRE-EMERGENT WEED CONTROL FOR LAWNS AND SHRUB BEDS MAY BE APPLIED IN FEBRUARY. CHEMICAL TREATMENT FOR INSECT INFESTATION AND DISEASE MAY BE APPLIED AND SHALL BE SPECIFIC TO THE PROBLEM.

D. MULCHING: MULCHING SHALL BE MAINTAINED AT A DEPTH OF 2-3" IN PLANT BEDS, AS A MINIMUM MULCH SHALL BE REAPPLIED AT LEAST EVERY 2 YEARS.

F. PLANT PROTECTION: AVOID EXCESS INTRUSION INTO THE ROOT ZONE AREA OF ESTABLISHED PLANTINGS.

G. WATERING: IF AN IRRIGATION SYSTEM IS UTILIZED, THE SYSTEM SHALL BE REGULATED TO PROVIDE APPROXIMATELY 1" OF RAINFALL PER WEEK DURING THE GROWING SEASON.

FAILURE TO MAINTAIN ALL PLANTINGS IN ACCORDANCE WITH THIS PLAN MAY CONSTITUTE A VIOLATION OF THE UNIFIED DEVELOPMENT ORDINANCE AND MAY RESULT IN FINES.

### MAINTENANCE AGREEMENT



**JERRY TURNER & ASSOCIATES, INC.**  
Landscape Architecture  
Land Planning  
Environmental Design

905 Jones Franklin Road  
Raleigh, North Carolina 27606  
(919) 851-7150 fax: (919) 851-7547  
  
277 S.E. 5th Avenue  
Delray Beach, Florida 33483  
(561) 276-0453 fax: (561) 272-7593

## XTRA LEASE FACILITY

**APPROVED**  
SG 10/6/00  
JLH 10/6/00

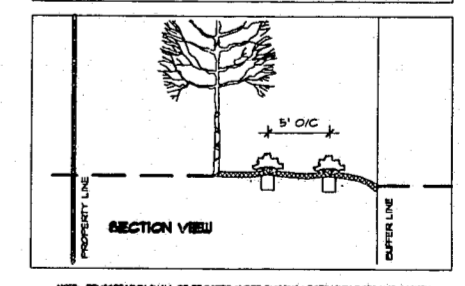
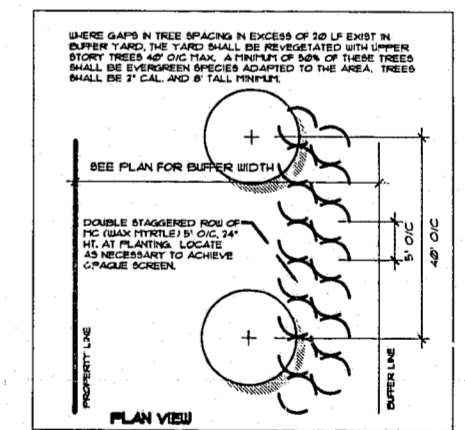

**BUFFER YARD REVEGETATION**  
NOT TO SCALE

REVISIONS  
6/2/2000 REVISED PER TOWN COMMENTS  
6/20/2000  
7/17/2000  
10/5/2000 FOR SIGNATURES

DRAWN \_\_\_\_\_ CHECKED \_\_\_\_\_  
CP JT  
SCALE \_\_\_\_\_ DATE \_\_\_\_\_  
1"=30' 5/1/2000  
TITLE \_\_\_\_\_

## LANDSCAPE PLAN

FILE NO. \_\_\_\_\_ JOB NO. \_\_\_\_\_  
FILE# 2710.00  
SCALE \_\_\_\_\_ SHEET NO. \_\_\_\_\_

